

TRANSMISSION -
STANDARD AND OVERDRIVE

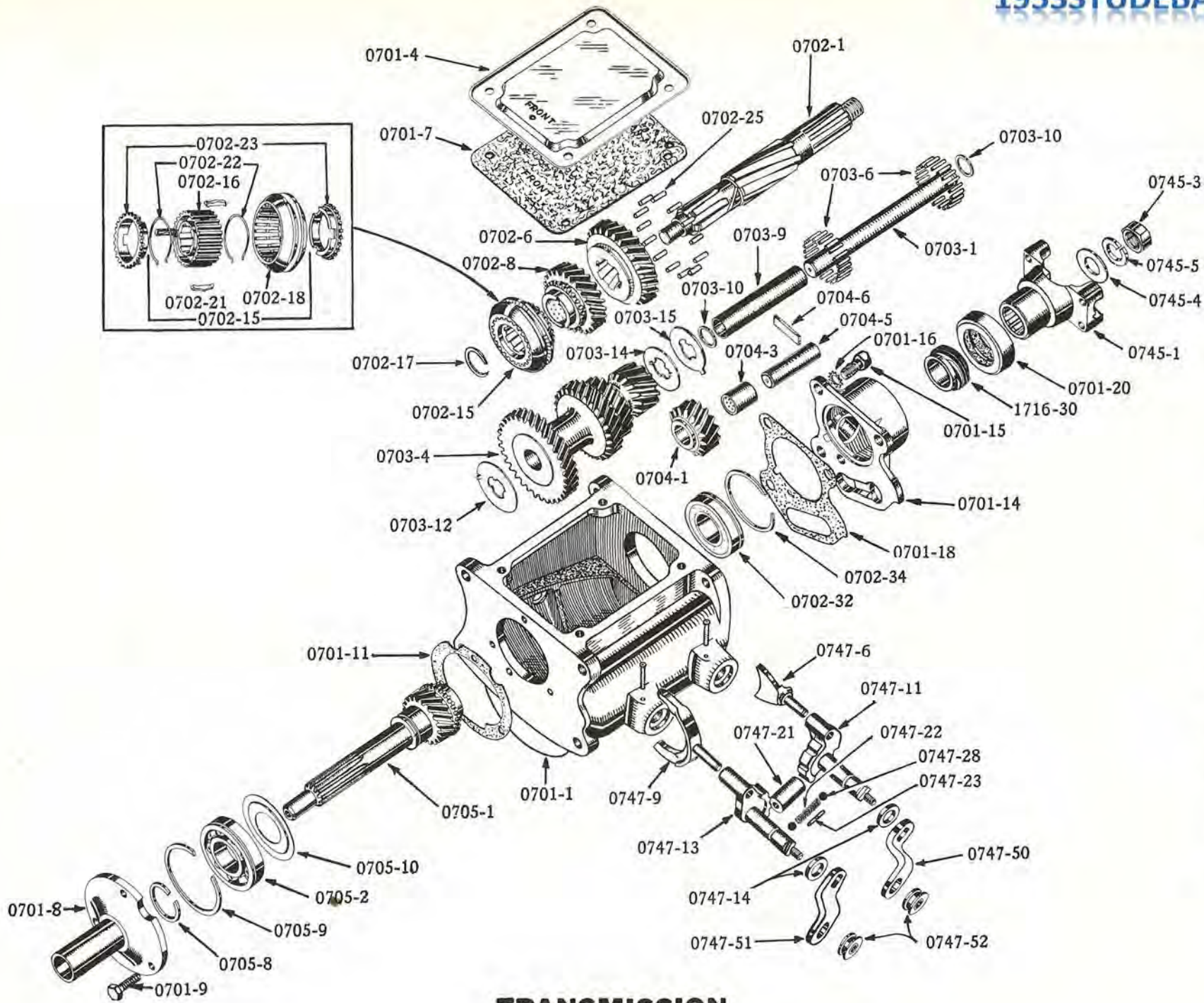

TRANSMISSION

TRANSMISSION - STANDARD AND OVERDRIVE

Plate 07-2

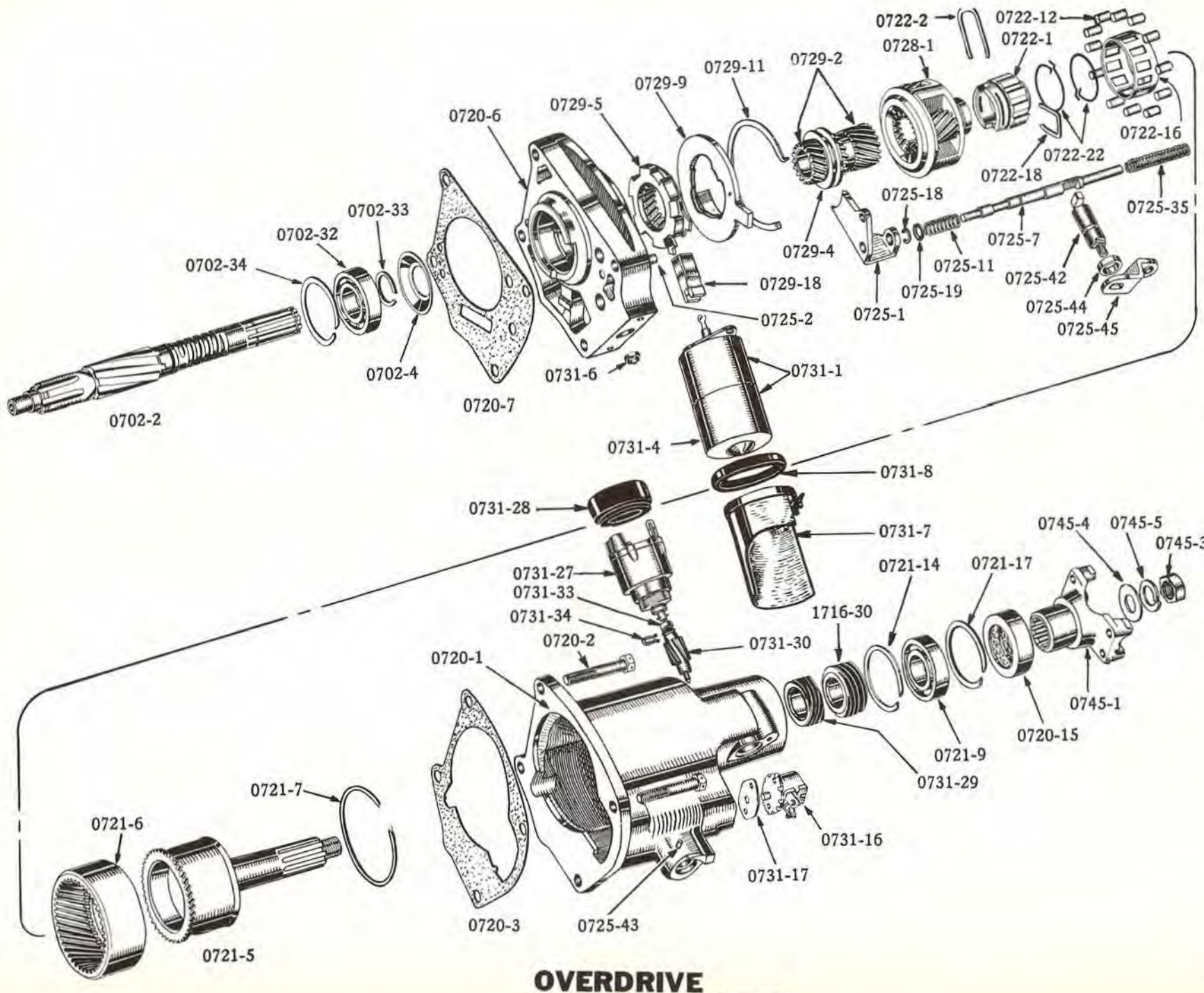

OVERDRIVE

Plate 07-3

TRANSMISSION -
STANDARD AND OVERDRIVE

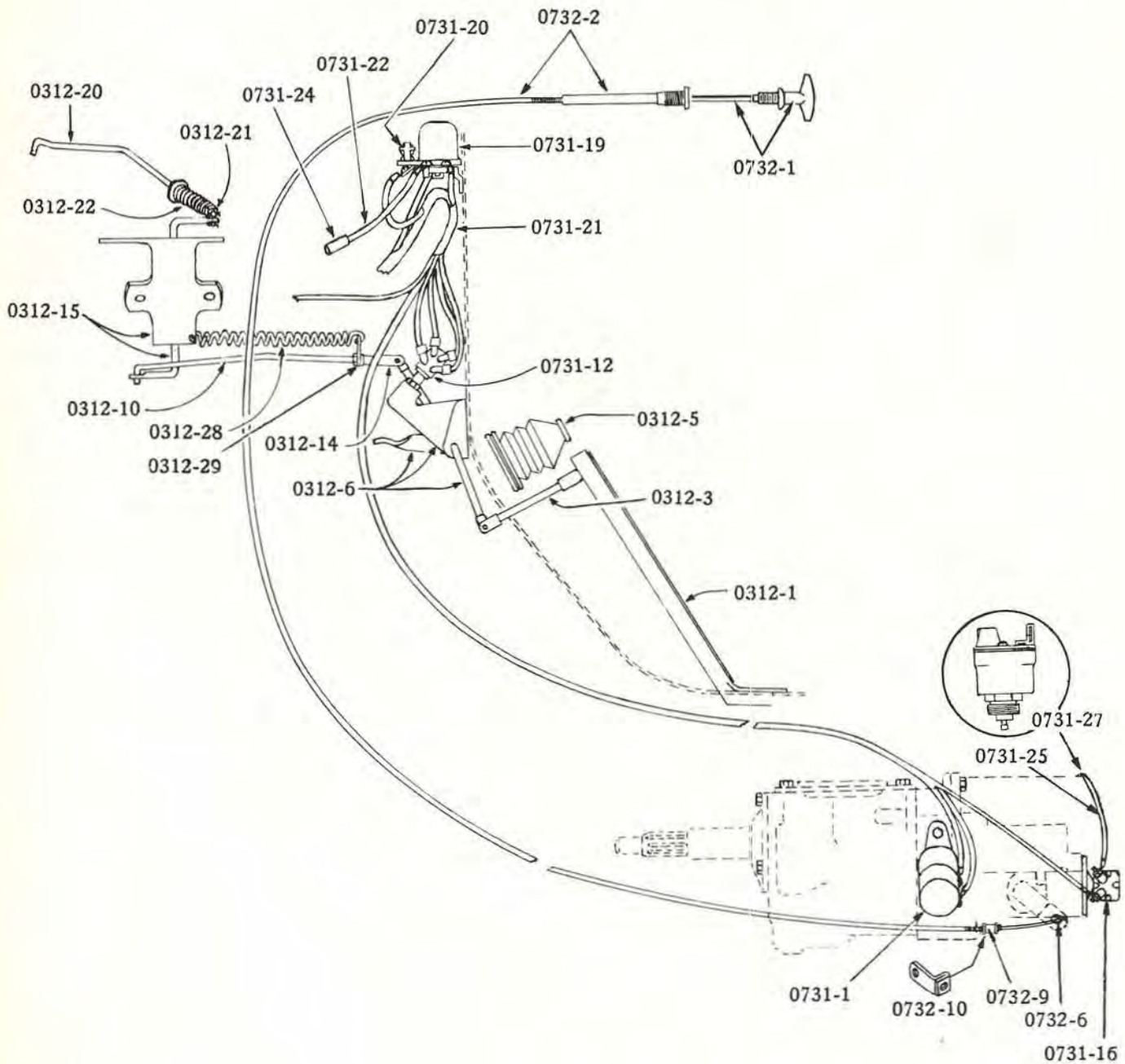

OVERDRIVE CUT-OUT CONTROLS

TRANSMISSION - STANDARD AND OVERDRIVE

Plate 07-4

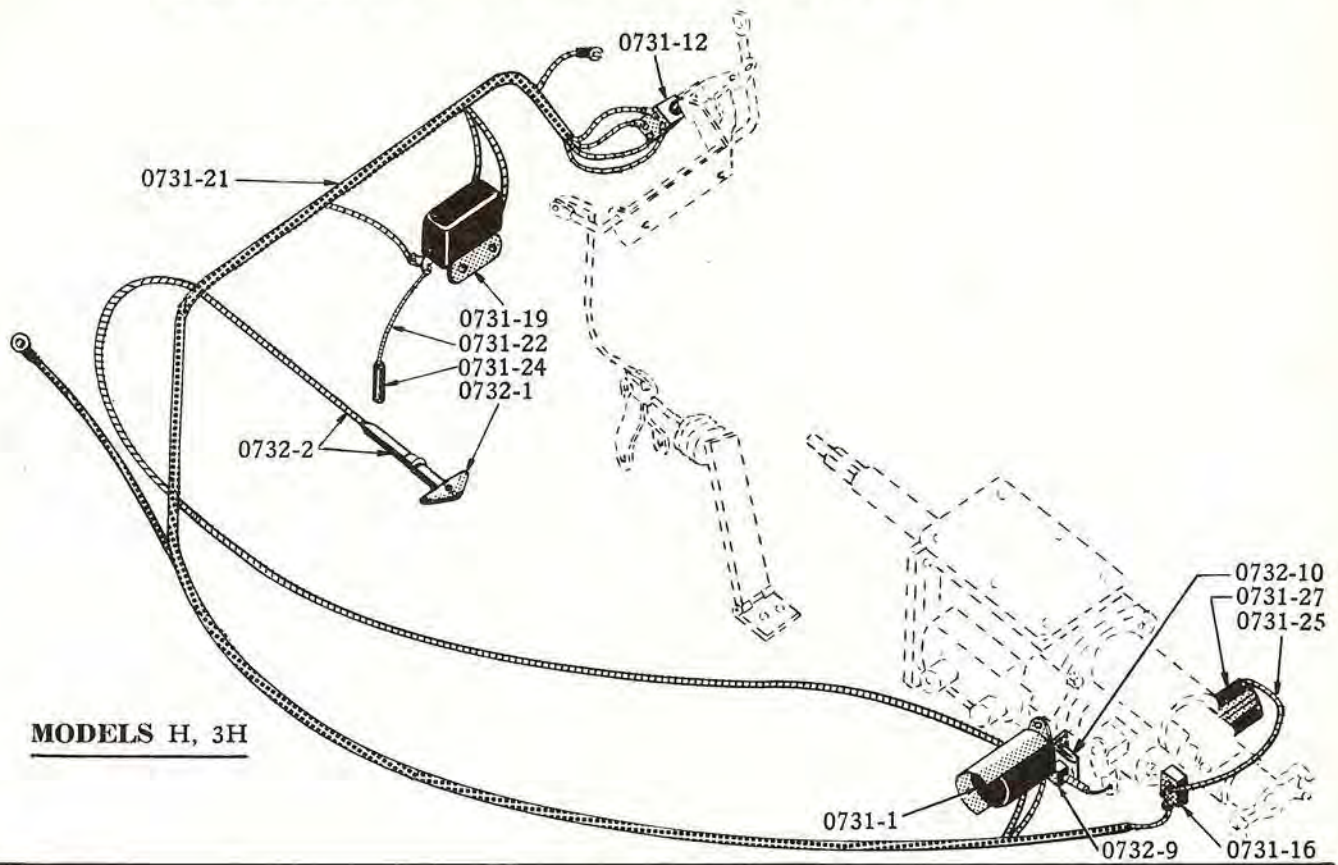

MODELS H, 3H

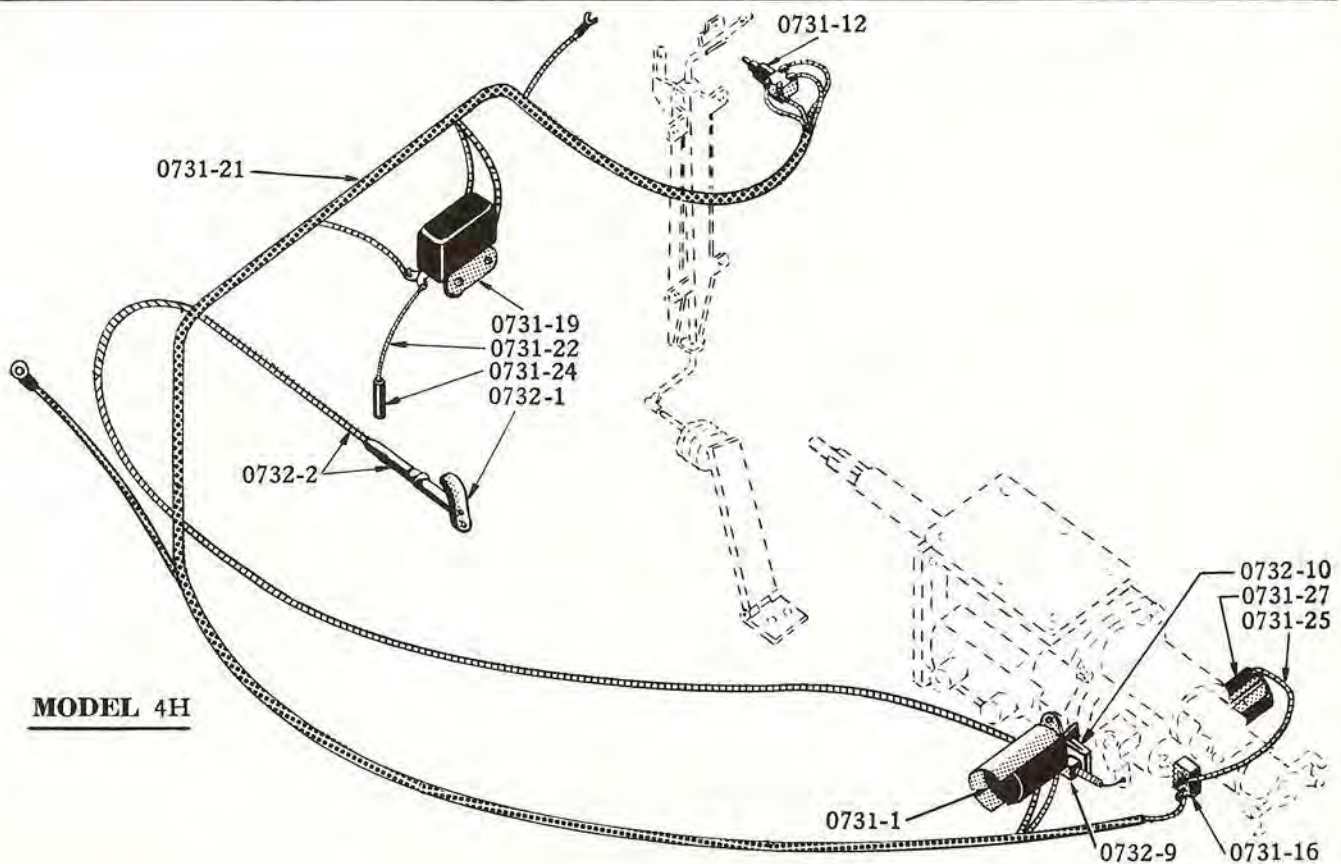

MODEL 4H

OVERDRIVE CUT-OUT CONTROLS

Plate 07-7

TRANSMISSION -
STANDARD AND OVERDRIVE

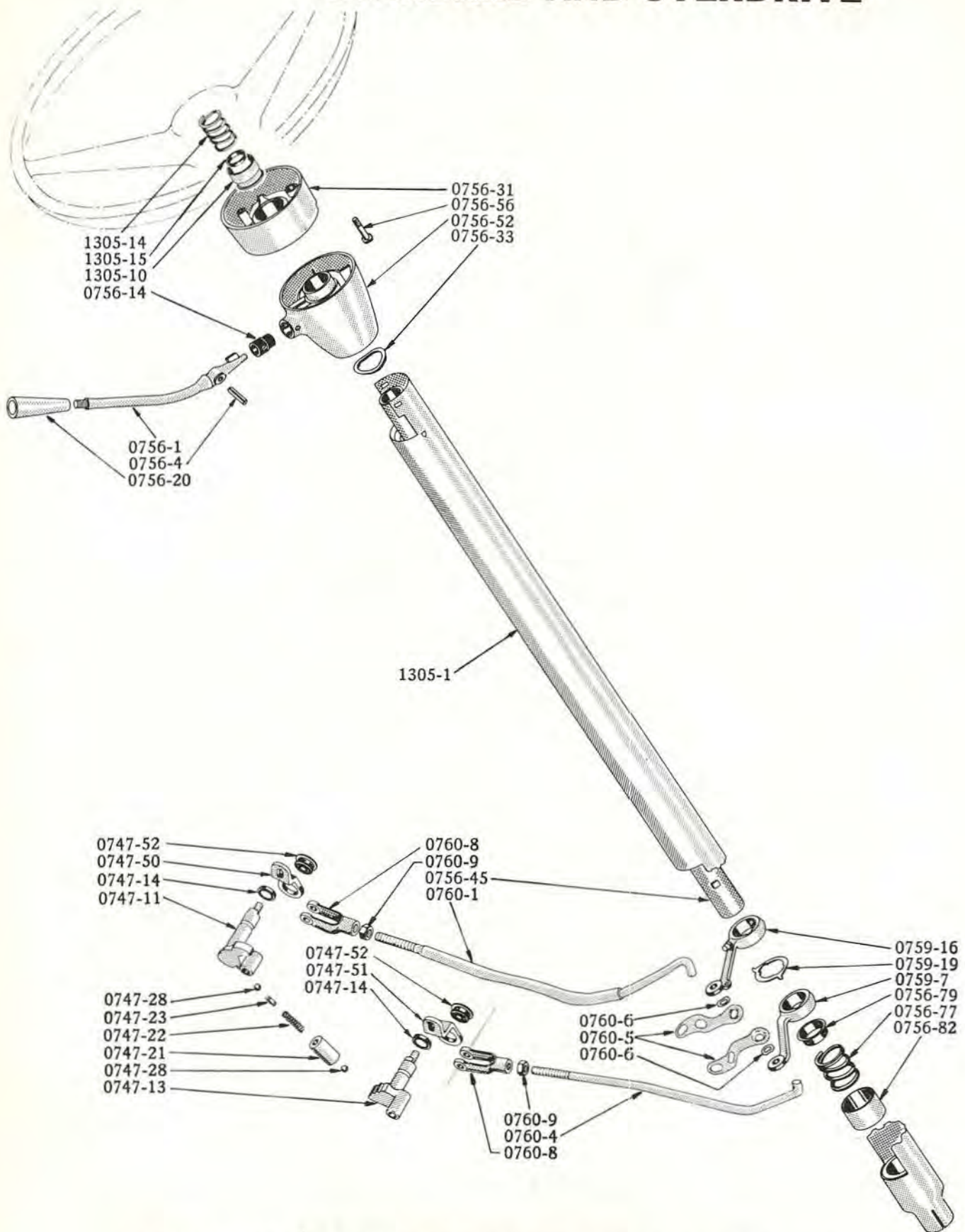

STEERING POST GEARSHIFT - Models 14G, 4H

TRANSMISSION - STANDARD AND OVERDRIVE 0700

ILLUST. NUMBER	PART NUMBER	CHANGE	DESCRIPTION	MODELS	PER CAR
----------------	-------------	--------	-------------	--------	---------

TO INSURE THE PROPER SERVICING OF TRANSMISSION ASSEMBLIES A TRANSMISSION SERIAL NUMBER IS STAMPED ON THE CASE. THIS SERIAL NUMBER WILL BE USED TO RECORD ANY CHANGES AFFECTING THE INTERCHANGEABILITY OF THE COMPONENT PARTS.

THE SERIAL NUMBER IS DECODED AS INDICATED ON SKETCH. LETTERS SIGNIFYING MONTH, RUN IS SEQUENCE FROM A (JANUARY) TO M (DECEMBER) THE LETTER I BEING OMITTED. FACTORY SHIFT HAS NO SIGNIFICANCE.

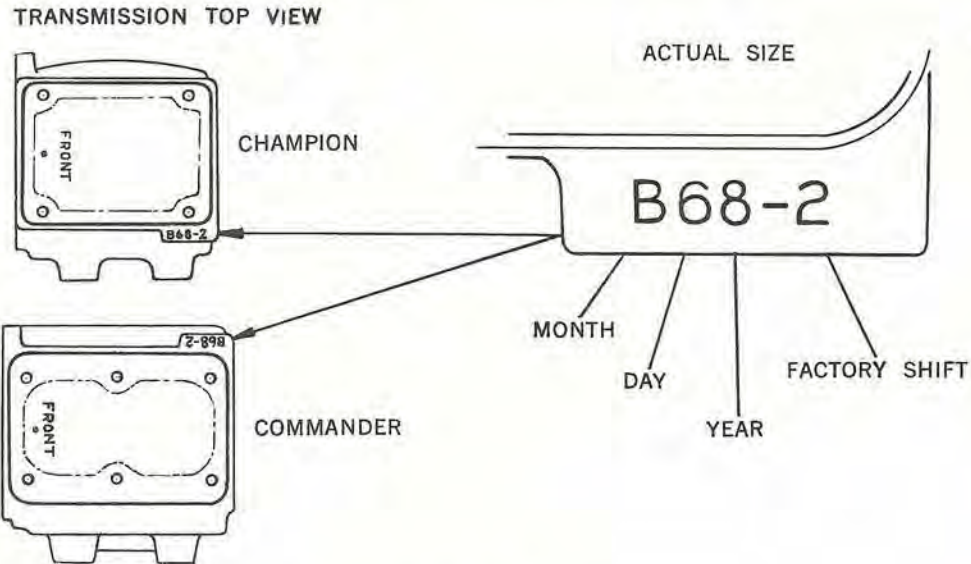

0700- TRANSMISSION ASSEMBLY (Plate 07-1)

ST.-FOR CARS WITH STANDARD TRANSMISSION
 OD -FOR CARS WITH OVERDRIVE TRANSMISSION

517716	TRANSMISSION ASSEMBLY. (ST.) LHC (FOR 4.1 RATIO REAR AXLE).	10G, 12G	1
532117	TRANSMISSION ASSEMBLY. (ST.) LHC (FOR 4.1 RATIO REAR AXLE).	14G	1
525824	TRANSMISSION ASSEMBLY. (ST.) RHC (FOR 4.1 RATIO REAR AXLE).	10G, 12G, 14G	1
525479	* TRANSMISSION ASSEMBLY. (WITH OD) (FOR 4.56 RATIO REAR AXLE)	10G, 12G, 14G	1
529067	TRANSMISSION ASSEMBLY. (ST.) LHC (FOR 4.09 RATIO REAR AXLE)	H, 3H.	1
532255	TRANSMISSION ASSEMBLY. (ST.) LHC (FOR 4.09 RATIO REAR AXLE)	4H.	1
529068	TRANSMISSION ASSEMBLY. (ST.) RHC (FOR 4.09 RATIO REAR AXLE)	H, 3H, 4H	1
529066	* TRANSMISSION ASSEMBLY. (WITH OD) (FOR 4.55 RATIO REAR AXLE)	H, 3H, 4H	1
1-0724	SCREW, TO CLUTCH HOUSING 7/16"-24X1-1/2"	10G, 12G, 14G, H, 3H, 4H	4
380-07	WASHER, LOCK 7/16"	10G, 12G, 14G, H, 3H, 4H	4

* THIS TRANSMISSION IS LESS THE FOLLOWING PARTS AS INDICATED:

1-531067	SOLENOID	1-518948	LEVER - LHC
1-520454	GOVERNOR	1-519425	LEVER - LHC -
1-521436	SWITCH		10G, 12G, 14G
1-521437	GASKET	1-525688	LEVER - RHC -
1-520086	GEAR		10G, 12G, 14G
1-515707	SLEEVE	1-519621	LEVER - LHC -
1-515708	SNAP RING		H, 3H, 4H
1-521439	LEVER	1-524681	LEVER - RHC
1-522023	SHIELD & CLAMP -	1-524682	LEVER - RHC -
	10G, 12G, H, 3H		H, 3H, 4H
1-532296	SHIELD & CLAMP -	2-197565	INSULATOR
	14G, 4H	2-1-0510	SCREW
1-522026	GROMMET	2-384-05	WASHER
1-519826	CABLE	2-380-#10	WASHER
		1-522022	BOOT

0701 TRANSMISSION - STANDARD AND OVERDRIVE

ILLUST. NUMBER	PART NUMBER	CHANGE	DESCRIPTION	MODELS	PER CAR
0701- TRANSMISSION CASE (Plate 07-1)					
0701-1	521419		CASE W/PLUGS. (ST.)	10G.12G.14G	1
0701-1	521420		CASE W/PLUGS. (WITH OD)	10G.12G.14G	1
0701-1	521743		CASE W/PLUGS. (ST.)	H.3H.4H	1
0701-1	523187		CASE W/PLUGS. COVER AND GASKET. (WITH OD)	H.3H.4H	1
	----		PLUG, FILLER OR DRAIN 1/2"	10G.12G.14G.H.3H.4H	2
	674877		PLUG, EXPANSION 23/32"	10G.12G.14G.H.3H.4H	1
0701-4	522379		COVER, CASE	10G.12G.14G	1
0701-4	523182		COVER, CASE (VENTED).	H.3H.4H	1
	1-0510		SCREW, TO CASE 5/16"-18X5/8"	10G.12G.14G	4
	1-0510		SCREW, TO CASE 5/16"-18X5/8"	H.3H.4H	6
	384-05		WASHER, LOCK 5/16"	10G.12G.14G.H.3H.4H	*
0701-7	522378		GASKET, CASE COVER - FIBER (INCL. IN S-637 SET)	10G.12G.14G	1
0710-7	523183		GASKET, CASE COVER - FIBRE (INCL. IN S-636 SET)	H.3H.4H	1
0701-8	197287		FLANGE, FRONT, CASE	10G.12G.14G	1
0701-8	193060		FLANGE, FRONT, CASE	H.3H.4H	1
0701-9	176404		SCREW, TO CASE 5/16"-18X7/8"	10G.12G.14G.H.3H.4H	3
	384-05		WASHER, SHAKEPROOF 5/16"	10G.12G.14G.H.3H.4H	3
			THICK		
0701-11	197234		GASKET, CASE FRONT FLANGE - PAPER (INCL. IN S-637 SET).012	10G.12G.14G	1
0701-11	188296		GASKET, CASE FRONT FLANGE - PAPER (INCL. IN S-636 SET).009	H.3H.4H	#
0701-11	188298		GASKET, CASE FRONT FLANGE - PAPER	H.3H.4H	#
0701-11	188297		GASKET, CASE FRONT FLANGE - PAPER (INCL. IN S-636 SET).018	H.3H.4H	#
0701-11	192306		GASKET, CASE FRONT FLANGE - PAPER	H.3H.4H	#
0701-14	521423		FLANGE, REAR, CASE (ST.)	10G.12G.14G	1
0701-15	1-0714		SCREW, TO CASE 7/16"-14X7/16"	10G.12G.14G	3
0701-15	1-0740		SCREW, TO CASE 7/16"-14X2-1/2"	10G.12G.14G	1
0701-16	384-07		WASHER, SHAKEPROOF 7/8"	10G.12G.14G	4
0701-14	674859		FLANGE, REAR, CASE (ST.)	H.3H.4H	1
0701-15	1-0616		SCREW, TO CASE 3/8"-16X1"	H.3H.4H	4
0701-16	384-06		WASHER, SHAKEPROOF 3/8"	H.3H.4H	4
0701-18	521470		GASKET, CASE REAR FLANGE (ST.) PAPER (INCL. IN S-637 SET) .	10G.12G.14G	1
0701-18	513075		GASKET, CASE REAR FLANGE (ST.) PAPER (INCL. IN S-636 SET) .	H.3H.4H	1
0701-20	198975		OIL SEAL, CASE REAR FLANGE (ST.)	10G.12G.14G.H.3H.4H	1
	S-637		GASKET SET, TRANSMISSION - CONSISTS OF THE FOLLOWING GASKETS:	10G.12G.14G	1
			1-197234 FLANGE, FRONT 1-521499 HOUSING		
			1-521470 FLANGE, REAR 1-521500 PLATE		
			1-522378 COVER		
	S-636		GASKET SET, TRANSMISSION - CONSISTS OF THE FOLLOWING GASKETS:	H.3H.4H	1
			1-188296 FLANGE, FRONT 1.521499 HOUSING		
			1-188297 FLANGE, FRONT 1.522095 PLATE		
			1-513075 FLANGE, REAR 1.523183 COVER		
0702- TRANSMISSION MAIN SHAFT, GEARS AND BEARINGS (Plates 07-1,2)					
	521424		SHAFT AND GEARS, MAIN (ST.) CONSISTS OF:	10G.12G.14G	1
			1-521437 SHAFT 1-527479 GEAR		
			1-521484 SYNCHRONIZER 2-197306 RING		
			1-521483 GEAR 1-197230 SNAP RING		
	521425		SHAFT AND GEARS, MAIN (WITH OD) CONSISTS OF:	10G.12G.14G	1
			1-521474 SHAFT 1-521479 GEAR		
			1-521484 SYNCHRONIZER 2-197306 RING		
			1-521483 GEAR 1-197230 SNAP RING		

NOTES { * - USE AS REQUIRED.
- SELECT SIZE REQUIRED.

TRANSMISSION - STANDARD AND OVERDRIVE 0702

ILLUST. NUMBER	PART NUMBER	CHANGE	DESCRIPTION	MODELS	PER CAR
0702- TRANSMISSION MAIN SHAFT, GEARS AND BEARINGS- Cont'd. (plates 07-1,2)					
	521747	✓	SHAFT AND GEARS, MAIN (ST.) CONSISTS OF: 1-521749 SHAFT 1-521759 GEAR 1-674868 SYNCHRONIZER 2-196149 RING 1-521762 GEAR 1-188348 SNAP RING	H, 3H, 4H	1
	521748		SHAFT AND GEARS, MAIN (WITH OD) CONSISTS OF: 1-521750 SHAFT 1-521759 GEAR 1-674868 SYNCHRONIZER 2-196149 RING 1-521762 GEAR 1-188348 SNAP RING	H, 3H, 4H	1
0702-1	521473		SHAFT, MAIN (ST.)	10G, 12G, 14G	1
0702-2	521474		SHAFT, MAIN (WITH OD)	10G, 12G, 14G	1
0702-1	521749		SHAFT, MAIN (ST.)	H, 3H, 4H	1
0702-2	521750		SHAFT, MAIN (WITH OD)	H, 3H, 4H	1
0702-4	521478		BAFFLE, MAIN SHAFT OIL (WITH OD)	10G, 12G, 14G	1
0702-4	521758		BAFFLE, MAIN SHAFT OIL (WITH OD)	H, 3H, 4H	1
0702-6	521479		GEAR, LOW AND REVERSE SLIDING	10G, 12G, 14G	1
0702-6	521759		GEAR, LOW AND REVERSE SLIDING	H, 3H, 4H	1
0702-8	521483		GEAR AND BUSHING, SECOND SPEED	10G, 12G, 14G	1
0702-8	521762		GEAR AND BUSHING, SECOND SPEED	H, 3H, 4H	1
0702-15	521484		SYNCHRONIZER COMPLETE, SECOND AND HIGH - CONSISTS OF: . . . 1-521486 GEAR 3-521487 PLATE 1-521485 SLEEVE 2-199111 SNAP RING	10G, 12G, 14G	1
0702-15	674868		SYNCHRONIZER COMPLETE, SECOND AND HIGH - CONSISTS OF: . . . 1-674884 GEAR 3-198970 PLATE 1-198968 SLEEVE 2-198971 SNAP RING	H, 3H, 4H	1
0702-16	521486		GEAR, SECOND AND HIGH SYNCHRONIZER	10G, 12G, 14G	1
0702-16	674884		GEAR, SECOND AND HIGH SYNCHRONIZER	H, 3H, 4H	1
0702-17	197230		SNAP RING, 1-1/32" I.D.	10G, 12G, 14G	1
0702-17	188348		SNAP RING, 1-15/64" I.D.	H, 3H, 4H	1
0702-18	521485		SLEEVE, SECOND AND HIGH SYNCHRONIZER	10G, 12G, 14G	1
0702-18	198968		SLEEVE, SECOND AND HIGH SYNCHRONIZER	H, 3H, 4H	1
0702-21	521487		PLATE, SECOND AND HIGH SYNCHRONIZER SHIFTER	10G, 12G, 14G	3
0702-21	198970		PLATE, SECOND AND HIGH SYNCHRONIZER SHIFTER	H, 3H, 4H	3
0702-22	199111		SNAP RING, 1-47/64" I.D.	10G, 12G, 14G	2
0702-22	198971		SNAP RING, 2-3/16" I.D.	H, 3H, 4H	2
0702-23	197306		BLOCKING RING, SECOND AND HIGH SYNCHRONIZER	10G, 12G, 14G	2
0702-23	196149		BLOCKING RING, SECOND AND HIGH SYNCHRONIZER	H, 3H, 4H	2
0702-25	512990		ROLLER, MAIN SHAFT FRONT BEARING	10G, 12G, 14G	13
0702-25	188295		ROLLER, MAIN SHAFT FRONT BEARING	H, 3H, 4H	14
0702-32	197276		BEARING, MAIN SHAFT REAR (ST.)	10G, 12G, 14G	1
0702-34	521745		SNAP RING, LARGE	10G, 12G, 14G	#
0702-34	194272		SNAP RING, LARGE	10G, 12G, 14G	#
0702-32	197275		BEARING, MAIN SHAFT REAR (WITH OD)	10G, 12G, 14G	1
0702-33	197239		SNAP RING, SMALL } LOCATED IN	10G, 12G, 14G	#
0702-33	197240		SNAP RING, SMALL } SHAFT	10G, 12G, 14G	#
0702-33	197241		SNAP RING, SMALL }	10G, 12G, 14G	#
0702-34	512992		SNAP RING, LARGE }	10G, 12G, 14G	#
0702-34	512993		SNAP RING, LARGE }	10G, 12G, 14G	#
0702-34	512994		SNAP RING, LARGE } ADAPTER PLATE	10G, 12G, 14G	#
0702-34	512995		SNAP RING, LARGE }	10G, 12G, 14G	#

NOTE { # - SELECT SIZE REQUIRED.

0702 TRANSMISSION - STANDARD AND OVERDRIVE

ILLUST. NUMBER	PART NUMBER	CHANGE	DESCRIPTION	MODELS	PER CAR
0702- TRANSMISSION MAIN SHAFT, GEARS AND BEARINGS- Cont'd. (Plates 07-1,2)					
0702-32	134030		BEARING, MAIN SHAFT REAR. THICK I.D.	H, 3H, 4H	1
0702-33	188348		SNAP RING, SMALL } WITH OD086 1-15/64"	H, 3H, 4H	#
0702-33	188349		SNAP RING, SMALL } LOCATED IN089 1-15/64"	H, 3H, 4H	#
0702-33	188350		SNAP RING, SMALL } SHAFT092 1-15/64"	H, 3H, 4H	#
0702-33	188351		SNAP RING, SMALL }095 1-15/64"	H, 3H, 4H	#
0702-34	188521		SNAP RING, LARGE } LOCATED IN086 2-19/32"	H, 3H, 4H	#
0702-34	188522		SNAP RING, LARGE } FLANGE AND.089 2-19/32"	H, 3H, 4H	#
0702-34	188523		SNAP RING, LARGE } ADAPTER092 2-19/32"	H, 3H, 4H	#
0702-34	188524		SNAP RING, LARGE } PLATE095 2-19/32"	H, 3H, 4H	#

0703- TRANSMISSION COUNTERSHAFT, GEARS AND BEARINGS (Plate 07-1)

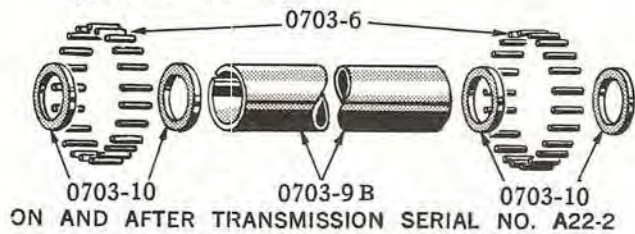
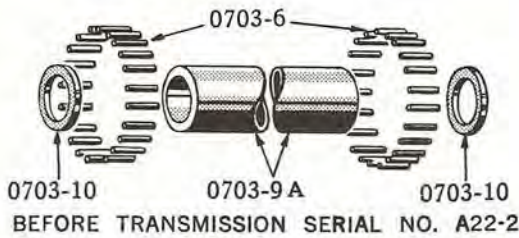

0703-1	521488	COUNTERSHAFT.	10G, 12G, 14G	1
0703-1	521764	COUNTERSHAFT.	H, 3H, 4H	1
0703-4	521489	GEAR CLUSTER, COUNTERSHAFT.	10G, 12G, 14G	1
0703-4	521765	GEAR CLUSTER COUNTERSHAFT.	H, 3H, 4H	1
0703-6	188291	ROLLER, GEAR CLUSTER BEARING.	10G, 12G, 14G	40
0703-6	188291	ROLLER, GEAR CLUSTER BEARING.	H, 3H, 4H	44
0703-9	521490	SPACER, GEAR CLUSTER BEARING ROLLERS (TUBULAR).	10G, 12G, 14G	1
0703-9A	674878	SPACER, GEAR CLUSTER BEARING ROLLERS (TUBULAR) - NOTE 1	H, 3H.	1
0703-9B	531713	SPACER AND WASHER KIT, GEAR CLUSTER BEARING ROLLERS - NOTE 2	3H, 4H	1
0703-10	521491	WASHER, GEAR CLUSTER BEARING ROLLERS SPACER 57/64" O.D.	10G, 12G, 14G	2
0703-10	512927	WASHER, GEAR CLUSTER BEARING ROLLERS SPACER 31/32" O.D. - NOTE 1.	H, 3H.	2
0703-10	512927	WASHER, GEAR CLUSTER BEARING ROLLERS SPACER 31/32" O.D. - NOTE 2.	3H, 4H	4
		O.D.		
0703-12	521492	THRUST WASHER, FRONT, GEAR CLUSTER - STEEL AND BRONZE 2-1/8"	10G, 12G, 14G	1
0703-14	521494	THRUST WASHER, FRONT OF REAR, GEAR CLUSTER - STEEL AND BRONZE 1-29/32"	10G, 12G, 14G	1
0703-15	521493	THRUST WASHER, REAR OF REAR, GEAR CLUSTER - STEEL . 1-29/32"	10G, 12G, 14G	1
0703-12	674873	THRUST WASHER, FRONT, GEAR CLUSTER - BRONZE 2-5/8"	H, 3H, 4H	1
0703-14	674872	THRUST WASHER, FRONT OF REAR, GEAR CLUSTER . STEEL AND BRONZE 1-15/16"	H, 3H, 4H	1
0703-15	674874	THRUST WASHER, REAR OF REAR, GEAR CLUSTER - STEEL . 1-29/32"	H, 3H, 4H	1

0704- TRANSMISSION REVERSE IDLER GEAR AND SHAFT (Plate 07-1)

0704-1	521480	GEAR W/BUSHING, REVERSE IDLER	10G, 12G, 14G	1
0704-1	521760	GEAR W/BUSHING, REVERSE IDLER	H, 3H, 4H	1
0704-3	521481	BUSHING, REVERSE IDLER GEAR	10G, 12G, 14G	1
0704-3	188300	BUSHING, REVERSE IDLER GEAR	H, 3H, 4H	1

NOTES { # - SELECT SIZE REQUIRED.
1 - USED ON MODEL 3H
BEFORE TRANSMISSION SERIAL A22-2
2 - USED ON AND AFTER TRANSMISSION SERIAL IN NOTE 1.

TRANSMISSION - STANDARD AND OVERDRIVE 0720

ILLUST. NUMBER	PART NUMBER	CHANGE	DESCRIPTION	MODELS	PER CAR
0704- TRANSMISSION REVERSE IDLER GEAR AND SHAFT- Cont'd. (Plate 07-1)					
0704-5	521482		SHAFT, REVERSE IDLER GEAR	10G, 12G, 14G	1
0704-5	521761		SHAFT, REVERSE IDLER GEAR	H. 3H, 4H	1
0704-6	513003		LOCK PLATE, REVERSE IDLER SHAFT AND COUNTERSHAFT.	10G, 12G, 14G	1
0704-6	512928		LOCK PLATE, REVERSE IDLER SHAFT AND COUNTERSHAFT.	H. 3H, 4H	1
0705- TRANSMISSION MAIN DRIVE PINION AND BEARINGS (Plate 07-1)					
0705-1	521471		PINION, MAIN DRIVE.	10G, 12G, 14G	1
0705-1	521766		PINION, MAIN DRIVE.	H. 3H, 4H	1
	----		BEARING, FRONT, PINION (SEE CLUTCH PILOT BEARING - GROUP 0207)		
			LOCATED IN THICK I.D.		
0705-2	192302		BEARING, REAR, PINION	10G, 12G, 14G, H. 3H, 4H	1
0705-8	522854		SNAP RING, SMALL PINION.	10G, 12G, 14G	#
0705-8	194275		SNAP RING, SMALL PINION.	10G, 12G, 14G	#
0705-8	197665		SNAP RING, SMALL PINION.	10G, 12G, 14G	#
0705-8	197666		SNAP RING, SMALL PINION.	10G, 12G, 14G	#
0705-8	532763		SNAP RING, SMALL PINION.	10G, 12G, 14G	#
0705-9	514148		SNAP RING, LARGE BEARING.	10G, 12G, 14G	#
0705-9	194276		SNAP RING, LARGE BEARING.	10G, 12G, 14G	#
0705-8	188348		SNAP RING, SMALL PINION.	H. 3H, 4H	#
0705-8	188349		SNAP RING, SMALL PINION.	H. 3H, 4H	#
0705-8	188350		SNAP RING, SMALL PINION.	H. 3H, 4H	#
0705-8	188351		SNAP RING, SMALL PINION.	H. 3H, 4H	#
0705-8	532764		SNAP RING, SMALL PINION.	H. 3H, 4H	#
0705-9	188367		SNAP RING, LARGE BEARING.	H. 3H, 4H	1
0705-10	674880		SLINGER, PINION REAR BEARING OIL.	10G, 12G, 14G, H. 3H, 4H	1

TRANSMISSION OVERDRIVE UNIT

0720- OVERDRIVE HOUSING (Plate 07-2)					
0720-1	525676		HOUSING, OVERDRIVE.	10G, 12G, 14G, H. 3H, 4H	1
	547-06		PLUG, FILLER OR DRAIN.	10G, 12G, 14G, H. 3H, 4H	2
0720-2	1-0740		SCREW, TO TRANSMISSION CASE 7/16"-14X1/2"	10G, 12G, 14G, H. 3H, 4H	4
	380-07		WASHER, LOCK 7/16".	10G, 12G, 14G, H. 3H, 4H	4
0720-3	521499		GASKET, OVERDRIVE HOUSING - PAPER (INCL. S-636, S-637 SETS).	10G, 12G, 14G, H. 3H, 4H	1
0720-6	521428		PLATE, OVERDRIVE HOUSING ADAPTER.	10G, 12G, 14G	1
0720-6	521753		PLATE, OVERDRIVE HOUSING ADAPTER.	H. 3H, 4H	1
0720-7	521500		GASKET, OVERDRIVE HOUSING ADAPTER PLATE - VELLUMOID (INCL. IN S-637 SET).	10G, 12G, 14G	1
0720-7	522095		GASKET, OVERDRIVE HOUSING ADAPTER PLATE - VELLUMOID (INCL. IN S.636 SET).	H. 3H, 4H	1
0720-15	198975		OIL SEAL, REAR, OVERDRIVE HOUSING	10G, 12G, 14G, H. 3H, 4H	1

NOTE { # - SELECT SIZE REQUIRED.

0721 TRANSMISSION - STANDARD AND OVERDRIVE

ILLUST. NUMBER	PART NUMBER	CHANGE	DESCRIPTION	MODELS	PER CAR
		✓			
0721- OVERDRIVE SHAFT AND BEARING (Plate 07-2)					
0721-5	525675		SHAFT, OVERDRIVE. THICK I.D.	10G, 12G, 14G, H, 3H, 4H	1
0721-6	525673		GEAR, OVERDRIVE SHAFT RING.	10G, 12G, 14G, H, 3H, 4H	1
0721-7	521448		SNAP RING.062 .3-29/32"	10G, 12G, 14G, H, 3H, 4H	1
0721-9	531584		BEARING, REAR, OVERDRIVE SHAFT.	10G, 12G, 14G, H, 3H, 4H	1
0721-14	512992		SNAP RING (FOR FRONT OF REAR BEARING). .062 .2-1/4"	10G, 12G, 14G, H, 3H, 4H	1
0721-17	512992		SNAP RING (FOR REAR OF REAR BEARING) .062 .2-1/4"	10G, 12G, 14G, H, 3H, 4H	#
0721-17	512993		SNAP RING (FOR REAR OF REAR BEARING) .065 .2-1/4"	10G, 12G, 14G, H, 3H, 4H	#
0721-17	512994		SNAP RING (FOR REAR OF REAR BEARING) .068 .2-1/4"	10G, 12G, 14G, H, 3H, 4H	#
0721-17	512995		SNAP RING (FOR REAR OF REAR BEARING) .071 .2-1/4"	10G, 12G, 14G, H, 3H, 4H	#
0722- OVERDRIVE FREE WHEELING (FW) CAM (Plate 07-2)					
0722-1	521441		CAM, FW CLUTCH.	10G, 12G, 14G, H, 3H, 4H	1
0722-2	521442		CLIP, RETAINING.	10G, 12G, 14G, H, 3H, 4H	1
0722-12	190917		ROLLER, FW CLUTCH CAM	10G, 12G, 14G, H, 3H, 4H	12
0722-16	521443		RETAINER, FW CLUTCH ROLLER.	10G, 12G, 14G, H, 3H, 4H	1
0722-18	521444		CLIP, RETAINING.	10G, 12G, 14G, H, 3H, 4H	1
0722-22	188541		SPRING, FW CLUTCH ROLLER RETAINER	10G, 12G, 14G, H, 3H, 4H	2
0725- OVERDRIVE SHIFT (Plate 07-2)					
0725-1	525341		FORK, OVERDRIVE SHIFT	10G, 12G, 14G, H, 3H, 4H	1
0725-2	521434		PIN, OVERDRIVE SHIFT FORK GUIDE 2-1/16" LONG.	10G, 12G, 14G, H, 3H, 4H	1
0725-7	525340		RAIL, OVERDRIVE SHIFT	10G, 12G, 14G	1
0725-7	525339		RAIL, OVERDRIVE SHIFT	H, 3H, 4H	1
0725-11	525344		SPRING, OVERDRIVE SHIFT RAIL FORK	10G, 12G, 14G, H, 3H, 4H	1
0725-18	525342		WASHER, "C".	10G, 12G, 14G, H, 3H, 4H	1
0725-19	525343		WASHER, CUPPED 45/64" O.D.	10G, 12G, 14G, H, 3H, 4H	1
0725-35	521431		SPRING, OVERDRIVE SHIFT RAIL REVERSE LOCK UP RETURN	10G, 12G, 14G, H, 3H, 4H	1
0725-42	521438		SHAFT, OVERDRIVE SHIFT.	10G, 12G, 14G, H, 3H, 4H	1
0725-43	450-1020		PIN, LOCATING 1-1/4" LONG	10G, 12G, 14G, H, 3H, 4H	1
0725-44	674869		OIL SEAL, OVERDRIVE SHIFT SHAFT	10G, 12G, 14G, H, 3H, 4H	1
0725-45	521439		LEVER, OVERDRIVE SHIFT SHAFT.	10G, 12G, 14G, H, 3H, 4H	1
	251-05		NUT, TO SHAFT 5/16"-18	10G, 12G, 14G, H, 3H, 4H	1
	361-05		WASHER, PLAIN 5/16"	10G, 12G, 14G, H, 3H, 4H	1
	380-05		WASHER, LOCK 5/16".	10G, 12G, 14G, H, 3H, 4H	1
0728- OVERDRIVE PINION CAGE (Plate 07-2)					
0728-1	521459		CAGE COMPLETE, OD PINION (COMPONENT PARTS OF THIS CAGE NOT SUPPLIED SEPARATELY)	10G, 12G, 14G, H, 3H, 4H	1

NOTE {# - SELECT SIZE REQUIRED.

TRANSMISSION - STANDARD AND OVERDRIVE 073

ILLUST. NUMBER	PART NUMBER	CHANGE	DESCRIPTION	MODELS	PER CAR
0729- OVERDRIVE STATIONARY OR SUN GEAR (Plate 07-2)					
0729-2	521450		GEAR, OVERDRIVE STATIONARY OR SUN LOCATED IN THICK I.D.	10G, 12G, 14G, H, 3H, 4H	1
0729-4	521451		COLLAR, OVERDRIVE STATIONARY OR SUN GEAR SHIFTING	10G, 12G, 14G, H, 3H, 4H	1
	521452		SNAP RING.0625. -1-15/32"	10G, 12G, 14G, H, 3H, 4H	2
0729-5	522172		PLATE AND BLOCKING RING, OVERDRIVE STATIONARY OR SUN GEAR .	10G, 12G, 14G, H, 3H, 4H	1
0729-9	522161		PLATE, OD STATIONARY OR SUN GEAR.	10G, 12G, 14G, H, 3H, 4H	1
0729-11	521456		SNAP RING.ADAPTER PLATE. . .0625. -3-27/32"	10G, 12G, 14G, H, 3H, 4H	#
0729-11	521457		SNAP RING.ADAPTER PLATE. . .0665. -3-27/32"	10G, 12G, 14G, H, 3H, 4H	#
0729-11	521458		SNAP RING.ADAPTER PLATE. . .0705. -3-27/32"	10G, 12G, 14G, H, 3H, 4H	#
0729-18	525345		PAWL, OVERDRIVE STATIONARY OR SUN GEAR.	10G, 12G, 14G, H, 3H, 4H	1
0731- OVERDRIVE CUT-OUT CONTROL (Plates 07-2, 3, 4)					
0731-1	531067		SOLENOID, OVERDRIVE (MODEL 1118155)	10G, 12G, 14G, H, 3H, 4H	1
	56-#10-8		SCREW, TERMINAL NO. 10-32X1/2"	10G, 12G, 14G, H, 3H, 4H	2
	----		WASHER, LOCK NO. 10	10G, 12G, 14G, H, 3H, 4H	2
	1-0510		SCREW, TO ADAPTER PLATE 5/16"-18X5/8"	10G, 12G, 14G, H, 3H, 4H	2
	384-05		WASHER, LOCK 5/16"	10G, 12G, 14G, H, 3H, 4H	2
0731-4	524397		COVER, OD SOLENOID (STAMPED 1118132).	10G, 12G, 14G, H, 3H, 4H	1
0731-4	525762		COVER, OD SOLENOID (FOR 531067)	10G, 12G, 14G, H, 3H, 4H	1
0731-6	196183		OIL SEAL, OD SOLENOID PAWL OPERATING ROD.	10G, 12G, 14G, H, 3H, 4H	1
0731-7	522023		SHIELD AND CLAMP, OD SOLENOID	10G, 12G, H, 3H.	1
0731-7	532296		SHIELD AND CLAMP, OD SOLENOID	14G, 4H.	1
0731-8	522026		GROMMET, OD SOLENOID SHIELD - RUBBER.	10G, 12G, 14G, H, 3H, 4H	1
0731-12	529479		SWITCH, OD ACCELERATOR KICKDOWN	10G, 12G, 14G, H, 3H.	1
0731-12	532896		SWITCH, OD ACCELERATOR KICKDOWN - LHC	4H.	1
0731-12	529479		SWITCH, OD ACCELERATOR KICKDOWN - RHC	4H.	1
	195893		LOCK NUT, TO BRACKET 7/16"-20.	10G, 12G, 14G, H, 3H.	1
	195893		LOCK NUT, TO DASH 7/16"-20 - LHC	4H.	1
	195893		LOCK NUT, TO DASH 7/16"-20 - RHC	4H.	1
	521037		BRACKET, OD ACCELERATOR KICKDOWN SWITCH - RHC	10G, 12G, 14G	1
0731-16	521436		SWITCH, OD CONTROL LOCKOUT (LOCATED ON HOUSING)	10G, 12G, 14G, H, 3H, 4H	1
	----		SCREW, TERMINAL NO. 8-32X1/4"	10G, 12G, 14G, H, 3H, 4H	2
	667598		WASHER, LOCK, SPECIAL	10G, 12G, 14G, H, 3H, 4H	2
	55-#10-7		SCREW, TO HOUSING NO. 10-24X7/16"	10G, 12G, 14G, H, 3H, 4H	2
	----		WASHER, LOCK NO. 10.	10G, 12G, 14G, H, 3H, 4H	2
0731-17	521437		GASKET, OD CONTROL LOCKOUT SWITCH (RUBBER COATED)	10G, 12G, 14G, H, 3H, 4H	1
0731-19	523297		RELAY, OD SOLENOID CONTROL (LOCATED ON DASH).	10G, 12G, 14G, H, 3H, 4H	1
	614-#14-8		SCREW, TO DASH NO. 14X1/2".	10G, 12G, 14G, H, 3H, 4H	2
	----		SCREW, TERMINAL NO. 10-32X5/16"	10G, 12G, 14G, H, 3H, 4H	4
	----		WASHER, LOCK NO. 10.	10G, 12G, 14G, H, 3H, 4H	4
0731-20	108932		FUSE, OD SOLENOID CONTROL RELAY - 20 AMP.	10G, 12G, 14G, H, 3H, 4H	1
0731-21	527426		HARNESS, OD CONTROL WIRING - LHC.	10G, 12G	1
0731-21	527510		HARNESS, OD CONTROL WIRING - RHC.	10G, 12G	1
0731-21	530355		HARNESS, OD CONTROL WIRING - LHC.	H	1
0731-21	530874		HARNESS, OD CONTROL WIRING - RHC.	H	1
0731-21	531727		HARNESS, OD CONTROL WIRING.	3H.	1
0731-21	534004		HARNESS, OD CONTROL WIRING - EXCEPT C-K-LHC	14G	1
0731-21	532636		HARNESS, OD CONTROL WIRING - C-K-LHC.	14G	1

NOTE {# - SELECT SIZE REQUIRED.

0731 TRANSMISSION - STANDARD AND OVERDRIVE

ILLUST. NUMBER	PART NUMBER	CHANGE ✓	DESCRIPTION	MODELS	PER CAR
0731- OVERDRIVE CUT-OUT CONTROL-Cont'd.					
(Plates 07-2,3,4)					
0731-21	533581		HARNESS, OD CONTROL WIRING - EXCEPT C-K	14G	1
0731-21	532635		HARNESS, OD CONTROL WIRING - EXCEPT C-K	4H.	1
0731-21	534399		HARNESS, OD CONTROL WIRING - C-K-LHC.	4H.	1
0731-21	533728		HARNESS, OD CONTROL WIRING - EXCEPT C-K	4H.	1
0731-22	530314		CABLE, CHASSIS CABLE TO OD RELAY - LHC.	10G,12G	1
0731-22	519827		CABLE, CHASSIS CABLE TO OD RELAY - RHC.	10G,12G	1
0731-22	530314		CABLE, CHASSIS CABLE TO OD RELAY.	14G	1
0731-22	519827		CABLE, CHASSIS CABLE TO OD RELAY.	H,3H,4H	1
0731-24	192545		CONNECTOR, TRANS. OD CABLES	10G,12G,14G,H,3H,4H	1
0731-25	519826		CABLE, OD LOCKOUT SWITCH TO GOVERNOR.	10G,12G,14G,H,3H,4H	1
	30264		TERMINAL, CABLES EYELET 15/32"	10G,12G,14G,H,3H,4H	*
	198667		TERMINAL, CABLES - PUSH	10G,12G,14G,H,3H,4H	*
	256116		TERMINAL, CABLES - SPADE.	10G,12G,14G,H,3H,4H	*
	31834		TERMINAL, CABLES - EYELET 13/64".	10G,12G,14G,H,3H,4H	*
	181814		CLIP, OPEN, OD CABLES TO DASH - RHC	10G,12G,4H.	2
	190470		CLIP, OPEN, OD CABLES TO DASH	10G,12G	1
	172653		CLIP, OPEN, OD CABLES TO DASH - LHC	14G	1
	190470		CLIP, OPEN, OD CABLES TO DASH - EXCEPT C-K-RHC.	14G	1
	511382		CLIP, OPEN, OD CABLES TO DASH - EXCEPT C-K-RHC.	14G	1
	511382		CLIP, OPEN, OD CABLES TO DASH - LHC	H,3H.	2
614-#14-8			SCREW, BINDING HEAD NO.14X1/2"	10G,12G,14G,H	*
638-#10-10			SCREW, SELF-TAPPING NO.10X5/8"	3H.	1
	190470		CLIP, OPEN, OD CABLES TO FLOOR PAN.	10G,12G	2
	172653		CLIP, OPEN, OD CABLES TO FLOOR PAN.	H,3H.	1
	190470		CLIP, OPEN, OD CABLES TO FLOOR PAN.	14G,4H.	1
	55-0416		SCREW, 1/4"-20X1".	10G,12G,14G,H,3H,4H	1
	251-04		NUT, SQUARE 1/4"-20.	10G,12G,14G,H,3H,4H	1
	----		WASHER, LOCK 1/4"	10G,12G,14G,H,3H,4H	1
	182050		CLIP, OPEN, OD CABLES TO RELAY SCREW.	10G,12G	1
	286138		CLIP, OPEN, OD CABLES TO STARTER MOTOR - LHC.	10G,12G,14G	1
	526600X3		CLIP, LACER, OD AND CHASSIS CABLES (W/POWER STEER) C-K.	14G	1
	526600X3		CLIP, LACER, OD AND CHASSIS CABLES.	4H.	1
	532855		GROMMET, OD CABLES DASH	4H.	1
0731-27	520454		GOVERNOR, OD CONTROL.	10G,12G,14G,H,3H,4H	1
0731-28	522022		BOOT, OD CONTROL GOVERNOR - RUBBER.	10G,12G,14G,H,3H,4H	1
0731-29	520085		GEAR, OD CONTROL GOVERNOR - 7 TEETH (SW-NO. 447082) (LOCATED ON OD SHAFT)	10G,12G,14G,H,3H,4H	1
0731-30	520086		GEAR, OD CONTROL GOVERNOR - 15 TEETH (SW-NO. 448128) (LOCATED ON GOVERNOR)	10G,12G,14G,H,3H,4H	1
0731-33	515707		SLEEVE, GOVERNOR GEAR.	10G,12G,14G,H,3H,4H	1
0731-34	515708		SNAP RING, GOVERNOR GEAR 23/64" I.D.	10G,12G,14G,H,3H,4H	1
0732- OVERDRIVE CONTROL - ON DASH (plates 07-3,4)					
0732-1	526114		BUTTON AND WIRE, OD CONTROL (CUT TO LENGTH REQUIRED).	10G,12G,H,3H.	1
0732-1	532615X2		BUTTON AND WIRE, OD CONTROL (CUT TO LENGTH REQUIRED).	14G,4H.	1
0732-2	530175		SLEEVE AND TUBE, OD CONTROL - LHC	10G,12G	1
0732-2	532614X1		SLEEVE AND TUBE, OD CONTROL - LHC	14G,4H.	1
0732-2	526113		SLEEVE AND TUBE, OD CONTROL - RHC	10G,12G,H,3H.	1
0732-2	532614X2		SLEEVE AND TUBE, OD CONTROL - RHC	14G,4H.	1
0732-2	526110		SLEEVE AND TUBE, OD CONTROL - LHC	H,3H.	1
	287169		NUT, TO INSTRUMENT BOARD 1/2"-20	10G,12G,14G,H,3H,4H	1
	384-08		WASHER, LOCK 1/2"	10G,12G,14G,H,3H,4H	1
	511382		CLIP, TO STEERING GEAR	10G,12G	1
	186090P		CLIP, TO CLUTCH HOUSING - W-F-RHC.	14G	1

NOTE { * - USE AS REQUIRED.

TRANSMISSION - STANDARD AND OVERDRIVE 0747

ILLUST. NUMBER	PART NUMBER	CHANGE	DESCRIPTION	MODELS	PER CAR
0732- OVERDRIVE CONTROL - ON DASH-Cont'd.					
(Plates 07-3, 4)					
	533302P	✓	BRACKET, OD CONTROL	14G, 4H.	1
	1023-#10-7		SCREW, TO INST. BOARD, NO.10-24X7/16"	14G, 4H.	2
0732-6	185336		SWIVEL, OD CONTROL (ON SHIFTER LEVER)	10G, 12G, 14G, H, 3H, 4H	1
	195235		BOLT, ON SHIFTER LEVER 5/16"-24X7/8"	10G, 12G, 14G, H, 3H, 4H	1
	252-05		NUT, HEX. 5/16"-24.	10G, 12G, 14G, H, 3H, 4H	1
	361-05		WASHER, PLAIN 5/16"	10G, 12G, 14G, H, 3H, 4H	1
	380-05		WASHER, LOCK 5/16"	10G, 12G, 14G, H, 3H, 4H	1
0732-9	176542		SWIVEL, OD CONTROL (ON CONDUIT)	10G, 12G, 14G, H, 3H, 4H	1
	176541		BOLT, ON CONDUIT 1/4"-28X1"	10G, 12G, 14G, H, 3H, 4H	1
	252-04		NUT, HEX. 1/4"-28	10G, 12G, 14G, H, 3H, 4H	1
	----		WASHER, PLAIN 1/4"	10G, 12G, 14G, H, 3H, 4H	1
0732-10	519265		BRACKET, OD CONTROL CONDUIT SUPPORT (FASTENED TO OD HOUSING)	10G, 12G, H, 3H.	1
0732-10	532622		BRACKET, OD CONTROL CONDUIT SUPPORT (FASTENED TO OD HOUSING)	14G, 4H.	1
0745- TRANSMISSION UNIVERSAL JOINT FLANGE					
(Plates 07-1, 2)					
0745-1	196406		FLANGE, UNIVERSAL JOINT	10G, 12G, 14G, H, 3H, 4H	1
0745-3	179233		NUT, TO TRANSMISSION SHAFT 3/4"-16	10G, 12G, 14G, H, 3H, 4H	1
0745-4	180747		WASHER, PLAIN 49/64"	10G, 12G, 14G, H, 3H, 4H	1
0745-5	380-12		WASHER, LOCK 3/4"	10G, 12G, 14G, H, 3H, 4H	1
0747- GEARSHIFT FORKS AND LEVERS (Plates 07-1, 5, 6, 7)					
0747-6	521497		SHOE, GEARSHIFT LOW AND REVERSE (ALSO KNOWN AS FORK)	10G, 12G, 14G	1
0747-6	674883		SHOE, GEARSHIFT LOW AND REVERSE (ALSO KNOWN AS FORK)	H, 3H, 4H	1
0747-9	521496		FORK, GEARSHIFT SECOND AND HIGH	10G, 12G, 14G	1
0747-9	198973		FORK, GEARSHIFT SECOND AND HIGH	H, 3H, 4H	1
0747-11	521469		LEVER AND SHAFT, INNER, LOW AND REVERSE SHIFT	10G, 12G, 14G	1
0747-11	525337		LEVER AND SHAFT, INNER, LOW AND REVERSE SHIFT	H, 3H, 4H	1
0747-13	521467		LEVER AND SHAFT, INNER, SECOND AND HIGH SHIFT	10G, 12G, 14G	1
0747-13	525368		LEVER AND SHAFT, INNER, SECOND AND HIGH SHIFT	H, 3H, 4H	1
	450-1020		PIN, LOCATING OR RETAINING 1-1/4" LONG	10G, 12G, 14G, H, 3H, 4H	2
0747-14	674869		OIL SEAL, INNER SHIFT LEVER SHAFT	10G, 12G, 14G, H, 3H, 4H	2
			IDENTIFICATION		
			LENGTH LETTER		
0747-21	674890		SLEEVE, INNER SHIFT LEVER INTERLOCK .1,287.C.	10G, 12G, 14G, H, 3H, 4H	#
0747-21	674889		SLEEVE, INNER SHIFT LEVER INTERLOCK .1,291.B.	10G, 12G, 14G, H, 3H, 4H	#
0747-21	674888		SLEEVE, INNER SHIFT LEVER INTERLOCK .1,295.A.	10G, 12G, 14G, H, 3H, 4H	#
0747-21	674887		SLEEVE, INNER SHIFT LEVER INTERLOCK .1,299.NOT MARKED	10G, 12G, 14G, H, 3H, 4H	#
0747-21	521498		SLEEVE, INNER SHIFT LEVER INTERLOCK .1,303.D.	10G, 12G, 14G, H, 3H, 4H	#
			LENGTH		
0747-22	674885		SPRING, INNER SHIFT LEVER INTERLOCK 1-11/64"	10G, 12G, 14G, H, 3H, 4H	1
0747-23	527517		PLUNGER, INNER SHIFT LEVER INTERLOCK.	10G, 12G, 14G, H, 3H, 4H	1
0747-28	470-10		BALL, BEARING, INNER SHIFT LEVER INTERLOCK - 5/16"	10G, 12G, 14G, H, 3H, 4H	2

NOTE { # - SELECT SIZE REQUIRED.

0747 TRANSMISSION - STANDARD AND OVERDRIVE

ILLUST. NUMBER	PART NUMBER	CHANGE	DESCRIPTION	MODELS	PER CAR
0747- GEARSHIFT FORKS AND LEVERS-Cont'd. (Plates 07-1, 5, 6, 7)					
0747-50	518948		LEVER, OUTER, LOW AND REVERSE SHIFT - LHC	10G, 12G, 14G, H, 3H, 4H	1
0747-50	524681		LEVER, OUTER, LOW AND REVERSE SHIFT - RHC	10G, 12G, 14G, H, 3H, 4H	1
0747-51	519425		LEVER, OUTER, SECOND AND HIGH SHIFT - LHC	10G, 12G, 14G, H, 3H, 4H	1
0747-51	519621		LEVER, OUTER, SECOND AND HIGH SHIFT - LHC	H, 3H, 4H	1
0747-51	525688		LEVER, OUTER, SECOND AND HIGH SHIFT - RHC	10G, 12G, 14G	1
0747-51	524682		LEVER, OUTER, SECOND AND HIGH SHIFT - RHC	H, 3H, 4H	1
	251-05		NUT, HEX. TO INNER LEVER 5/16"-18.	10G, 12G, 14G, H, 3H, 4H	2
	361-05		WASHER, PLAIN 5/16"	10G, 12G, 14G, H, 3H, 4H	2
	380-05		WASHER, LOCK 5/16"	10G, 12G, 14G, H, 3H, 4H	2
0747-52	197565		INSULATOR, OUTER SHIFT LEVER - LHC.	10G, 12G, 14G, H, 3H, 4H	2

STEERING POST GEARSHIFT

ILLUST. NUMBER	PART NUMBER	DESCRIPTION	MODELS	PER CAR
0756- GEARSHIFT HAND LEVER AND SHAFT (Plates 07-5, 6, 7)				
0756-1	530030P	LEVER, GEARSHIFT.	10G, 12G, H, 3H.	1
0756-1	532996P	LEVER, GEARSHIFT.	14G, 4H.	1
0756-4	195669	PIN, TO SHAFT AND LEVER 3/8"X4 3/64"	10G, 12G, H, 3H.	1
0756-4	532886	PIN, PIVOT TUBULAR 1" LONG	14G, 4H.	1
	145-#10-5W	SCREW, PIN RETAINING NO. 10-24X5/16"	10G, 12G, H, 3H.	1
	----	WASHER, LOCK NO. 10.	10G, 12G, H, 3H.	1
0756-10	196523	WASHER, SPRING 25/64"	10G, 12G, H, 3H.	1
0756-11	524640	SPRING, LEVER ANTI-RATTLE.	10G, 12G, H, 3H.	1
0756-14	532551	GROMMET, LEVER	14G, 4H.	1
0756-20	515645X4	KNOB, GEARSHIFT LEVER	10G, 12G, H, 3H.	1
0756-20	533343	KNOB, GEARSHIFT LEVER	14G, 4H.	1

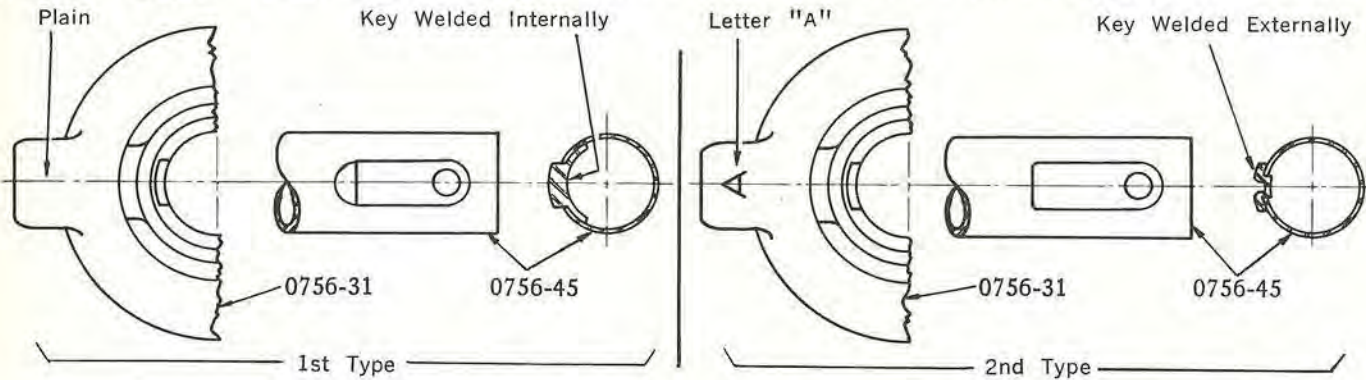

Cross Section of Lever Support and Shaft

0756-31 ▲	532877P	SUPPORT, LEVER (LESS POWER STEER) USE 534092P AND 534094.	} NOTE 7.	14G, 4H.	1
0756-31 ▲	532877P	SUPPORT, LEVER (WITH POWER STEER) W-Y-F USE 534092P AND 534095.		14G, 4H.	1
0756-31 ▲	532877P	SUPPORT, LEVER (WITH POWER STEER) C-K USE 534092P AND 534096.		14G, 4H.	1
0756-31	534092P	SUPPORT, LEVER - NOTE 8		14G, 4H.	1
0756-33	532545	WASHER, SPRING 1 1/2" I.D.		14G, 4H.	1

- NOTES
- ▲ - NOT AVAILABLE.
 - 7 - 1ST TYPE: IDENTIFIED BY PLAIN LEVER SUPPORT HOLE SOCKET OR BY SHAFT WITH KEY WELDED INTERNALLY - SEE ILLUSTRATION.
 - 8 - 2ND TYPE: IDENTIFIED BY LETTER "A" UNDER LEVER SUPPORT HOLE SOCKET OR BY SHAFT WITH KEY WELDED EXTERNALLY - SEE ILLUSTRATION.

TRANSMISSION - STANDARD AND OVERDRIVE 0756

ILLUST. NUMBER	PART NUMBER	CHANGE	DESCRIPTION	MODELS	PER CAR
0756- GEARSHIFT HAND LEVER AND SHAFT-Cont'd.					
(Plates 07-5,6,7)					
0756-45	530027		SHAFT AND LEVER, GEARSHIFT - LHC.	10G, 12G, H, 3H.	1
	530755		SHAFT AND LEVER, GEARSHIFT - RHC.	10G, 12G, H, 3H.	1
0756-45	▲ 532542		SHAFT, GEARSHIFT TUBULAR (LESS POWER STEER) USE 534094 AND 534092P	14G, 4H.	1
0756-45	▲ 533293		SHAFT, GEARSHIFT TUBULAR (WITH POWER STEER) W-Y-F- USE 534095 AND 534092P.		
0756-45	▲ 533294		SHAFT, GEARSHIFT TUBULAR (WITH POWER STEER) C-K- USE 534096 AND 534092P.	14G, 4H.	1
0756-45	534094		SHAFT, GEARSHIFT TUBULAR (LESS POWER STEER)	14G, 4H.	1
0756-45	534095		SHAFT, GEARSHIFT TUBULAR (WITH POWER STEER) EXCEPT C-K	14G, 4H.	1
0756-45	534096		SHAFT, GEARSHIFT TUBULAR (WITH POWER STEER) C-K.		
0756-47	527737		PIN, SHAFT SHIFTER 5/16"X61/64".	10G, 12G, H, 3H.	1
0756-52	530065		BRACKET, UPPER, SHAFT - LHC - NOTE 3 (ILLUST. PLATE 07-5)	10G	1
0756-52	530026		BRACKET, UPPER, SHAFT - LHC - NOTE 4 (ILLUST. PLATE 07-6)	10G	1
0756-52	530065		BRACKET, UPPER, SHAFT -WI-FI-CI-LHC	12G	1
0756-52	530026		BRACKET, UPPER, SHAFT - EXCEPT WI-FI-CI-LHC	12G	1
0756-52	530065		BRACKET, UPPER SHAFT - RHC.	10G, 12G, H, 3H.	1
0756-52	530026		BRACKET, UPPER SHAFT - LHC.	H, 3H.	1
0756-52	532878		BRACKET W/BEARING, UPPER, SHAFT (LESS POWER STEER).	14G, 4H.	1
0756-52	534411		BRACKET W/BEARING, UPPER, SHAFT (W/POWER STEER) NOTE 6.	14G, 4H.	1
	41-0414		SCREW, CLAMPING 1/4"-20X7/8" (FOR 530065).	10G, 12G, H, 3H.	1
	----		SCREW, TO JACKET NO. 10-32X3/8" (FOR 530026).	10G, 12G, H, 3H.	4
0756-56	532549		BOLT, ANCHOR, TO JACKET 1/4"-28X47/64".	14G, 4H.	2
	532550		NUT, SPECIAL 1/4"-28.	14G, 4H.	2
1305-10	----		BEARING, STEERING POST (SEE GROUP 1305)		
0756-59	197417		PIN, SHAFT TO BRACKET 2 3/4" LONG	10G, 12G, H, 3H.	1
0756-63	530032		BRACKET, LOWER, SHAFT	10G, 12G, H, 3H.	1
0756-66	532065		KEY, WASHER 5/8" O.D.	10G, 12G, H, 3H.	1
	181614		GREASE FITTING, ALEMITE STRAIGHT - DRIVE BASE - LHC.	10G, 12G, H, 3H.	1
	732-02		GREASE FITTING, ALEMITE 67 1/2° ANGLE 1/8" THREAD - RHC.	10G, 12G, H, 3H.	1
0756-70	526020		CLAMP, SHAFT LOWER BRACKET.	10G, 12G, H, 3H.	1
0756-73	530958		SPACER, CLAMP.	10G, 12G, H, 3H.	1
	1-0428		SCREW, CLAMPING, TO BRACKET 1/4"-20X1 3/4".	10G, 12G, H, 3H.	2
	----		WASHER, LOCK 1/4".	10G, 12G, H, 3H.	2
0756-77	526052		SPRING, SHAFT AND LEVER	10G, 12G, H, 3H.	1
0756-77	532546		SPRING, SHAFT	14G, 4H.	1
0756-79	532547		RETAINER, SPRING	14G, 4H.	1
	441-0411		PIN, SPRING RETAINING 1/8"X11/16".	10G, 12G, H, 3H.	1
0756-82	532548		HOUSING, SHAFT SPRING	14G, 4H.	1
0756-86	530830X2		COVER, SHAFT AND LEVER - TENITE - LHC - NOTE 4	10G	1
0756-86	530830X2		COVER, SHAFT AND LEVER - TENITE - EXCEPT - WI-FI-CI-LHC	12G, H, 3H.	1
0756-89	197082		WASHER, UPPER, SHAFT - FELT	10G, H	1
0756-91	530749		SEAL, SHAFT LOWER - FELT - LHC - NOTE 4	10G	1
0756-91	530749		SEAL, SHAFT LOWER - FELT - EXCEPT WI-FI-CI-LHC.	12G, H, 3H.	1

- NOTES**
- ▲ - NOT AVAILABLE.
 - 3 - USED ON MODEL 10G CUSTOM SOUTH BEND | LOS ANGELES
BEFORE CAR SERIALS G-1,111,611 | G-907,301
 - 4 - USED ON MODEL 10G CUSTOM ON AND AFTER CAR SERIALS IN NOTE 3.
 - 6 - USED ON MODELS 14G | 4H
ON AND AFTER CAR SERIALS G-1,235,258 | 8,313,577
 - 7 - 1ST TYPE: IDENTIFIED BY PLAIN LEVER SUPPORT HOLE SOCKET OR BY
SHAFT WITH KEY WELDED INTERNALLY - SEE ILLUSTRATION.
 - 8 - 2ND TYPE: IDENTIFIED BY LETTER "A" UNDER LEVER SUPPORT HOLE
SOCKET OR BY SHAFT WITH KEY WELDED EXTERNALLY -
SEE ILLUSTRATION.

0759 TRANSMISSION - STANDARD AND OVERDRIVE

ILLUST. NUMBER	PART NUMBER	CHANGE	DESCRIPTION	MODELS	PER CAR
0759- GEARSHIFT CROSS SHIFT (Plates 07-5,6,7)					
0759-7	531076		LEVER AND SLEEVE, SECOND AND HIGH - LHC	10G, 12G	1
0759-7	530709		LEVER AND SLEEVE, SECOND AND HIGH - RHC	10G, 12G	1
0759-7	530406		LEVER AND SLEEVE, SECOND AND HIGH - LHC	H, 3H.	1
0759-7	530889		LEVER AND SLEEVE, SECOND AND HIGH - RHC	H, 3H.	1
0759-7	532553P		LEVER, SECOND AND HIGH (LESS POWER STEER)	14G, 4H.	1
0759-7	533275P		LEVER, SECOND AND HIGH (W/POWER STEER).	14G, 4H.	1
0759-11	527736		PIN, LOCATING 1/8"X1 1/8".	10G, 12G, H, 3H.	1
0759-16	530461		LEVER AND SLEEVE, LOW AND REVERSE - LHC	10G, 12G	1
0759-16	530707		LEVER AND SLEEVE, LOW AND REVERSE - RHC	10G, 12G	1
0759-16	530408		LEVER AND SLEEVE, LOW AND REVERSE - LHC	H, 3H.	1
0759-16	530891		LEVER AND SLEEVE, LOW AND REVERSE - RHC	H, 3H.	1
0759-16	532879		LEVER W/GREASE FITTING, LOW AND REVERSE (LESS POWER STEER).	14G, 4H.	1
0759-16	533328		LEVER W/GREASE FITTING, LOW AND REVERSE (W/POWER STEER)	14G, 4H.	1
0759-11	527736		PIN, LOCATING 1/8"X1 1/8".	10G, 12G, H, 3H.	1
	718-04		GREASE FITTING, LOW AND REVERSE LEVER.	14G, 4H.	1
0759-19	532554		SPACER, SHIFT LEVERS.	14G, 4H.	1
0760- GEARSHIFT RODS (Plates 07-5,6,7)					
0760-1	531081		ROD, LOW AND REVERSE - LHC.	10G, 12G	1
0760-1	530734	●	ROD, LOW AND REVERSE - RHC.	10G, 12G	1
0760-1	533005		ROD, LOW AND REVERSE -EXCEPT C-K-LHC (LESS POWER STEER)	14G	1
0760-1	534366		ROD, LOW AND REVERSE -EXCEPT C-K-LHC (W/POWER STEER)	14G	1
0760-1	533748	●	ROD, LOW AND REVERSE -EXCEPT C-K-RHC.	14G	1
0760-1	532966		ROD, LOW AND REVERSE -C-K-LHC (LESS POWER STEER).	14G	1
0760-1	534340		ROD, LOW AND REVERSE -C-K-LHC (W/POWER STEER)	14G	1
0760-1	530360		ROD, LOW AND REVERSE - LHC.	H, 3H.	1
0760-1	530896	●	ROD, LOW AND REVERSE - RHC.	H, 3H.	1
0760-1	532963		ROD, LOW AND REVERSE -EXCEPT C-K-LHC } LESS POWER STEER	4H.	1
0760-1	532003		ROD, LOW AND REVERSE -C-K-LHC	4H.	1
0760-1	534392		ROD, LOW AND REVERSE -EXCEPT C-K-LHC-NOTE 6 } W/POWER STEER	4H.	1
0760-1	534405		ROD, LOW AND REVERSE -C-K-LHC-NOTE 6.	4H.	1
0760-1	533748	●	ROD, LOW AND REVERSE -EXCEPT C-K-RHC.	4H.	1
0760-4	531079		ROD, SECOND AND HIGH - LHC.	10G, 12G	1
0760-4	530736	●	ROD, SECOND AND HIGH - RHC.	10G, 12G	1
0760-4	532970		ROD, SECOND AND HIGH -EXCEPT C-K-LHC (LESS POWER STEER)	14G	1
0760-4	534362		ROD, SECOND AND HIGH -EXCEPT C-K-LHC (W/POWER STEER).	14G	1
0760-4	533746	●	ROD, SECOND AND HIGH -EXCEPT C-K-RHC.	14G	1
0760-4	532988		ROD, SECOND AND HIGH -C-K-LHC (LESS POWER STEER).	14G	1
0760-4	534352		ROD, SECOND AND HIGH -C-K-LHC (W/POWER STEER)	14G	1
0760-4	530362		ROD, SECOND AND HIGH - LHC.	H, 3H.	1
0760-4	530894	●	ROD, SECOND AND HIGH - RHC.	H, 3H.	1
0760-4	532961		ROD, SECOND AND HIGH -EXCEPT C-K-LHC } LESS POWER STEER	4H.	1
0760-4	532986		ROD, SECOND AND HIGH -C-K-LHC	4H.	1
0760-4	534406		ROD, SECOND AND HIGH -EXCEPT C-K-LHC-NOTE 6 } W/POWER STEER	4H.	1
0760-4	534401		ROD, SECOND AND HIGH -C-K-LHC-NOTE 6.	4H.	1
0760-4	533746	●	ROD, SECOND AND HIGH -EXCEPT C-K-RHC.	4H.	1
0760-5A	196333		CLAMP, LOW AND REVERSE ROD -LHC - BEFORE } G-1,034,008	10G	1
0760-5B	1902X15		CLIP, LOW AND REVERSE ROD -LHC - AFTER	10G	1
0760-5A	196333		CLAMP, LOW AND REVERSE ROD -LHC.	12G	1
0760-5B	1902X15		CLIP, LOW AND REVERSE ROD -LHC.	H, 3H.	1
0760-5A	196333		CLAMP, SECOND AND HIGH ROD -LHC - BEFORE } G-1,066,936	10G	1
0760-5C	1903X15		CLIP, SECOND AND HIGH ROD -LHC - AFTER	10G	1
0760-5A	196333		CLAMP, SECOND AND HIGH ROD -LHC.	12G	1
0760-5	196333		CLAMP, ROD -EXCEPT C-K-LHC (LESS POWER STEER).	14G, 4H.	2
0760-5	196333		CLAMP, ROD -C-K-LHC (W/POWER STEER).	14G	2
0760-5	196333		CLAMP, LOW AND REVERSE -C-K (W/POWER STEER) NOTE 6	4H.	1
0760-6	192057		WASHER, SECOND AND HIGH SPRING -LHC.	H, 3H.	1
0760-6	192057		WASHER, SPRING -RHC.	10G, 12G, H, 3H.	2
0760-6	192057		WASHER, SPRING -EXCEPT C-K-LHC (W/POWER STEER)	14G, 4H.	2
0760-6	192057		WASHER, SPRING -EXCEPT C-K-RHC	14G, 4H.	2

● - ILLUSTRATED IN GROUP 0761.

NOTE { 6 - USED ON MODELS 14G 4H
ON AND AFTER CAR SERIALS G-1,235,258 8,313,577

TRANSMISSION - STANDARD AND OVERDRIVE 0760

ILLUST. NUMBER	PART NUMBER	CHANGE	DESCRIPTION	MODELS	PER CAR
0760- GEARSHIFT RODS-Cont'd. (Plates 07-5,6,7)					
0760-6	192057		WASHER, SPRING -C-K (LESS POWER STEER)	14G	2
0760-6	192057		WASHER, SPRING -C-K (LESS POWER STEER)	4H	2
0769-6	192057		WASHER, SECOND AND HIGH SPRING -C-K (W/POWER STEER)		
			NOTE 6	4H	1
	----		WASHER, PLAIN (USE WITH 192057)	10G, 12G, 14G, H, 3H, 4H	2
	----		COTTER 3/32"x1"	10G, 12G, 14G, H, 3H, 4H	2
0760-8	197219		CLEVIS, GEARSHIFT ROD - LHC	10G, 12G, 14G, H, 3H, 4H	2
0760-8	519533		CLEVIS, GEARSHIFT ROD - RHC	10G, 12G	2
0760-9	252-06		NUT, LOCK 3/8"-24.	10G, 12G, 14G, H, 3H, 4H	2
	438-0519		PIN, CLEVIS 5/16"x1-3/16" - LHC.	10G, 12G, 14G, H, 3H, 4H	2
	438-0614		PIN, CLEVIS 3/8"x23/32" - RHC.	10G, 12G	2
	184291		WASHER, SPRING 21/64" - LHC.	10G, 12G, 14G, H, 3H, 4H	2
0760-6	192057		WASHER, SPRING 25/64" - RHC.	10G, 12G, H, 3H	2
	----		COTTER, 3/32"x1"	10G, 12G, 14G, H, 3H, 4H	2
0760-11	530897		SWIVEL, GEARSHIFT ROD - RHC (ILLUST. GROUP 0761)	H, 3H	2
0760-11	533749		SWIVEL, GEARSHIFT ROD - RHC (ILLUST. GROUP 0761)	14G, 4H	2
	252-06		NUT, LOCK 3/8"-24.	H, 3H	2
	252-06		NUT, LOCK 3/8"-24.	14G, 4H	4
0760-6	192057		WASHER, SPRING 25/64"	14G, H, 3H, 4H	2
	----		WASHER, PLAIN 3/8"	14G, H, 3H, 4H	2
	----		COTTER, 3/32"x1"	14G, H, 3H, 4H	2
0760-12	525670		ROD AND CLEVIS, GEARSHIFT - RHC (CROSS SHAFT TO TRANS) (ILLUST. GROUP 0761)	10G, 12G, 14G, H, 3H	2
0760-12	533400		ROD AND CLEVIS, GEARSHIFT - EXCEPT C-K-RHC (CROSS SHAFT TO TRANS.) (ILLUST. GROUP 0761)	4H	2
	438-0512		PIN, CLEVIS 5/16"x3/4"	10G, 12G, 14G, H, 3H, 4H	4
0760-10	184291		WASHER, SPRING 21/64"	10G, 12G, 14G, H, 3H, 4H	4
	----		COTTER, 3/32"x1"	10G, 12G, 14G, H, 3H, 4H	4

NOTE { 6 - USED ON MODELS 14G 4H
ON AND AFTER CAR SERIALS G-1, 235, 258 | 8, 313, 577

0761 TRANSMISSION - STANDARD AND OVERDRIVE

ILLUST. NUMBER	PART NUMBER	CHANGE	DESCRIPTION	MODELS	PER CAR
----------------	-------------	--------	-------------	--------	---------

0761- GEARSHIFT CROSS SHAFT-RHC

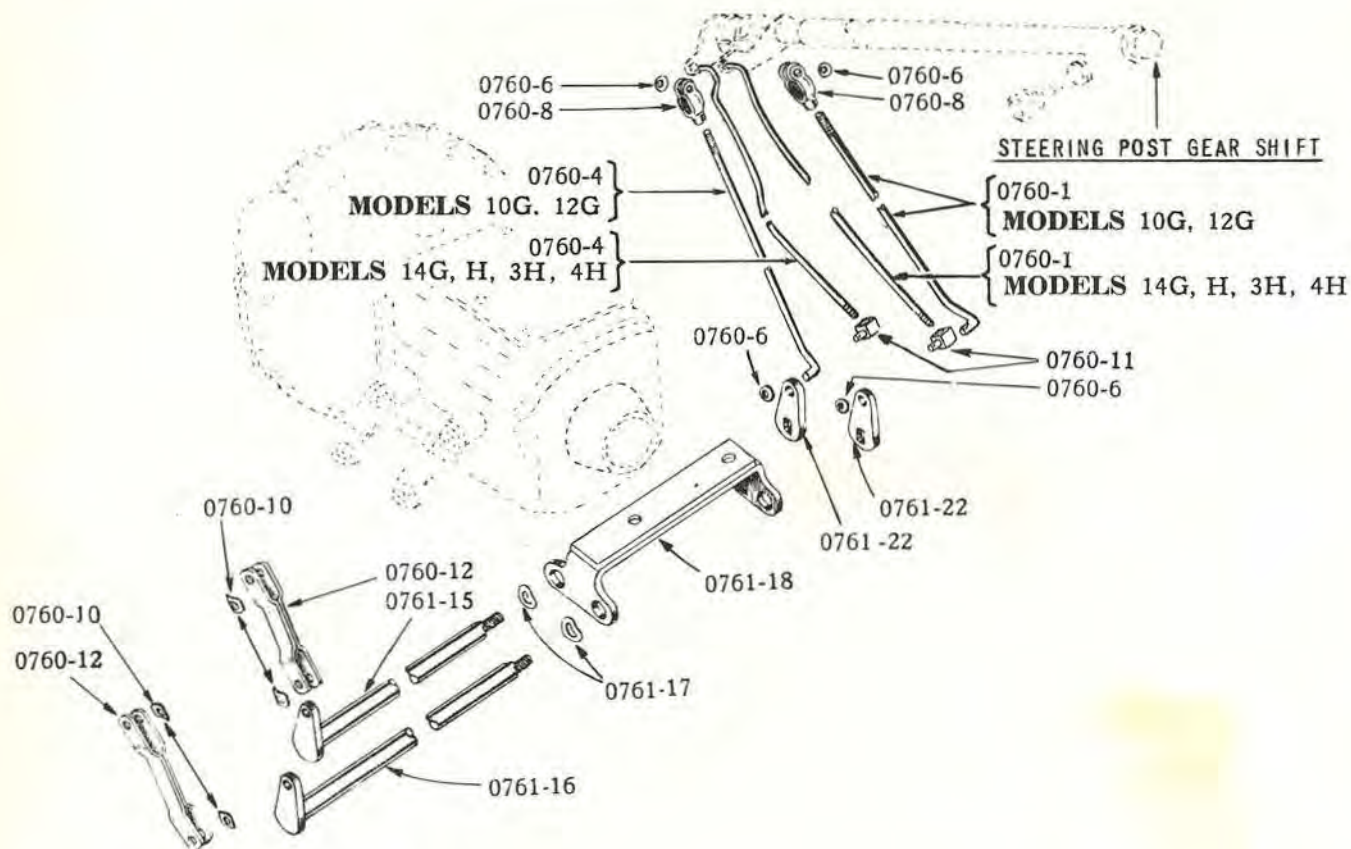

0761-15	521045	CROSS SHAFT AND LEVER. SECOND AND HIGH.	10G, 12G, H, 3H.	1
0761-15	533381	CROSS SHAFT AND LEVER. SECOND AND HIGH.	14G, 4H.	1
0761-16	521046	CROSS SHAFT AND LEVER. LOW AND REVERSE.	10G, 12G.	1
0761-16	530899	CROSS SHAFT AND LEVER. LOW AND REVERSE.	H, 3H.	1
0761-16	533382	CROSS SHAFT AND LEVER. LOW AND REVERSE.	14G, 4H.	1
0761-17	194726	WASHER, SPRING 21/32".	10G, 12G, 14G, H, 3H, 4H	2
	----	COTTER, LOCATING 1/8"X1-1/4"	10G, 12G, 14G, H, 3H, 4H	4
0761-18	524688	BRACKET, CROSS SHAFT.	10G, 12G, 14G, H, 3H, 4H	1
	518343	SPACER, TO TRANS. -EXCEPT C-K	4H.	2
	1-0616	SCREW, TO TRANS. 3/8"-16X1".	10G, 12G, H, 3H.	2
	1-0620	SCREW, TO TRANS. 3/8"-16X1 1/4".	14G.	2
	----	SCREW, TO TRANS. 3/8"-16X1 3/4" -EXCEPT C-K	4H.	2
	1-0620	SCREW, TO TRANS. 3/8"-16X1 1/4" -C-K	4H.	2
	380-06	WASHER, LOCK 3/8"	10G, 12G, 14G, H, 3H, 4H	2
0761-22	521022	LEVER, CROSS SHAFT.	10G, 12G, H, 3H.	2
0761-22	533386	LEVER, CROSS SHAFT.	14G, 4H.	2
	251-05	NUT, LEVER TO SHAFT 5/16".	10G, 12G, 14G, H, 3H, 4H	2
	361-05	WASHER, PLAIN 5/16"	10G, 12G, 14G, H, 3H, 4H	2
	380-05	WASHER, LOCK 5/16".	10G, 12G, 14G, H, 3H, 4H	2