

FUEL SYSTEM - Models 14G, 4H

FUEL SYSTEM

Plate 03-3

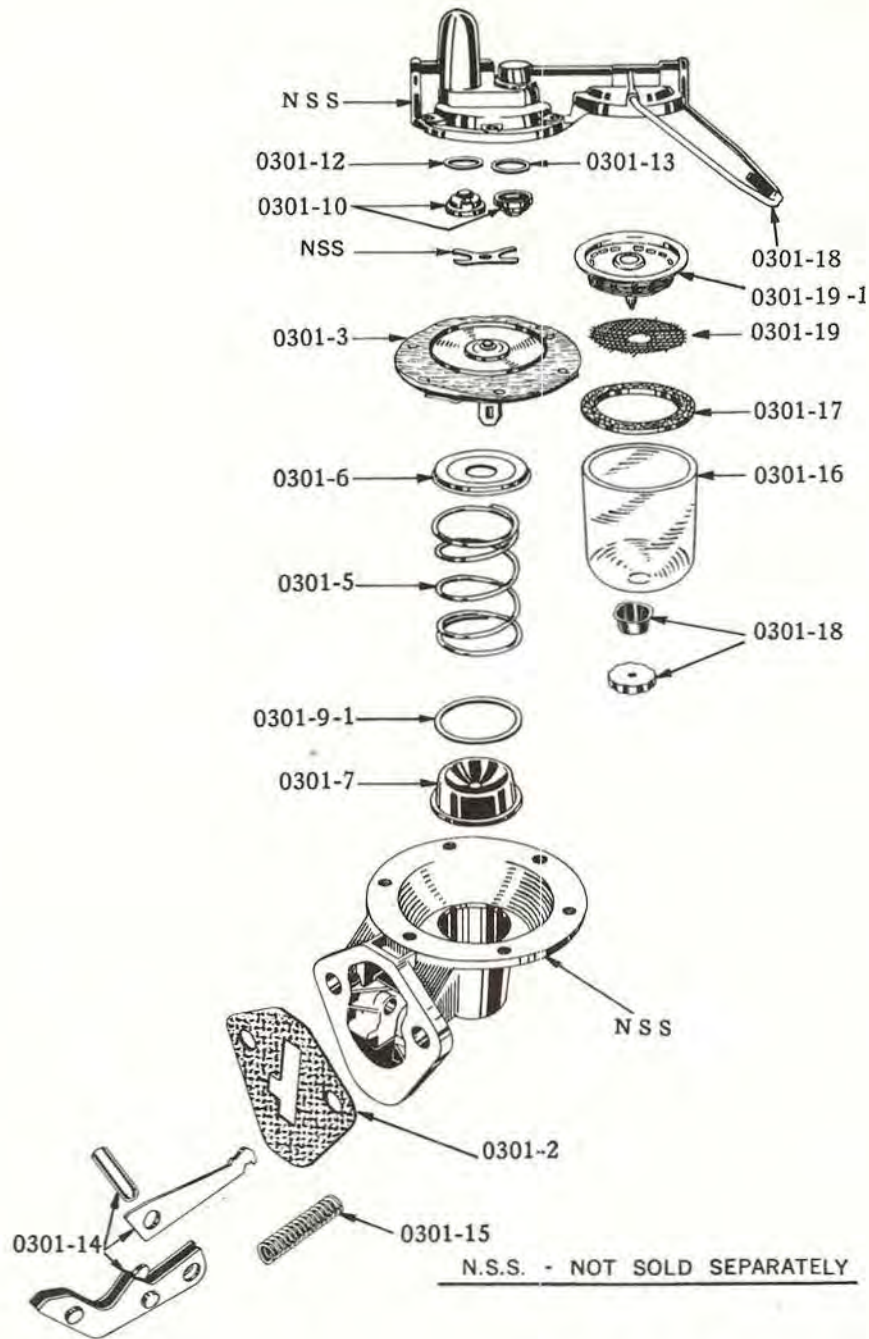

FUEL PUMP

Plate 03-4

FUEL SYSTEM

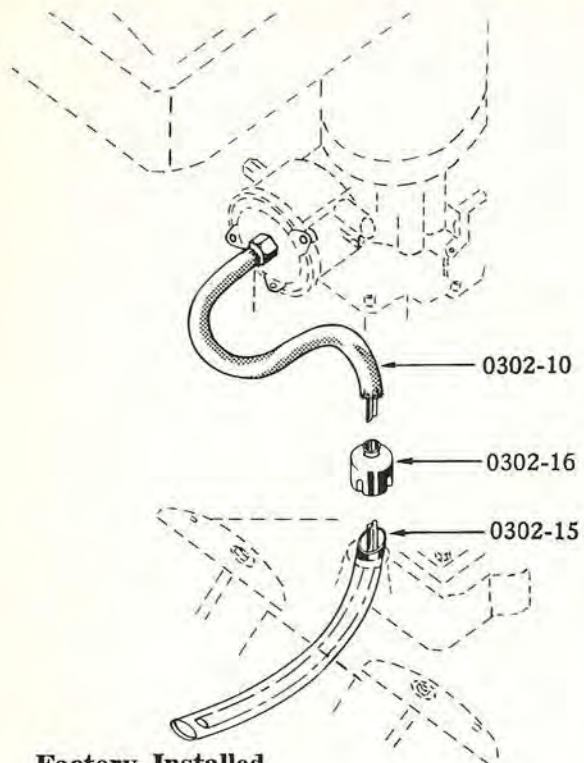

Factory Installed

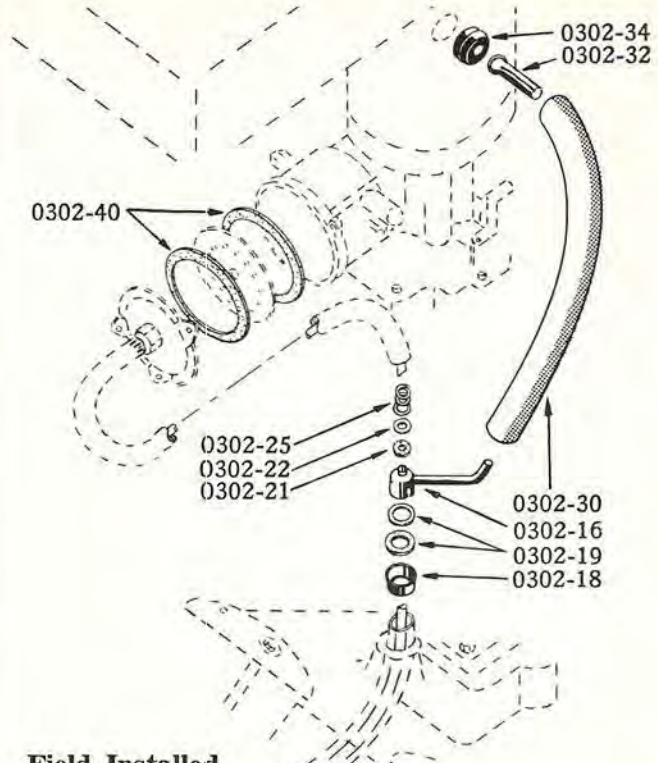

Field Installed

MODELS H and 3H from Engine No. U. S. A. V-95, 954 to V-172, 611
MODEL 3H before engine No. Canada VC-3,104

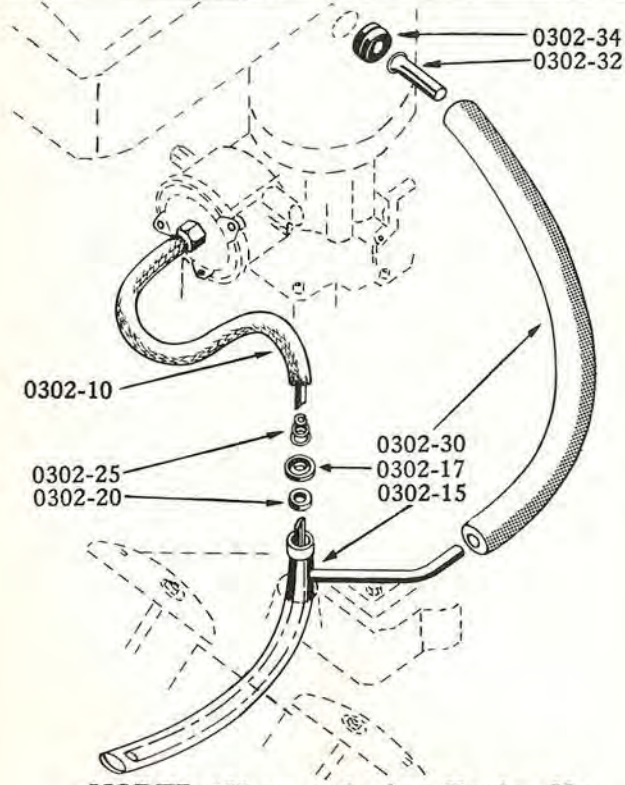

MODEL 3H on and after Engine No. U. S. A. V-172, 611 and Canada VC-3,104

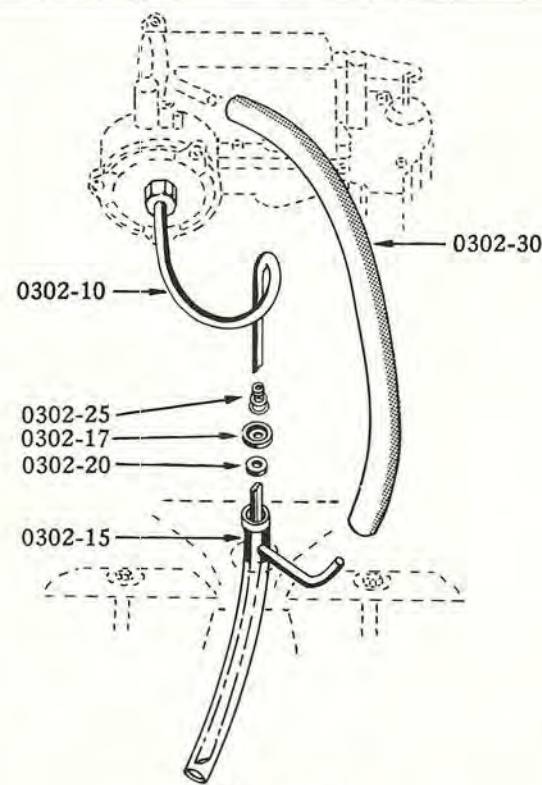

MODEL 4H

AUTOMATIC CHOKE PIPES AND FITTINGS
Models H, 3H, 4H

FUEL SYSTEM

Plate 03-9

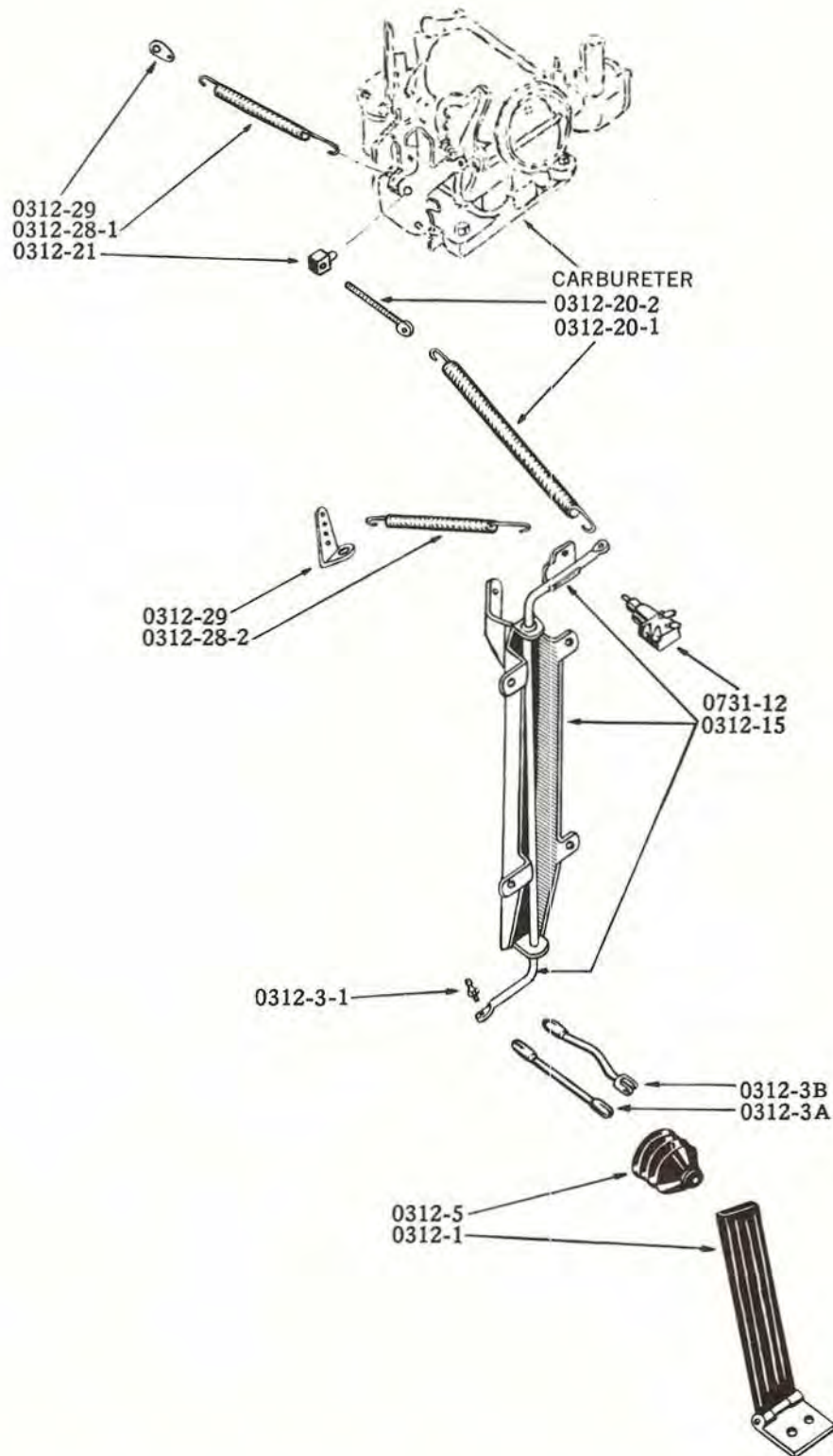

ACCELERATOR CONTROLS - Model 4H Used with Standard and Overdrive Transmissions

Plate 03-10

FUEL SYSTEM

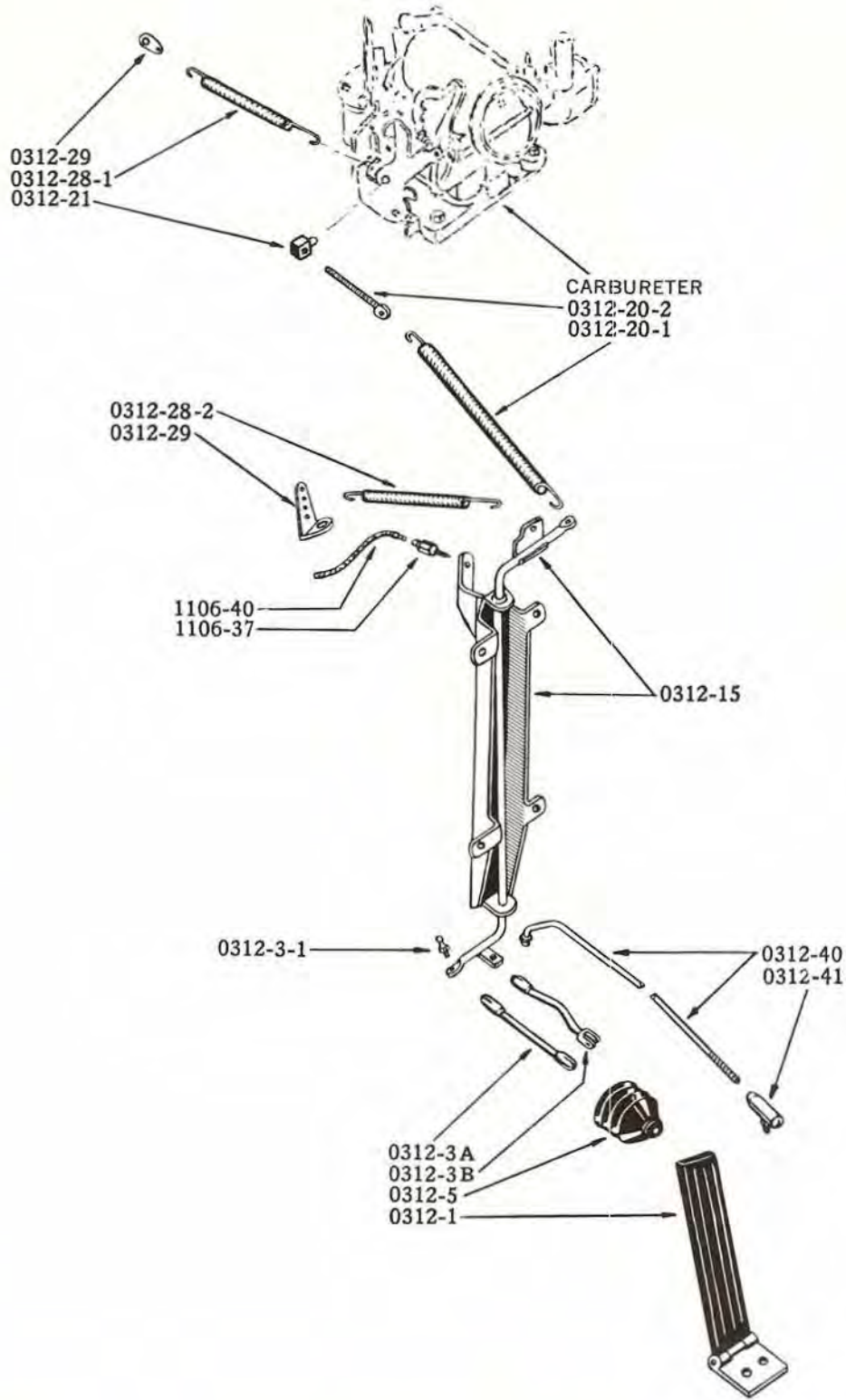

ACCELERATOR CONTROLS - Model 4H
Used with Automatic Transmission

FUEL SYSTEM

0301

| ILLUST. NUMBER | PART NUMBER | CHANGE | DESCRIPTION | MODELS | PER CAR |
|--|-------------|--------|---|--------------------------|---------|
| 0301- FUEL PUMP (Plates 03-1, 2, 3) | | | | | |
| 0301-1 | 679074 | | FUEL PUMP, ASSEMBLY | 10G, 12G | 1 |
| 0301-1 | 681107 | | FUEL PUMP, ASSEMBLY | 14G | 1 |
| 0301-1 | 527190 | | FUEL PUMP, ASSEMBLY - NOTE 1. | H | 1 |
| 0301-1 | 531218 | | FUEL PUMP, ASSEMBLY - NOTE 2. | H, 3H, 4H | 1 |
| | 1-0512 | | -SCREW, TO BLOCK 5/16"-18X3/4". | 10G, 12G, 14G | 2 |
| | 2-0540 | | BOLT, TO SUPPORT 5/16"-24X2-1/2". | H, 3H, 4H | 2 |
| | 252-05 | | NUT, HEX, 5/16"-24. | H, 3H, 4H | 2 |
| | 380-05 | | -WASHER, LOCK 5/16". | 10G, 12G, 14G, H, 3H, 4H | 2 |
| | ---- | | SCREW, COVER TO BODY NO. 10-32X5/8". | 10G, 12G, 14G, H, 3H, 4H | 6 |
| | ---- | | WASHER, LOCK NO. 10. | 10G, 12G, 14G, H, 3H, 4H | 6 |
| 0301-2 | 197389 | | GASKET, FUEL PUMP | 10G, 12G, 14G, H, 3H, 4H | 1 |
| 0301-2-1 | 529122 | | SUPPORT, FUEL PUMP (ILLUST. PLATE 01-5) NOTE 3. | H | 1 |
| 0301-2-1 | 531650 | | SUPPORT, FUEL PUMP (ILLUST. PLATE 01-5) NOTE 4. | H, 3H, 4H | 1 |
| | 547-02 | | PLUG, SUPPORT. | H, 3H, 4H | 1 |
| | 1-0516 | | SCREW, TO BLOCK 5/16"-18X1". | H, 3H, 4H | 2 |
| | 380-05 | | WASHER, LOCK 5/16". | H, 3H, 4H | 2 |
| 0301-2-2 | 527098 | | GASKET, FUEL PUMP SUPPORT (ILLUST. PLATE 01-5) NOTE 3 | H | 1 |
| 0301-2-2 | 531640 | | GASKET, FUEL PUMP SUPPORT (ILLUST. PLATE 01-5) NOTE 4 | H, 3H, 4H | 1 |
| 0301-2-3 | 529123 | | PUSH ROD, FUEL PUMP (ILLUST. PLATE 01-5). | H, 3H, 4H | 1 |
| | 526779 | | FUEL PUMP REPAIR KIT. | 10G, 12G | 1 |
| | 532461 | | FUEL PUMP REPAIR KIT. | 14G | 1 |
| | 531918 | | FUEL PUMP REPAIR KIT. | H, 3H, 4H | 1 |
| | S-774 | | DIAPHRAGM REPAIR KIT, FUEL PUMP | 10G, 12G, 14G | 1 |
| | S-776 | | DIAPHRAGM REPAIR KIT, FUEL PUMP | H, 3H, 4H | 1 |
| 0301-3 | ---- | | DIAPHRAGM AND LINK, FUEL PUMP (USE S-774 OR S-776 KIT). . . . | 10G, 12G, 14G, H, 3H, 4H | 1 |
| 0301-5 | 905948 | | SPRING, FUEL PUMP DIAPHRAGM | 10G, 12G, 14G, H, 3H, 4H | 1 |
| 0301-6 | 521113 | | RETAINER | 10G, 12G, 14G, H, 3H, 4H | 1 |
| 0301-7 | 187071 | | OIL SEAL, FUEL PUMP - RUBBER. | 10G, 12G, 14G, H, 3H, 4H | 1 |
| 0301-9-1 | 187072 | | SPACER | 10G, 12G, 14G, H, 3H, 4H | 1 |
| 0301-10 | ---- | | VALVE, FUEL PUMP (USE S-774 OR S-776 KIT) | 10G, 12G, 14G, H, 3H, 4H | 2 |
| 0301-12, 13 | ---- | | GASKET, FUEL PUMP VALVE (USE S-774 OR S-776 KIT). | 10G, 12G, 14G, H, 3H, 4H | 2 |
| | 532462 | | PIN AND SEAL KIT, ROCKER ARM. | 10G, 12G, 14G, H, 3H, 4H | 1 |
| 0301-14 | ---- | | ● ARM, LINK AND PIN, FUEL PUMP ROCKER | 10G, 12G, 14G, H, 3H, 4H | 1 |
| 0301-15 | 189631 | | SPRING, FUEL PUMP ROCKER ARM. | 10G, 12G, 14G, H, 3H, 4H | 1 |
| 0301-16 | 524634 | | BOWL W/GASKET, FUEL PUMP. | 10G, 12G, 14G, H, 3H, 4H | 1 |
| 0301-17 | 150948 | | GASKET, FUEL PUMP BOWL. | 10G, 12G, 14G, H, 3H, 4H | 1 |
| 0301-18 | ---- | | ● BAIL, NUT AND SEAT, FUEL PUMP BOWL | 10G, 12G, 14G, H, 3H, 4H | 1 |
| | | | ● ORDER FROM UNITED MOTORS SERVICE. | | |

- NOTES {
- 1 - USED ON MODEL H BEFORE ENGINE NO. V-35,390.
 - 2 - USED ON AND AFTER ENGINE NO. IN NOTE 1.
 - 3 - USED ON MODEL H BEFORE ENGINE NO. V-96,218
 - 4 - USED ON AND AFTER ENGINE NO. IN NOTE 3.

0301

FUEL SYSTEM

| ILLUST. NUMBER | PART NUMBER | CHANGE | DESCRIPTION | MODELS | PER CAR |
|---|-------------|--------|--|---------------------------|---------|
| 0301- FUEL PUMP-Cont'd. (Plates 03-1,2,3) | | | | | |
| 0301-19 | 185389 | | SCREEN, FUEL PUMP BOWL - NOTE 1 | 10G,12G,14G,H | 1 |
| 0301-19-1 | 531219 | | STRAINER, FUEL PUMP BOWL - NOTE 2 | H,3H,4H | 1 |
| | 533145 | | GASKET, STRAINER. | H,3H,4H | 1 |
| 0301-20 | 527874 | | SHIELD, FUEL PUMP (ILLUST. PLATE 01-1). | 10G,12G,14G | 1 |
| | 522242 | | STUD, THRU PUMP COVER - SPECIAL. | 10G,12G,14G | 3 |
| | 280-#10 | | NUT, HEX. NO.10-32. | 10G,12G,14G | 3 |
| | ---- | | WASHER, LOCK NO.10. | 10G,12G,14G | 3 |
| 0301-25 | 530880 | | PIPE W/NUTS, FUEL PUMP LUBRICATION (ILLUST. PLATE 01-5) | H,3H,4H | 1 |
| | 515-03 | | NUT, PIPE 3/16". | H,3H,4H | 2 |
| | 530918 | | NIPPLE, FUEL PUMP LUBRICATION PIPE - PUMP END | H,3H,4H | 1 |
| | 520-03 | | ELBOW, FUEL PUMP LUBRICATION PIPE - CYL. END (LESS OIL FILTER) | H,3H,4H | 1 |
| 0118-30 | 530844 | | ELBOW, FUEL PUMP LUBRICATION PIPE - CYL. END (WITH OIL FILTER) (ILLUST. PLATE 01-5) | H,3H,4H | 1 |
| 0302- CARBURETER AND AUTOMATIC CHOKE (Plates 01-1,2, 03-1,2,4) | | | | | |
| CARBURETER | | | | | |
| 0302-1 | 525669 | | CARBURETER - CARTER MODEL WE-715S | 10G,12G | 1 |
| 0302-1 | 532496 | | CARBURETER - CARTER MODEL WE-989SA. | 14G | 1 |
| 0302-1 | 530452 | | CARBURETER - STROMBERG MODEL AAUVB-26 (TYPE 6-107A) NOTE 5 | } U.S.A. H | 1 |
| 0302-1 | 531495 | | CARBURETER - STROMBERG MODEL AAUVB-26 (TYPE 6-111) NOTE 6 | | |
| 0302-1 | 530452 | | CARBURETER - STROMBERG MODEL AAUVB-26 (TYPE 6-107A) | } CANADA H,3H. | 1 |
| 0302-1 | 531495 | | CARBURETER - STROMBERG MODEL AAUVB-26 (TYPE 6-111) | | |
| 0302-1 | 532428 | | CARBURETER - STROMBERG MODEL WWUVL.26 | 4H. | 1 |
| | 203-0624 | | STUD, TO MANIFOLD 3/8"-16-24X1 1/2". | 10G,12G,14G | 2 |
| | 254-06 | | NUT, HEX. 3/8"-24 | 10G,12G,14G | 2 |
| | 384-06 | | WASHER, SH'PRF. 3/8". | 10G,12G,14G | 2 |
| | 203-0522 | | STUD, TO MANIFOLD 5/16"-18-24X1 3/8" | H,3H,4H | 4 |
| | 254-05 | | NUT, HEX. 5/16"-24. | H,3H,4H | 4 |
| | 384-05 | | WASHER, SH'PRF. 5/16". | H,3H,4H | 4 |
| 0302-2 | 522070 | | GASKET, CARBURETER TO MANIFOLD. | 10G,12G | 1 |
| 0302-2 | 532733 | | GASKET, CARBURETER TO MANIFOLD. | 14G | 1 |
| 0302-2 | 177979 | | GASKET, CARBURETER TO MANIFOLD. | H,3H,4H | 1 |
| | 533820 | | CHECK, THROTTLE RETURN (WITH AD) NOTE 7 | 4H. | 1 |
| AUTOMATIC CHOKE PIPES AND FITTINGS | | | | | |
| | 532365 | | HEATER TUBE KIT, AUTOMATIC CHOKE (ILLUST. PLATE 03-4) NOTE 8 - CONSISTS OF: | H,3H. | 1 |
| 0302-18 | | | 1-532350 - BASE, SHROUD | | |
| 0302-19 | | | 2-532358 - GASKET, SHROUD | | |
| 0302-16 | | | 1-532362 - SHROUD AND PIPE | | |
| 0302-21 | | | 1-532366 - SEAL, HEATER TUBE | | |
| 0302-22 | | | 1- ---- - WASHER, SEAL, 1/4" PLAIN | | |
| 0302-25 | | | 1-532360 - SPRING SEAL | | |
| 0302-30 | | | 1-959X7 1/2 - HOSE, HEATER TUBE | | |
| 0302-32 | | | 1-532368 - NIPPLE, HOSE | | |
| 0302-34 | | | 1-532367 - GROMMET, NIPPLE | | |
| 0302-40 | | | 2-532361 - GASKET, AUTO. CHOKE THERMOSTAT COVER | | |

- NOTES {
- 1 - USED ON MODEL H BEFORE ENGINE NO. V-35,390.
 - 2 - USED ON AND AFTER ENGINE NO. IN NOTE 1.
 - 7 - USED WITH AD ON AND AFTER ENGINE NO. V-215,580.
 - 8 - THIS KIT IS FOR CONVERTING AUTOMATIC CHOKE TO FILTERED AIR ON U.S.A. BUILT MODELS H AND 3H FROM ENGINE NO. V-95,954 TO V-172,611 AND CANADIAN BUILT MODEL 3H BEFORE ENGINE NO. VC-3,104.

FUEL SYSTEM

0302

| ILLUST. NUMBER | PART NUMBER | CHANGE | DESCRIPTION | MODELS | PER CAR |
|---|-------------|--------|--|--------------------------|---------|
| 0302- CARBURETER AND AUTOMATIC CHOKE-Cont'd. | | | | | |
| (Plates 01-1, 2, 03-1, 2, 4) | | | | | |
| AUTOMATIC CHOKE PIPES AND FITTINGS-Cont'd. | | | | | |
| 0302-10 | 515172 | | PIPE, AUTO. CHOKE TO MANIFOLD } ILLUST. | 10G, 12G | 1 |
| 0302-10 | 532533 | | PIPE, AUTO. CHOKE TO MANIFOLD } PLATE 01-1. | 14G | 1 |
| 0302-10 | 530559 | | PIPE, AUTO. CHOKE TO MANIFOLD (INCL. NUT AND LOOM). } U. S. A. | H | 1 |
| | | | NOTE 5. | | |
| 0302-10 | 531379 | | PIPE, AUTO. CHOKE TO MANIFOLD (INCL. NUT AND LOOM) } CANADA | H, 3H. | 1 |
| | | | NOTE 6. | | |
| 0302-10 | 530559 | | PIPE, AUTO. CHOKE TO MANIFOLD (INCL. NUT AND LOOM) | H | 1 |
| 0302-10 | 531379 | | PIPE, AUTO. CHOKE TO MANIFOLD (INCL. NUT AND LOOM) | 3H. | 1 |
| 0302-10 | 532569 | | PIPE, AUTO. CHOKE TO MANIFOLD (INCL. NUT) | 4H. | 1 |
| | ---- | | NUT, PIPE 1/4" | 10G, 12G, 14G, H, 3H, 4H | 1 |
| | ---- | | SLEEVE, PIPE 1/4". | 10G, 12G, 14G | 1 |
| 0109-7 | ---- | | PLUG, AUTO. CHOKE TUBE. } SEE GROUP 0109 | 10G, 12G | 1 |
| | ---- | | TUBE, AUTO. CHOKE HEATER (SERVICE) | 10G, 12G | 1 |
| 0302-15 | 532752 | ● | TUBE, AUTO. CHOKE HEATER (ILLUST. PLATE 01-1) | 14G | 1 |
| 0302-15 | 531359 | ● | TUBE, AUTO. CHOKE HEATER - NOTE 9 | H, 3H. | 1 |
| 0302-15 | 532420 | ● | TUBE, AUTO. CHOKE HEATER - NOTE 10 } ILLUST. PLATE 01-2 | 3H. | 1 |
| 0302-15 | 532571 | ● | TUBE, AUTO. CHOKE HEATER. | 4H. | 1 |
| | | ● | PRESS IN INLET MANIFOLD. | | |
| 0302-16 | 531361 | | SHROUD, AUTO. CHOKE TO MANIFOLD PIPE - NOTE 9 | H, 3H. | 1 |
| 0302-17 | 532418 | | COVER, AUTO. CHOKE HEATER TUBE - NOTE 10 | 3H, 4H | 1 |
| 0302-20 | 532366 | | SEAL, AUTO. CHOKE HEATER TUBE COVER - NOTE 10 | 3H, 4H | 1 |
| 0302-25 | 532360 | | SPRING, AUTO. CHOKE HEATER TUBE COVER - NOTE 10 | 3H, 4H | 1 |
| 0302-30 | 959X7 1/2 | | HOSE, AUTO. CHOKE HEATER TUBE - NOTE 10 | 3H, 4H | 1 |
| 0302-32 | 532368 | | NIPPLE, AUTO. CHOKE HEATER TUBE HOSE - NOTE 10 | 3H. | 1 |
| 0302-34 | 532367 | | GROMMET, NIPPLE - NOTE 10 | 3H. | 1 |

NOTES

- 5 - TYPE WITH HEATER PIPE ATTACHED TO EXHAUST MANIFOLD USED BEFORE ENGINE NO. V-95,954.
- 6 - TYPE WITH HEATER PIPE ATTACHED TO INLET MANIFOLD USED ON AND AFTER ENGINE NO. IN NOTE 5.
- 9 - TYPE WITHOUT FILTERED AIR FOR THE AUTOMATIC CHOKE AND THE HEATER PIPE ATTACHED TO THE INLET MANIFOLD USED ON U.S.A. BUILT MODELS H AND 3H FROM ENGINE NO. V-95,954 TO V-172,611 AND CANADIAN BUILT MODEL 3H BEFORE ENGINE NO. VC-3,104.
- 10 - TYPE WITH FILTERED AIR FOR THE AUTOMATIC CHOKE AND THE HEATER PIPE ATTACHED TO THE INLET MANIFOLD USED ON MODEL 3H ON AND AFTER ENGINE NO. U.S.A. V-172,611 AND CANADA VC-3,104.

FUEL SYSTEM

0302

| ILLUST. NUMBER | PART NUMBER | CHANGE | DESCRIPTION | MODELS | PER CAR |
|----------------|-------------|--------|-------------|--------|---------|
|----------------|-------------|--------|-------------|--------|---------|

STROMBERG (MODEL WUUVL-26) CARBURETOR PARTS-Model 4H

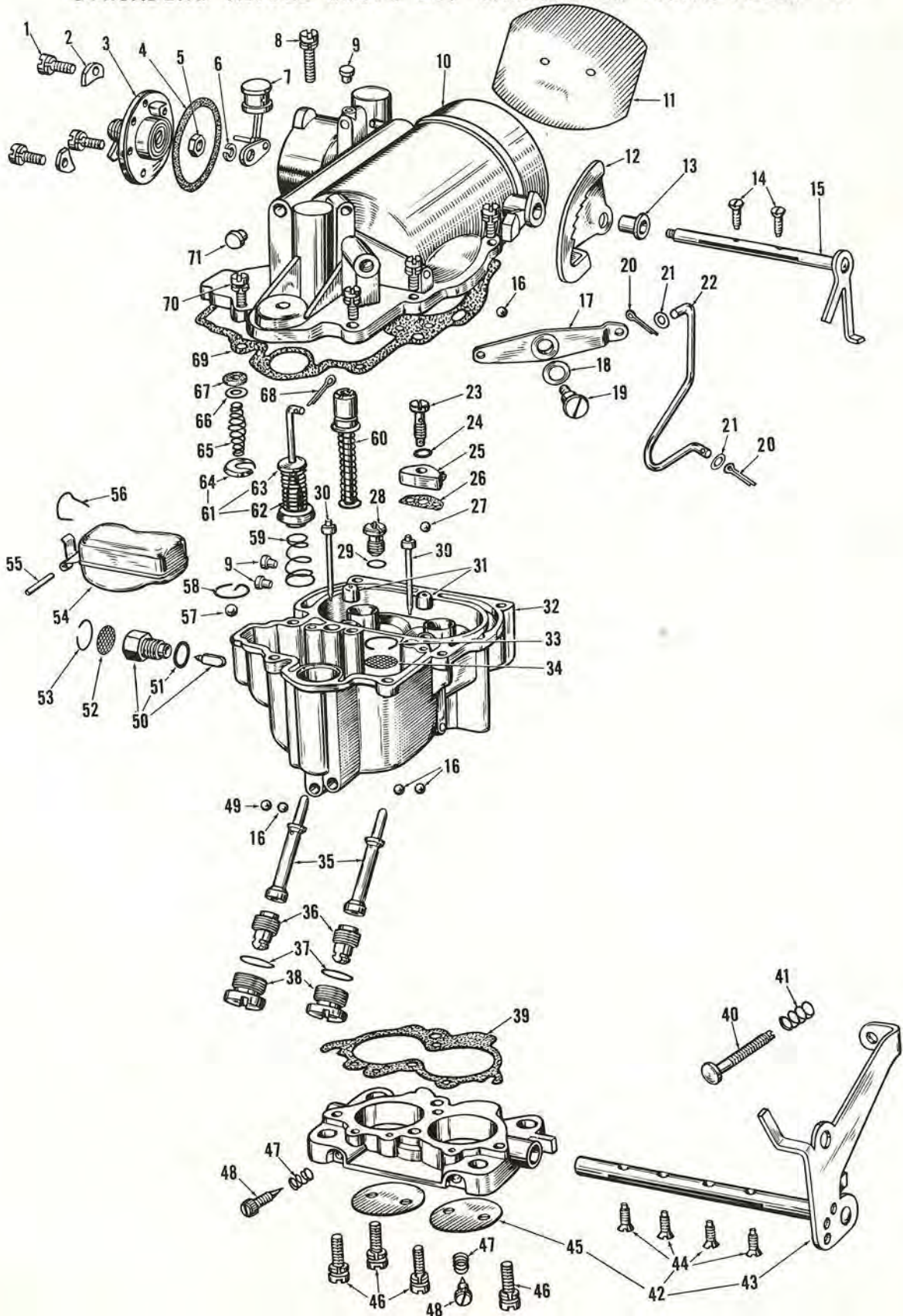

0302

FUEL SYSTEM

| ILLUST. NUMBER | PART NUMBER | CHANGE | DESCRIPTION | MODELS | PER CAR |
|--|----------------------|-----------------------|---|----------------------------|---------|
| STROMBERG (MODEL WWUVL-26) CARBURETER PARTS-Cont'd. | | | | | |
| | STROMBERG NO. | STUDEBAKER NO. | | | |
| | BS-RK-175 | 533631 | REPAIR KIT, CARBURETER - CONSISTS OF: | 4H. | 1 |
| | | | 7-BS-385937 -PLUG | 1-BS-P-21700-PLUG | |
| | | | 6-BS-P-18772-BALL | 1-BS-386369 -NEEDLE & SEAT | |
| | | | 3-BS-901207 -COTTER | 2-BS-385360-SCREEN | |
| | | | 1-BS-P-17063-GASKET | 2-BS-385355 CLIP | |
| | | | 1-BS-P-24668-GASKET | 1-BS-P-23273-SPRING | |
| | | | 1-BS-P-17030-BALL | 1-BS-P-22322-BALL | |
| | | | 1-BS-386418 -JET | 1-BS-386201 -CLIP | |
| | | | 1-BS-P-19448-GASKET | 1-BS-386186 -PISTON | |
| | | | 2-BS-386414 -TUBE | 1-BS-P-17380-PACKING | |
| | | | 2-BS-386272 -049 JET | 2-BS-386275 -GASKET | |
| | | | 2-BS-383079 -GASKET | 1-BS-386202 -GASKET | |
| | | | 1-BS-386204 -GASKET | 2-BS-386305 -PLUG | |
| | | | 2-BS-P-15478-VALVE | | |
| | BS-382362 | 533632 | GASKET SET, COMPLETE ASSORTMENT CONSISTS OF: . | 4H. | 1 |
| | | | 2-BS-386275 -GASKET | 1-BS-386204 -GASKET | |
| | | | 1-BS-P-17063-GASKET | 1-BS-P-10666-GASKET | |
| | | | 1-BS-P-24668-GASKET | 1-BS-386202 -GASKET | |
| | | | 1-BS-P-19448-GASKET | 1-BS-P-17380-PACKING | |
| | | | 2-BS-383079 -GASKET | 3-BS-901207 -COTTER | |
| 1 | BS-903900 | ---- | SCREW, THERMOSTAT COVER ATTACHING | 4H. | 3 |
| 2 | BS-P-23932 | 518217 | WASHER, LUG | 4H. | 3 |
| 3 | BS-386370 | 533621 | THERMOSTAT W/COVER. | 4H. | 1 |
| 4 | BS-386275 | 532361 | GASKET, THERMOSTAT COVER (INCL. IN RK-175 KIT, 382362 SET). | 4H. | 2 |
| 5 | BS-P-16571 | 518224 | NUT, VACUUM PISTON AND LINK ATTACHING | 4H. | 1 |
| 6 | BS-901046 | ---- | LOCKWASHER, VACUUM PISTON AND LINK ATTACHING NUT | 4H. | 1 |
| 7 | BS-386364 | 533601 | PISTON W/LINK AND LEVER, VACUUM | 4H. | 1 |
| 8 | BS-198-S-38 | ---- | SCREW AND LOCKWASHER, AIR HORN ATTACHING. | 4H. | 1 |
| 9 | BS-385937 | 533593 | PLUG, DRIVE (INCL. IN RK-175 KIT) | 4H. | 7 |
| 10 | BS-386300 | 533595 | AIR HORN. | 4H. | 1 |
| 11 | BS-386310 | 533602 | VALVE, CHOKE. | 4H. | 1 |
| 12 | BS-386304 | 533596 | CAM, FAST IDLE. | 4H. | 1 |
| 13 | BS-386303 | 533597 | BUSHING, CHOKE VALVE SHAFT. | 4H. | 1 |
| 14 | BS-P-20904 | 39201 | SCREW, CHOKE VALVE ATTACHING. | 4H. | 2 |
| 15 | BS-386307 | 533600 | SHAFT AND LEVER, CHOKE VALVE. | 4H. | 1 |
| 16 | BS-P-18772 | 518162 | BALL, LEAD (INCL. IN RK-175 KIT). | 4H. | 6 |
| 17 | BS-386179 | 533603 | LEVER, PUMP | 4H. | 1 |
| 18 | BS-P-19820 | 518649 | WASHER, PUMP FULCRUM SCREW. | 4H. | 1 |
| 19 | BS-P-20611 | 186134 | SCREW, PUMP FULCRUM | 4H. | 1 |
| 20 | BS-901207 | ---- | COTTER, PUMP ROD (INCL. IN RK-175 KIT, 382362 SET) | 4H. | 2 |
| 21 | BS-P-9394 | 131248 | WASHER, PUMP ROD. | 4H. | 2 |
| 22 | BS-386315 | 533613 | ROD, PUMP | 4H. | 1 |
| 23 | BS-385660 | 680757 | SCREW, PUMP NOZZLE ATTACHING. | 4H. | 1 |
| 24 | BS-P-17063 | 518703 | GASKET, PUMP NOZZLE ATTACHING SCREW (INCL. IN RK-175 KIT, 382362 SET) | 4H. | 1 |
| 25 | BS-386416 | 533457 | NOZZLE, PUMP. | 4H. | 1 |
| 26 | BS-P-24668 | 518698 | GASKET, PUMP NOZZLE (INCL. IN RK-175 KIT, 382362 SET) | 4H. | 1 |
| 27 | BS-P-17030 | 578702 | BALL, PUMP OUTLET CHECK VALVE (INCL. IN RK-175 KIT) | 4H. | 1 |
| 28 | BS-386418 | 531497 | JET, POWER BY-PASS NO. 60 (INCL. IN RK-175 KIT) | 4H. | 1 |
| 29 | BS-P-19448 | 186125 | GASKET, POWER BY-PASS JET (INCL. IN RK-175 KIT, 382362 SET). | 4H. | 1 |

FUEL SYSTEM

0302

| ILLUST. NUMBER | PART NUMBER | CHANGE | DESCRIPTION | MODELS | PER CAR |
|--|----------------|----------------|--|--------|---------|
| STROMBERG (MODEL WWUVL-26) CARBURETER PARTS-Cont'd. | | | | | |
| | STROMBERG NO. | STUDEBAKER NO. | | | |
| 30 | BS-386414 | 533607 | TUBE, IDLE (INCL. IN RK-175 KIT). | 4H. | 2 |
| 31 | BS-P-24315 | 533590 | BLEEDER, HIGH SPEED | 4H. | 2 |
| 32 | BS-386368 | 533617 | MAIN BODY | 4H. | 1 |
| 33 | BS-385355 | 680768 | CLIP, PUMP INLET SCREEN RETAINER (INCL. IN RK-175 KIT) | 4H. | 1 |
| 34 | BS-385360 | 680769 | SCREEN, PUMP INLET. | 4H. | 1 |
| 35 | BS-386207 | 533611 | JET, MAIN DISCHARGE | 4H. | 2 |
| 36 | BS-386272-.049 | 533401X1 | JET, MAIN METERING .049" (UP TO 4,000 FT.) (INCL. IN RK-175 KIT) | 4H. | 2 |
| 36 | BS-386272-.047 | 533401X2 | JET, MAIN METERING .047" (4,000 TO 8,000 FT.) | 4H. | 2 |
| 36 | BS-386272-.045 | 533401X3 | JET, MAIN METERING .045" (8,000 TO 12,000 FT.) | 4H. | 2 |
| 36 | BS-386272-.043 | 533401X4 | JET, MAIN METERING .043" (OVER 12,000 FT.) | 4H. | 2 |
| 37 | BS-383079 | 522036 | GASKET, METERING JET (INCL. IN RK-175 KIT, 382362 SET) | 4H. | 2 |
| 38 | BS-386210 | 533612 | PLUG, MAIN DISCHARGE JET. | 4H. | 2 |
| 39 | BS-386204 | 533610 | GASKET, MAIN BODY (INCL. IN RK-175 KIT, 382362 SET) | 4H. | 1 |
| 40 | BS-386341 | 533614 | SCREW, SLOW IDLE ADJUSTING. | 4H. | 1 |
| 41 | BS-386374 | 533616 | SPRING, SLOW IDLE ADJUSTING | 4H. | 1 |
| 42 | BS-386454 | 534040 | THROTTLE BODY | 4H. | 1 |
| 43 | BS-386452 | 534039 | LEVER AND SHAFT, THROTTLE | 4H. | 1 |
| 44 | BS-P-23956 | 518688 | SCREW, THROTTLE VALVE ATTACHING | 4H. | 4 |
| 45 | BS-385361 | 680761 | VALVE, THROTTLE | 4H. | 2 |
| 46 | BS-386049 | 533615 | SCREW AND LOCKWASHER, MAIN BODY ATTACHING | 4H. | 4 |
| 47 | BS-P-18710 | 179403 | SPRING, IDLE NEEDLE VALVE | 4H. | 2 |
| 48 | BS-P-15478 | 173246 | VALVE, IDLE NEEDLE (INCL. IN RK-175 KIT) | 4H. | 2 |
| 49 | BS-P-21700 | 518206 | BALL, LEAD (INCL. IN RK-175 KIT) | 4H. | 2 |
| 50 | BS-386369 | 533618 | VALVE AND SEAT, FLOAT (INCL. IN RK-175 KIT) | 4H. | 1 |
| 51 | BS-P-10666 | 179386 | GASKET, FLOAT VALVE AND SEAT (INCL. IN 382362 SET) | 4H. | 1 |
| 52 | BS-385360 | 680769 | SCREEN, FUEL INLET (INCL. IN RK-175 KIT) | 4H. | 1 |
| 53 | BS-385355 | 680768 | CLIP, FUEL INLET SCREEN RETAINER (INCL. IN RK-175 KIT) | 4H. | 1 |
| 54 | BS-386154 | 533594 | FLOAT AND LEVER | 4H. | 1 |
| 55 | BS-P-23272 | 518186 | PIN, FLOAT FULCRUM. | 4H. | 1 |
| 56 | BS-P-23273 | 518272 | SPRING, FLOAT FULCRUM PIN (INCL. IN RK-175 KIT) | 4H. | 1 |
| 57 | BS-P-22322 | 680749 | BALL, PUMP INLET CHECK VALVE (INCL. IN RK-175 KIT) | 4H. | 1 |
| 58 | BS-386201 | 533608 | CLIP, PUMP INLET CHECK VALVE BALL RETAINER (INCL. IN RK-175 KIT) | 4H. | 1 |
| 59 | BS-385623 | 531344 | SPRING, PUMP. | 4H. | 1 |
| 60 | BS-385346 | 531335 | PISTON, VACUUM POWER. | 4H. | 1 |
| 61 | BS-386186 | 533605 | PISTON, PUMP (INCL. IN RK-175 KIT) | 4H. | 1 |
| 62 | BS-386089 | 533606 | SPRING, PUMP DURATION | 4H. | 1 |
| 63 | BS-P-22046 | 518566 | WASHER, PUMP DURATION SPRING RETAINER. | 4H. | 1 |
| 64 | BS-P-22045 | 518565 | WASHER, PUMP DURATION SPRING CUP. | 4H. | 1 |
| 65 | BS-P-22643 | 518641 | SPRING, PACKING RETAINER. | 4H. | 1 |
| 66 | BS-P-17060 | 179400 | WASHER, PUMP LINK SEAL. | 4H. | 1 |
| 67 | BS-P-17380 | 179399 | PACKING, PUMP (INCL. IN RK-175 KIT, 382362 SET) | 4H. | 1 |
| 68 | BS-901207 | ---- | COTTER, PUMP LINK (INCL. IN RK-175 KIT, 382362 SET) | 4H. | 1 |
| 69 | BS-386202 | 533609 | GASKET, AIR HORN (INCL. IN RK-175 KIT, 382362 SET) | 4H. | 1 |
| 70 | BS-198-S-34 | ---- | SCREW AND LOCKWASHER, AIR HORN ATTACHING. | 4H. | 5 |
| 71 | BS-386305 | 533599 | PLUG, DRIVE (INCL. IN RK-175 KIT) | 4H. | 2 |
| | BS-383203 | 533591 | BLEEDER, IDLE AIR | 4H. | 2 |

0303

FUEL SYSTEM

| ILLUST. NUMBER | PART NUMBER | CHANGE | DESCRIPTION | MODELS | PER CAR |
|---|-------------|--------|---|-------------------------------------|---------|
| 0303- CARBURETER AIR CLEANER (Plates 01-1,2 and 03-1,2) | | | | | |
| | | | | TYPE CLEANER | |
| 0303-1 | 519861 | | AIR CLEANER, CARBURETER (LESS GOVERNOR) | DRY 10G,12G | 1 |
| 0303-1 | 533022 | | AIR CLEANER, CARBURETER | DRY 14G | 1 |
| 0303-1 | 526083 | | AIR CLEANER, CARBURETER (LESS GOVERNOR) | WET 10G | 1 |
| 0303-1 | 526084 | | AIR CLEANER, CARBURETER (WITH GOVERNOR) | WET 10G | 1 |
| 0303-1 | 531658 | | AIR CLEANER, CARBURETER (LESS GOVERNOR) | WET 12G | 1 |
| 0303-1 | 531702 | | AIR CLEANER, CARBURETER (WITH GOVERNOR) | WET 12G | 1 |
| 0303-1 | 533103 | | AIR CLEANER, CARBURETER | WET 14G | 1 |
| 0303-1 | 530576 | | AIR CLEANER, CARBURETER | DRY H,3H. | 1 |
| 0303-1 | 533023 | | AIR CLEANER, CARBURETER | DRY 4H. | 1 |
| 0303-1 | 530582 | | AIR CLEANER, CARBURETER | WET H | 1 |
| 0303-1 | 531657 | | AIR CLEANER, CARBURETER - NOTE 9. | WET 3H. | 1 |
| 0303-1 | 532458 | | AIR CLEANER, CARBURETER - NOTE 10 | WET 3H. | 1 |
| 0303-1 | 533096 | | AIR CLEANER, CARBURETER - EXCEPT C-K. | WET 4H. | 1 |
| 0303-1 | 533058 | | AIR CLEANER, CARBURETER - C-K | WET 4H. | 1 |
| | 530692 | | CLAMP, TO CARBURETER | DRY 10G,12G | 1 |
| | 530691 | | CLAMP, TO CARBURETER (FOR 526083). | WET 10G | 1 |
| | 530239 | | CLAMP W/STUD, TO CARBURETER (FOR 526084) | WET 10G | 1 |
| | 526038 | | STUD, CLAMP (FOR 530239). | 10G | 1 |
| | 251-04 | | NUT, CLAMP STUD 1/4"-20 | 10G. | 1 |
| | 1-0512 | | SCREW, TO SUPPORT 5/16"-18X3/4" | 10G,12G | 1 |
| | 367-05 | | WASHER, PLAIN 5/16" | 10G,12G | 1 |
| | 380-05 | | WASHER, LOCK 5/16" | 10G,12G | 1 |
| | 1-0512 | | SCREW, TO SUPPORT 5/16"-18X3/4" | 14G,4H. | 1 |
| | 380-05 | | WASHER, LOCK 5/16" | 14G,4H. | 1 |
| | 660980 | | GASKET, AIR CLEANER TO CARBURETER - FELT. | WET 10G,12G,14G | 1 |
| | 198360 | | GASKET, AIR CLEANER TO ELBOW. | DRY H,3H. | 1 |
| | 660981 | | GASKET, AIR CLEANER TO CARBURETER - FELT - NOTE 9 | WET H,3H. | 1 |
| | 532391 | | GASKET, AIR CLEANER TO CARBURETER - FELT - NOTE 10. | WET 3H,4H | 1 |
| | 533337 | | GASKET, AIR CLEANER TO CARBURETER - FELT. | DRY 14G | 1 |
| | 533339 | | GASKET, AIR CLEANER TO CARBURETER - FELT. | DRY 4H. | 1 |
| | 520452 | | SUPPORT, AIR CLEANER (FOR 526083) | WET 10G | 1 |
| | 521587 | | SUPPORT, AIR CLEANER (FOR 526084) | WET 10G | 1 |
| | 531659 | | SUPPORT, AIR CLEANER (FOR 531658) | WET 12G | 1 |
| | 533101 | | SUPPORT, AIR CLEANER. | DRY 14G | 1 |
| | 533117 | | SUPPORT, AIR CLEANER. | WET 14G | 1 |
| 0303-6 | 530679 | | SUPPORT, AIR CLEANER. | DRY H,3H. | 1 |
| | 530618 | | SUPPORT, AIR CLEANER (INCL. GROMMET). | WET H,3H. | 1 |
| | 533085 | | SUPPORT, AIR CLEANER - EXCEPT C-K | DRY 4H. | 1 |
| | 533084 | | SUPPORT, AIR CLEANER - C-K. | DRY 4H. | 1 |
| | 533083 | | SUPPORT, AIR CLEANER - EXCEPT C-K | WET 4H. | 1 |
| | 533970 | | SUPPORT, AIR CLEANER - C-K. | WET 4H. | 1 |
| | 530730 | | GROMMET, AIR CLEANER SUPPORT (FOR 530618) | H,3H. | 1 |
| | 530687 | | COVER, AIR CLEANER. | DRY 10G,12G | 1 |
| | 531938 | | COVER, AIR CLEANER. | DRY H,3H. | 1 |
| | 531933 | | COVER, AIR CLEANER. | WET 14G,H,3H,4H | 1 |
| | 533332 | | COVER, AIR CLEANER. | DRY 14G,4H. | 1 |
| | 195548 | | WING NUT, STUD NO. 10-32. | DRY 10G,12G | 1 |
| | 530680 | | WING STUD. | H | 1 |
| | 531656 | | WING STUD. | 3H. | 1 |
| | 533331 | | WING NUT, STUD NO. 10-32 | DRY 14G,4H. | 1 |
| | 660983 | | WING NUT, STUD 1/4"-20 | WET 14G,4H. | 1 |
| | 533333 | | GASKET, AIR CLEANER COVER - COMPOSITION | DRY 14G,4H. | 1 |
| | 530690 | | GASKET, AIR CLEANER COVER - RUBBER. | WET 14G,H,3H,4H | 1 |

NOTES { 9 - TYPE WITHOUT FILTERED AIR FOR THE AUTOMATIC CHOKE AND THE HEATER PIPE ATTACHED TO THE INLET MANIFOLD USED ON U.S.A. BUILT MODELS H AND 3H FROM ENGINE NO. V-95,954 TO V-172,611 AND CANADIAN BUILT MODEL 3H BEFORE ENGINE NO. VC-3,104.
 10 - TYPE WITH FILTERED AIR FOR THE AUTOMATIC CHOKE AND THE HEATER PIPE ATTACHED TO THE INLET MANIFOLD USED ON MODEL 3H ON AND AFTER ENGINE NO. U.S.A. V-172,611 AND CANADA VC-3,104.

FUEL SYSTEM

0305

| ILLUST. NUMBER | PART NUMBER | CHANGE | DESCRIPTION | MODELS | PER CAR |
|--|-------------|--------|--|--------------------------|---------|
| 0303- CARBURETER AIR CLEANER-Cont'd. (Plates 01-1,2 and 03-1,2) | | | | | |
| | | | TYPE CLEANER | | |
| | 530682 | | ELEMENT AND COVER, AIR CLEANER (FOR 526083) WET . | 10G | 1 |
| | 530684 | | ELEMENT AND COVER, AIR CLEANER (FOR 526084) WET . | 10G | 1 |
| | 531936 | | ELEMENT AND COVER, AIR CLEANER (FOR 531658) WET . | 12G | 1 |
| | 531937 | | ELEMENT AND COVER, AIR CLEANER (FOR 531702) WET . | 12G | 1 |
| | 531934 | | ELEMENT, AIR CLEANER. WET . | 14G, H, 3H, 4H | 1 |
| | 660983 | | WING NUT, STUD 1/4"-20 | 10G, 12G | 1 |
| | 530686 | | ELEMENT, AIR CLEANER. DRY . | 10G, 12G | 1 |
| | 531939 | | ELEMENT, AIR CLEANER. DRY . | H, 3H. | 1 |
| | 533334 | | ELEMENT, AIR CLEANER. DRY . | 14G, 4H. | 1 |
| | 530690 | | GASKET, AIR CLEANER ELEMENT - RUBBER. WET . | 10G, 12G | 1 |
| | 531935 | | GASKET, AIR CLEANER ELEMENT - CORK. WET . | 14G, H, 3H, 4H | 1 |
| | 533335 | | GASKET, AIR CLEANER ELEMENT - COMPOSITION DRY . | 14G, 4H. | 1 |
| 0303-9 | 530577 | | ELBOW, AIR CLEANER. DRY . | H | 1 |
| 0303-9 | 531655 | | ELBOW, AIR CLEANER - NOTE 9 DRY . | 3H. | 1 |
| 0303-9 | 532456 | | ELBOW, AIR CLEANER - NOTE 10. DRY . | 3H. | 1 |
| 0305- GOVERNOR | | | | | |
| | AC-1495 | | GOVERNOR AND AIR CLEANER KIT - HOOF - CONSISTS OF: | 10G | 1 |
| | | | 1-520464 GOVERNOR - HOOF MODEL H-20-16 | | |
| | | | 1-674853 GASKET, GOVERNOR | | |
| | | | 2-522525 STUD, GOVERNOR | | |
| | | | 1-522526 NUT, STUD | | |
| | | | 1-184032 SEAL AND WIRE | | |
| | | | 1-520472 EXTENSION, AUTO-CHOKE TO MANIFOLD PIPE | | |
| | | | 1-520471 EXTENSION, FUEL PUMP TO CARBURETER | | |
| | | | 1-520153 PIPE W/NUTS, GOVERNOR TO CARBURETER | | |
| | | | 2-520-03 ELBOW, GOVERNOR AND MODIFIER PIPE | | |
| | | | 1-526084 AIR CLEANER, CARBURETER | | |
| | | | 1-521587 SUPPORT, AIR CLEANER | | |
| | | | 1-1-0512 SCREW, AIR CLEANER TO SUPPORT | | |
| | | | 1-380-05 WASHER, LOCK | | |
| | | | 1-367-05 WASHER, PLAIN | | |
| | AC-2194 | | GOVERNOR AND AIR CLEANER KIT - HOOF - CONSISTS OF: | 12G | 1 |
| | | | 1-520464 GOVERNOR - HOOF MODEL H-20-16 | | |
| | | | 1-674853 GASKET, GOVERNOR | | |
| | | | 2-522525 STUD, GOVERNOR | | |
| | | | 1-522526 NUT, STUD | | |
| | | | 1-184032 SEAL AND WIRE | | |
| | | | 1-520472 EXTENSION, AUTO-CHOKE TO MANIFOLD PIPE | | |
| | | | 1-520471 EXTENSION, FUEL PUMP TO CARBURETER | | |
| | | | 1-520153 PIPE W/NUTS, GOVERNOR TO CARBURETER | | |
| | | | 2-520-03 ELBOW, GOVERNOR AND MODIFIER PIPE | | |
| | | | 1-531702 AIR CLEANER, CARBURETER | | |
| | 520464 | | GOVERNOR - HOOF MODEL H-20-16. | 10G, 12G | 1 |
| | 522525 | | STUD, TO MANIFOLD 3/8"-16-24X3" } INCL. IN | 10G, 12G | 2 |
| | 522526 | | NUT, HEX. 3/8"-24. } GOVERNOR KITS. | 10G, 12G | 1 |

NOTES { 9 - TYPE WITHOUT FILTERED AIR FOR THE AUTOMATIC CHOKE AND THE HEATER PIPE ATTACHED TO THE INLET MANIFOLD USED ON U.S.A. BUILT MODELS H AND 3H FROM ENGINE NO. V-95,954 TO V-172,611 AND CANADIAN BUILT MODEL 3H BEFORE ENGINE NO. VC-3,104.
10 - TYPE WITH FILTERED AIR FOR THE AUTOMATIC CHOKE AND THE HEATER PIPE ATTACHED TO THE INLET MANIFOLD USED ON MODEL 3H ON AND AFTER ENGINE NO. U.S.A. V-172,611 AND CANADA VC-3,104.

0305

FUEL SYSTEM

| ILLUST. NUMBER | PART NUMBER | CHANGE | DESCRIPTION | MODELS | PER CAR |
|---|-------------|--------|--|-----------------------|---------|
| 0305- GOVERNOR-Cont'd. | | | | | |
| | 674853 | | GASKET, GOVERNOR (INCL. IN GOVERNOR KITS) | 10G,12G | 1 |
| | 520471 | | EXTENSION W/NUTS AND UNION, FUEL PUMP TO CARB. PIPE (INCL. IN GOVERNOR KITS) | 10G,12G | 1 |
| | 515-04 | | NUT, PIPE 1/4" | 10G,12G | 2 |
| | 517-04 | | UNION. | 10G,12G | 1 |
| | 520153 | | PIPE W/NUTS, GOVERNOR TO CARBURETER (INCL. IN GOVERNOR KITS) | 10G,12G | 1 |
| | 515-03 | | NUT, PIPE 3/16". | 10G,12G | 2 |
| | 520-03 | | ELBOW, GOVERNOR TO CARBURETER PIPE (INCL. IN GOVERNOR KITS) | 10G,12G | 1 |
| | 520472 | | EXTENSION, AUTOMATIC CHOKE TO MANIFOLD PIPE (INCL. IN GOVERNOR KITS) | 10G,12G | 1 |
| | 520-03 | | ELBOW, SPARK MODIFIER PIPE (INCL. IN GOVERNOR KITS) | 10G,12G | 1 |
| 0307- GASOLINE TANK, GAGE AND MOUNTINGS (Plate 03-1,2) | | | | | |
| TANK AND MOUNTINGS | | | | | |
| 0307-1 | 525610 | | TANK, GASOLINE - 18 GALLONS | 10G,12G,H,3H. | 1 |
| 0307-1 | 531968 | | TANK, GASOLINE - 18 GALLONS - W-F-Y | 14G,4H. | 1 |
| 0307-1 | 532042 | | TANK, GASOLINE - 18 GALLONS - C-K | 14G,4H. | 1 |
| 0307-1 | 534155 | | TANK, GASOLINE - 18 GALLONS - D-N | 14G,4H. | 1 |
| | 551-04 | | PLUG, DRAIN 1/4" | 10G,12G,14G,H,3H,4H | 1 |
| | 12-0632 | | BOLT, TO RIGHT HANGER 3/8"-24X2" | 10G,12G,14G,H,3H,4H | 1 |
| 0307-2 | 194611 | | SHIM, INSULATING - RUBBER. | 10G,12G,14G,H,3H,4H | 1 |
| 0307-3 | 194383 | | SPRING, COIL | 10G,12G,14G,H,3H,4H | 1 |
| | 262-06 | | NUT, SLOTTED HEX. 3/8"-24 | 10G,12G,14G,H,3H,4H | 1 |
| | ---- | | COTTER, 3/32"X1". | 10G,12G,14G,H,3H,4H | 1 |
| | 2-0612 | | BOLT, TO LEFT HANGER 3/8"-24X3/4". | 10G,12G,14G,H,3H,4H | 2 |
| | 252-06 | | NUT, HEX. 3/8"-24 | 10G,12G,14G,H,3H,4H | 2 |
| | 380-06 | | WASHER, LOCK 3/8" | 10G,12G,14G,H,3H,4H | 2 |
| | 1160XBH10 | | PAD, GASOLINE TANK - FELT 10" LONG. | 10G,12G,14G,H,3H,4H | 1 |
| 0307-4 | 525355 | | HANGER, RIGHT, GASOLINE TANK. | 10G,12G,H,3H. | 1 |
| 0307-5 | 525358 | | HANGER, LEFT FRONT, GASOLINE TANK | 10G,12G,H,3H. | 1 |
| 0307-6 | 525612 | | HANGER, LEFT REAR, GASOLINE TANK. | 10G,12G,H,3H. | 1 |
| 0307-4A | 532086 | | HANGER, RIGHT, GASOLINE TANK - W-F-Y. | 14G,4H. | 1 |
| 0307-4B | 532064 | | HANGER, RIGHT, GASOLINE TANK - C-K. | 14G,4H. | 1 |
| 0307-4A | 534062 | | HANGER, RIGHT, GASOLINE TANK - D-N. | 14G,4H. | 1 |
| 0307-5 | 532016 | | HANGER, LEFT FRONT, GASOLINE TANK - EXCEPT D-N. | 14G,4H. | 1 |
| 0307-6 | 532015 | | HANGER, LEFT REAR, GASOLINE TANK - EXCEPT D-N | 14G,4H. | 1 |
| 0307-5 | 534060 | | HANGER, LEFT FRONT, GASOLINE TANK - D-N | 14G,4H. | 1 |
| 0307-6 | 534061 | | HANGER, LEFT REAR, GASOLINE TANK - D-N. | 14G,4H. | 1 |
| | 650-0510 | | SCREW, RIGHT HANGER TO TIRE WELL 5/16"X5/8". | 10G,12G,H,3H. | 2 |
| | ---- | | WASHER, PLAIN 5/16" | 10G,12G,H,3H. | 2 |
| | 650-0510 | | SCREW, RIGHT HANGER TO TIRE WELL 5/16"X5/8" } W-F-Y. | 14G,4H. | 2 |
| | ---- | | WASHER, PLAIN 5/16" | 14G,4H. | 2 |
| | 2-0616 | | BOLT, RIGHT HANGER TO BODY 3/8"-24X1" | 14G,4H. | 1 |
| | 252-06 | | NUT, HEX. 3/8"-24 | 14G,4H. | 1 |
| | ---- | | WASHER, UPPER, PLAIN 3/8" | 14G,4H. | 1 |
| | ---- | | WASHER, LOWER, PLAIN 3/8" | 14G,4H. | 1 |
| | 380-06 | | WASHER, LOCK 3/8" | 14G,4H. | 1 |
| | 2-0616 | | BOLT, LEFT HANGER TO FRAME 3/8"-24X3/4". | 10G,12G,14G,H,3H,4H | 4 |
| | 252-06 | | NUT, HEX. 3/8"-24 | 10G,12G,14G,H,3H,4H | 4 |
| | 380-06 | | WASHER, LOCK 3/8" | 10G,12G,14G,H,3H,4H | 4 |
| | 0307-7 | | CAP, GASOLINE TANK FILLER | 10G,12G,14G,H,3H,4H | 1 |
| | 0307-9 | | NECK, GASOLINE TANK FILLER. | 10G,12G,H,3H. | 1 |
| | 0307-9 | | NECK, GASOLINE TANK FILLER - EXCEPT C-K | 14G,4H. | 1 |
| | 0307-9 | | NECK, GASOLINE TANK FILLER - C-K. | 14G,4H. | 1 |

FUEL SYSTEM

0307

| ILLUST. NUMBER | PART NUMBER | CHANGE | DESCRIPTION | MODELS | PER CAR |
|--|-------------|--------|---|-----------------------|---------|
| 0307- GASOLINE TANK, GAGE AND MOUNTINGS-Cont'd. | | | | | |
| (Plates 03-1,2) | | | | | |
| TANK AND MOUNTINGS-Cont'd. | | | | | |
| 0307-8 | 286647 | | GROMMET, GASOLINE TANK FILLER NECK - RUBBER | 10G,12H,14G,H,3H,4H | 1 |
| 0307-10 | 289655P | | CLAMP, GASOLINE TANK FILLER NECK. | 10G,12G,14G,H,3H,4H | 1 |
| | 805-0520 | | SCREW AND WASHER, TO PROTECTOR 5/16"-18X1 1/4" | 10G,12G,14G,H,3H,4H | 1 |
| | 1-0416 | | BOLT, CLAMPING 1/4"-20X1" | 10G,12G,14G,H,3H,4H | 1 |
| | 1578X10 | | SPEED NUT 1/4" | 10G,12G,14G,H,3H,4H | 1 |
| 0307-11 | 531581 | | HOSE, GASOLINE TANK FILLER NECK | 10G,12G,14G,H,3H,4H | 1 |
| | 472-42 | | CLAMP, HOSE 2 5/8" | 10G,12G,14G,H,3H,4H | 2 |
| 0307-16 | 289858P | | PROTECTOR, GASOLINE TANK FILLER NECK (ILLUST. PLATE 16-1,2) | 10G,12G,H,3H. | 1 |
| 0307-16 | 298306P | | PROTECTOR, GASOLINE TANK FILLER NECK - W-F-Y (ILLUST. PLATE 16-3). | 14G,4H. | 1 |
| 0307-16 | 303618P | | PROTECTOR, GASOLINE TANK FILLER NECK - C-K (ILLUST. PLATE 16-4). | 14G,4H. | 1 |
| | 638-#8-10 | | SCREW, TO FENDER NO.8X5/8" | 10G,12G,14G,H,3H,4H | 3 |
| | 1578X18 | | SPEED NUT NO.8. | 10G,12G,14G,H,3H,4H | 3 |
| | 56-0412 | | BOLT, TO GRAVEL DEFLECTOR 1/4"-28X3/4" | 10G,12G,H,3H. | 2 |
| | 252-04 | | NUT, HEX. 1/4"-28 | 10G,12G,H,3H. | 2 |
| | ---- | | WASHER, PLAIN 1/4" | 10G,12G,H,3H. | 4 |
| | ---- | | WASHER, LOCK 1/4" | 10G,12G,H,3H. | 2 |
| | 361-#8 | | WASHER, PLAIN NO.8 - C-K. | 14G,4H. | 1 |
| | 1570X3 | | BOLT, TO GRAVEL DEFLECTOR 5/16"-10X3/4" | 14G,4H. | 2 |
| | 1743X1 | | SPEED NUT 5/16" | 14G,4H. | 2 |
| | 367-05 | | WASHER, PLAIN 5/16" | 14G,4H. | 2 |
| | 1960X1 | | BOLT AND WASHER, TO GRAVEL DEFLECTOR 5/16"-18X5/8" | 14G,4H. | 2 |
| | 251-05 | | NUT, HEX. 5/16"-18. | 14G,4H. | 2 |
| | 367-05 | | WASHER, PLAIN 5/16" | 14G,4H. | 2 |
| | 380-05 | | WASHER, LOCK 5/16" | 14G,4H. | 2 |
| | 1570X3 | | BOLT, TO WHEELHOUSE PANEL 5/16"-10X3/4" | 14G,4H. | 2 |
| | 1743X1 | | SPEED NUT 5/16" | 14G,4H. | 2 |
| | 367-05 | | WASHER, PLAIN 5/16" | 14G,4H. | 2 |
| 0307-18 | 525990 | | SHIELD, FRAME GAS TANK (ILLUST. PLATE 15-1) FASTENED TO FRAME SIDE MEMBER WITH BUMPER INNER BAR BOLTS | 10G,12G,H,3H. | 2 |
| 0307-18 | 532309 | | SHIELD, FRAME GAS TANK (ILLUST. PLATE 15-2) FASTENED TO FRAME SIDE MEMBER WITH BUMPER INNER BAR BOLTS | 14G,4H. | 2 |
| GASOLINE GAGE (TANK UNIT) | | | | | |
| 0307-20 | 525548 | | GAGE, GASOLINE (TANK UNIT). | 10G,12G,H,3H. | 1 |
| 0307-20 | 525548 | | GAGE, GASOLINE (TANK UNIT) W-F-Y. | 14G,4H. | 1 |
| 0307-20 | 532261 | | GAGE, GASOLINE (TANK UNIT) C-K-D-N. | 14G,4H. | 1 |
| | 615-#10-10 | | SCREW, TO TANK NO.10X5/8" | 10G,12G,14G,H,3H,4H | 5 |
| | 187763 | | WASHER, SPECIAL | 10G,12G,14G,H,3H,4H | 5 |
| | ---- | | SCREW, TERMINAL NO.10-32X1/4" | 10G,12G,14G,H,3H,4H | 1 |
| | 384-#10 | | WASHER, SH'PRF. NO.10 | 10G,12G,14G,H,3H,4H | 1 |
| 0307-21 | 521374 | | GASKET, GASOLINE GAGE | 10G,12G,14G,H,3H,4H | 1 |

0308

FUEL SYSTEM

| ILLUST. NUMBER | PART NUMBER | CHANGE | DESCRIPTION | MODELS | PER CAR |
|--|-------------|--------|--|---------------------------|---------|
| 0308- FUEL (GASOLINE) LINES AND CONNECTIONS (Plates 03-1,2) | | | | | |
| | | | | 5/16" O.D. X LENGTH | |
| 0308-1 | 530315 | | PIPE W/NUTS, FRONT, GAS TANK TO FUEL PUMP 51 1/2". | 10G,12G | 1 |
| 0308-2 | 525223 | | PIPE W/NUTS, REAR, GAS TANK TO FUEL PUMP. 132 1/4". | 10G,12G | 1 |
| 0308-1 | 532921 | | PIPE W/NUTS, FRONT, GAS TANK TO FUEL PUMP - EXCEPT C-K 50" | 14G | 1 |
| 0308-1 | 532920 | | PIPE W/NUTS, FRONT, GAS TANK TO FUEL PUMP - C-K 56 1/2". | 14G | 1 |
| 0308-2 | 525223 | | PIPE W/NUTS, REAR, GAS TANK TO FUEL PUMP - EXCEPT C-K 132 1/4". | 14G | 1 |
| 0308-2 | 525266 | | PIPE W/NUTS, REAR, GAS TANK TO FUEL PUMP - C-K. 136 1/4". | 14G | 1 |
| 0308-1 | 531088 | | PIPE W/NUTS, FRONT, GAS TANK TO FUEL PUMP 42" | H,3H. | 1 |
| 0308-2 | 525223 | | PIPE W/NUTS, REAR, GAS TANK TO FUEL PUMP - EXCEPT Y 132 1/4". | H,3H. | 1 |
| 0308-2 | 525266 | | PIPE W/NUTS, REAR, GAS TANK TO FUEL PUMP - Y. 136 1/4". | H,3H. | 1 |
| 0308-1 | 533132 | | PIPE W/NUTS, FRONT, GAS TANK TO FUEL PUMP - NOTE 11. 40 1/8". | 4H. | 1 |
| 0308-1 | 534364 | | PIPE W/NUTS, FRONT, GAS TANK TO FUEL PUMP - EXCEPT C-K - NOTE 12 47 3/4". | 4H. | 1 |
| 0308-1 | 534368 | | PIPE W/NUTS, FRONT, GAS TANK TO FUEL PUMP - C-K - NOTE 12. 43 3/8". | 4H. | 1 |
| 0308-2 | 525223 | | PIPE W/NUTS, REAR, GAS TANK TO FUEL PUMP - W-F-D-N. 132 1/4". | 4H. | 1 |
| 0308-2 | 525266 | | PIPE W/NUTS, REAR, GAS TANK TO FUEL PUMP-C-K-Y. 136 1/4". | 4H. | 1 |
| | 515-05 | | NUT, PIPE 5/16". | 10G,12G,14G,H,3H,4H | 4 |
| | 525560 | | CLIP, FRONT PIPE (SNAP TYPE) | 10G,12G,14G | 2 |
| | 172653 | | CLIP, FRONT PIPE 13/16" LONG (CLAMP TYPE). | 14G,H,3H,4H | 1 |
| | 190470 | | CLIP, FRONT PIPE 1 13/16" LONG (CLAMP TYPE). | 14G,H,3H,4H | 1 |
| | 182050 | | CLIP, FRONT PIPE TO RADIATOR | 3H. | 1 |
| | 190470 | | CLIP, FRONT PIPE TO RADIATOR FAN SHROUD 1 13/16" LONG (CLAMP TYPE) | 4H. | 1 |
| | 525560 | | CLIP, REAR PIPE (SNAP TYPE). | 10G,12G | 2 |
| | 172653 | | CLIP, REAR PIPE 13/16" LONG (CLAMP TYPE) | 10G,12G,H,3H. | 1 |
| | 190470 | | CLIP, REAR PIPE 1 13/16" LONG (CLAMP TYPE) | 10G,12G,H,3H. | 3 |
| | 190470 | | CLIP, REAR PIPE 1 13/16" LONG (CLAMP TYPE) | 14G,4H. | 1 |
| | 172653 | | CLIP, REAR PIPE 13/16" LONG (CLAMP TYPE) | 14G,4H. | 2 |
| | 525560 | | CLIP, REAR PIPE (SNAP TYPE). | H,3H. | 1 |
| 0308-5 | 532922 | | CLIP, PROTECTOR, REAR PIPE | 14G,4H. | 1 |
| | 651-#14-8 | | SCREW, TO FRAME NO.14X1/2". | 10G,12G,14G,H,3H. | * |
| | 651-#14-14 | | SCREW, FRONT PIPE TO FRAME NO.14X7/8" | 4H. | 2 |
| | 651-#14-8 | | SCREW, REAR PIPE TO FRAME NO.14X1/2". | 4H. | 4 |
| | 55-0416 | | BOLT, 1/4"-20X1". | 4H. | 1 |
| | 251-04 | | NUT, HEX. 1/4"-20 . TO RADIATOR SHROUD. | 4H. | 1 |
| | ---- | | WASHER, LOCK 1/4" | 4H. | 1 |
| 0308-3 | ---- | | UNION, GAS TANK TO FUEL PUMP PIPE 5/16" | 10G,12G,14G,H,3H,4H | 1 |
| 0308-4 | 189888 | | COUPLING, GAS TANK TO FUEL PUMP PIPE FLEXIBLE | 10G,12G,14G,H,3H,4H | 1 |
| | | | | 1/4" O.D. X LENGTH | |
| 0308-6 | 512966 | | PIPE W/NUTS, FUEL PUMP TO CARBURETER.15 1/2". | 10G,12G,14G | 1 |
| 0308-6 | 530623 | | PIPE W/NUTS, FUEL PUMP TO CARBURETER.15" | H,3H. | 1 |
| 0308-6 | 532567 | | PIPE W/NUTS, FUEL PUMP TO CARBURETER.12" | 4H. | 1 |
| | 515-04 | | NUT, PIPE 1/4" | 10G,12G,14G,H,3H,4H | 2 |
| 0308-7 | 520-05 | | ELBOW, GAS TANK TO FUEL PUMP PIPE (PUMP END). | 10G,12G,14G | 1 |
| 0308-8 | 520-04 | | ELBOW, FUEL PUMP TO CARBURETER PIPE | 10G,12G,14G | 2 |
| 0308-7 | ---- | | NIPPLE, GAS TANK TO FUEL PUMP PIPE (PUMP END) 5/16" | H,3H,4H | 1 |
| 0308-8 | 518-04 | | NIPPLE, FUEL PUMP TO CARBURETER PIPE. | H,3H,4H | 2 |

NOTES { * - USE AS REQUIRED.
11 - USED ON MODEL 4H BEFORE CAR SERIAL H-8,313,577
12 - USED ON AND AFTER CAR SERIAL IN NOTE 11.

FUEL SYSTEM

0312

| ILLUST. NUMBER | PART NUMBER | CHANGE | DESCRIPTION | MODELS | PER CAR |
|--|-------------|--------|---|---------------------|---------|
| 0312- ACCELERATOR AND THROTTLE CONTROLS-Cont'd. | | | | | |
| (Plates 03-5, 6, 7, 8, 9, 10) | | | | | |
| COMMANDER | | | | | |
| 0312-1 | 527135 | | PEDAL, ACCELERATOR - LHC. | H, 3H. | 1 |
| 0312-1 | 527135 | | PEDAL, ACCELERATOR - EXCEPT C-K - LHC. | 4H. | 1 |
| 0312-1 | 532800 | | PEDAL, ACCELERATOR - C-K - LHC. | 4H. | 1 |
| | 650-0416 | | BOLT, TO TOE BOARD 1/4"x1" | H, 3H, 4H | 2 |
| | 1811X3 | | SPEED NUT 1/4". | H, 3H, 4H | 2 |
| | 530595 | | PEDAL, CROSS SHAFT AND BRACKETS, ACCELERATOR - RHC. | H, 3H. | 1 |
| | 533574 | | PEDAL, CROSS SHAFT AND BRACKETS, ACCELERATOR-W-F-Y-D-N-RHC. | 4H. | 1 |
| | 614-#14-8 | | SCREW, TO DASH NO. 14X1/2". | H, 3H, 4H | 2 |
| 0312-3 | 530310 | | PUSH ROD, ACCELERATOR (EXCEPT AD) LHC | H, 3H. | 1 |
| 0312-3 | 530525 | | PUSH ROD, ACCELERATOR (WITH AD) LHC | H, 3H. | 1 |
| 0312-3A | 533623 | | PUSH ROD, ACCELERATOR - EXCEPT C-K - LHC. | 4H. | 1 |
| 0312-3B | 533652 | | PUSH ROD, ACCELERATOR - C-K - LHC | 4H. | 1 |
| | 438-0412 | | PIN, CLEVIS 1/4"x3/4" - NOTE 14. | H, 3H. | 1 |
| | ---- | | COTTER 1/16"x3/4" | H, 3H. | 1 |
| | 42X60 | | PIN, CLEVIS 3/16"x31/64" } C-K | 4H. | 1 |
| | ---- | | COTTER 1/16"x1/2" | 4H. | 1 |
| 0312-3-1 | 190994 | | BALL STUD, PUSH ROD TO ACCELERATOR CROSS SHAFT - LHC. | 4H. | 1 |
| | 280-#10 | | LOCK NUT NO. 10-32. | 4H. | 1 |
| | ---- | | WASHER, LOCK NO. 10. | 4H. | 1 |
| 0312-5 | 513536X1 | | SLEEVE, ACCELERATOR PUSH ROD - RUBBER - LHC | H, 3H, 4H | 1 |
| 0312-6 | 530308 | | LEVER, ACCELERATOR CONTROL (EXCEPT AD) LHC - NOTE 13. | H | 1 |
| 0312-6 | 531097 | | LEVER, ACCELERATOR CONTROL (EXCEPT AD) LHC - NOTE 14. | H, 3H. | 1 |
| | ---- | | PIN, TO BRACKET 5/16"x1 7/8" | H, 3H. | 1 |
| | ---- | | COTTER, 3/32"x3/4". | H, 3H. | 1 |
| 0312-6-1 | 530309 | | BRACKET, ACCELERATOR CONTROL LEVER (EXCEPT AD) LHC. | H, 3H. | 1 |
| | 55-0416 | | BOLT, TO FLOOR PAN 1/4"-20X1". | H, 3H. | 2 |
| | 251-04 | | NUT, HEX. 1/4"-20 | H, 3H. | 2 |
| | ---- | | WASHER, PLAIN 1/4". | H, 3H. | 2 |
| | ---- | | WASHER, LOCK 1/4" | H, 3H. | 2 |
| 0312-6 | 530400 | | BELL CRANK AND BRACKET, ACCELERATOR (WITH AD) LHC - NOTE 13 | H | 1 |
| 0312-6 | 531055 | | BELL CRANK AND BRACKET, ACCELERATOR (WITH AD) LHC - NOTE 14 | H, 3H. | 1 |
| | 55-0416 | | BOLT, TO FLOOR PAN 1/4"-20X1". | H, 3H. | 3 |
| | 251-04 | | NUT, HEX. 1/4"-20 | H, 3H. | 3 |
| | ---- | | WASHER, PLAIN 1/4". | H, 3H. | 3 |
| | ---- | | WASHER, LOCK 1/4" | H, 3H. | 3 |
| 0312-10 | 530306 | | ROD, LEVER OR BELL CRANK TO CROSS SHAFT - LHC - NOTE 13 | H | 1 |
| 0312-10 | 531098 | | ROD, ACCELERATOR LEVER TO CROSS SHAFT (EXCEPT AD) LHC - | | |
| | | | NOTE 14. | H, 3H. | 1 |
| 0312-10 | 531084 | | ROD, ACCELERATOR BELL CRANK TO CROSS SHAFT (WITH AD) LHC - | | |
| | | | NOTE 13. | H, 3H. | 1 |
| 0312-12 | 184526 | | WASHER, SPRING | H. | 2 |
| | ---- | | WASHER, PLAIN 1/4" | H, 3H. | 2 |
| | ---- | | COTTER 1/16"x3/4" | H, 3H. | 2 |
| | 530609 | | ROD, PEDAL SHAFT TO CROSS SHAFT - RHC | H, 3H. | 1 |
| | 534212 | | ROD, PEDAL SHAFT TO CROSS SHAFT - W-F-Y-D-N - RHC | 4H. | 1 |
| | 184526 | | WASHER, SPRING | H | 2 |
| | ---- | | WASHER, PLAIN 1/4" | H, 3H, 4H | 2 |
| | ---- | | COTTER 1/16"x3/4" | H, 3H, 4H | 2 |

NOTES { 13 - USED ON MODEL H WITH ST | OD | AD
 BEFORE CAR SERIALS U.S.A. 8,137,462 | 8,126,640 | 8,133,626
 CANADA 8,952,576 | 8,952,576 | 8,952,576
 14 - USED ON AND AFTER CAR SERIALS IN NOTE 13.

FUEL SYSTEM

0312

| ILLUST. NUMBER | PART NUMBER | CHANGE | DESCRIPTION | MODELS | PER CAR |
|--|-------------|--------|--|---------|---------|
| <p>0312- ACCELERATOR AND THROTTLE CONTROLS-Cont'd. (Plates 03-5,6,7,8,9,10) COMMANDER-Cont'd.</p> | | | | | |
| | 195506 | | CLEVIS, PEDAL SHAFT TO CROSS SHAFT ROD - W-F-Y-D-N - RHC. | 4H. | 1 |
| | ---- | | LOCK NUT 1/4"-28 | 4H. | 1 |
| | 438-0412 | | PIN, CLEVIS 1/4"x3/4" | 4H. | 1 |
| | ---- | | COTTER 1/16"x3/4" | 4H. | 1 |
| 0312-15 | 530304 | | CROSS SHAFT AND BRACKET, THROTTLE CONTROL (EXCEPT AD) LHC | H,3H. | 1 |
| 0312-15 | 530477 | | CROSS SHAFT AND BRACKET, THROTTLE CONTROL (WITH AD) LHC - NOTE 13. | H | 1 |
| 0312-15 | 531069 | | CROSS SHAFT AND BRACKET, THROTTLE CONTROL (WITH AD) LHC - NOTE 14. | H,3H. | 1 |
| 0312-15 | 533648 | | CROSS SHAFT AND BRACKET, THROTTLE CONTROL (EXCEPT AD) LHC | 4H. | 1 |
| 0312-15 | 533637 | | CROSS SHAFT AND BRACKET, THROTTLE CONTROL (WITH AD) LHC | 4H. | 1 |
| | 530605 | | CROSS SHAFT AND BRACKET, THROTTLE CONTROL - RHC | H,3H. | 1 |
| | 534209 | | CROSS SHAFT AND BRACKET, THROTTLE CONTROL - W-F-Y-D-N - RHC | 4H. | 1 |
| 651-#14-14 | | | SCREW, TO DASH NO.14X7/8" | H,3H,4H | 4 |
| | ---- | | WASHER, PLAIN 1/4" | H,3H,4H | 4 |
| | 530888 | | STOP, CROSS SHAFT - LHC - NOTE 13. | H | 1 |
| | 56-#10-16 | | SCREW, STOP NO.10-32X1" } EXCEPT AD. | 4H. | 1 |
| | 280-#10 | | LOCK NUT, NO.10-32. } LHC | 4H. | 1 |
| | 2-0416 | | ADJUSTING SCREW, OD KICKDOWN SWITCH 1/4"-28X1" (WITH OD) LHC. | 4H. | 1 |
| | 252-04 | | LOCK NUT 1/4"-28 | 4H. | 1 |
| 0312-20A | 529484 | | ROD, CROSS SHAFT TO CARBURETER (WITH ST). | H,3H. | 1 |
| 0312-20B | 529476 | | ROD, CROSS SHAFT TO CARBURETER (WITH OD). | H,3H. | 1 |
| 0312-20 | 530473 | | ROD, CROSS SHAFT TO CARBURETER (WITH AD) LHC. | H,3H. | 1 |
| | 533742 | | ROD, CROSS SHAFT TO CARBURETER (WITH ST) W-F-Y-D-N - RHC. | 4H. | 1 |
| | 533740 | | ROD, CROSS SHAFT TO CARBURETER (WITH OD) W-F-Y-D-N - RHC. | 4H. | 1 |
| 0312-12 | 184526 | | WASHER, SPRING | H | 1 |
| | ---- | | WASHER, PLAIN 1/4" | H,3H. | 1 |
| | ---- | | COTTER 3/32"x1/2" } WITH ST | H,3H. | 1 |
| | ---- | | WASHER, PLAIN 1/4" - RHC | 4H. | 1 |
| | ---- | | COTTER 1/16"x3/4" - RHC | 4H. | 1 |
| 0312-20-1 | 534230 | | SPRING, CROSS SHAFT TO CARBURETER ACTUATING - LHC | 4H. | 1 |
| 0312-20-2 | 533538X1 | | LINK, ACTUATING SPRING ADJUSTING - EXCEPT C-K - LHC | 4H. | 1 |
| 0312-20-2 | 533538X2 | | LINK, ACTUATING SPRING ADJUSTING - C-K - LHC. | 4H. | 1 |
| | 195506 | | CLEVIS, CROSS SHAFT TO CARBURETER ROD - W-F-Y-D-N - RHC | 4H. | 1 |
| | 252-04 | | LOCK NUT 1/4"-28 | 4H. | 2 |
| | 438-0412 | | PIN, CLEVIS 1/4"x3/4" | 4H. | 1 |
| | ---- | | COTTER 1/16"x3/4" | 4H. | 1 |
| 0312-21 | 529477 | | SWIVEL, SLIDING, CROSS SHAFT TO CARB. ROD (WITH OD) | H,3H. | 1 |
| 0312-21 | 530523 | | SWIVEL, SLIDING, CROSS SHAFT TO CARB. ROD (WITH AD) LHC | H,3H. | 1 |
| 0312-21 | 529477 | | SWIVEL, ADJUSTING LINK - LHC. | 4H. | 1 |
| 0312-21 | 529477 | | SWIVEL, SLIDING, CROSS SHAFT TO CARB. ROD (WITH OD) W-F-Y-D-N - RHC | 4H. | 1 |
| | 252-04 | | LOCK NUT 1/4"-28 | 4H. | 2 |
| 0312-12 | 184526 | | WASHER, SPRING | H | 1 |
| | ---- | | WASHER, PLAIN 1/4" | H,3H,4H | 1 |
| | ---- | | COTTER 3/32"x1/2" | H,3H,4H | 1 |

| | | | | | |
|-------|---|-----------|-----------|-----------|-----------|
| NOTES | } 13 - USED ON MODEL H WITH BEFORE CAR SERIALS | U.S.A. | ST | OD | AD |
| | | 8,137,462 | 8,137,462 | 8,126,640 | 8,133,626 |
| | | CANADA | 8,952,576 | 8,952,576 | 8,952,576 |
| | 14 - USED ON AND AFTER CAR SERIALS IN NOTE 13. | | | | |

CORRECTIONS TO CHAMPION SIX AND COMMANDER EIGHT CHASSIS PARTS CATALOG

1951 - 1952 - 1953 SERIES

Dated July 1, 1953

Make The Following Changes

Page 69 0312-28-1 529301 SPRING, cross shaft pull back-LHC 4H 1
(change illust. number from 0312-28-1 to 0312-28-2)

Page 247 Plate 15-1
Add Models 10G,12G-H,3H

Page 248 Plate 15-2
Add Models 14G-4H

FUEL SYSTEM

0312

| ILLUST. NUMBER | PART NUMBER | CHANGE | DESCRIPTION | MODELS | PER CAR |
|--|-------------|--------|--|---------------------|---------|
| 0312- ACCELERATOR AND THROTTLE CONTROLS-Cont'd. | | | | | |
| (Plates 03-5, 6, 7, 8, 9, 10) | | | | | |
| COMMANDERS-Cont'd. | | | | | |
| 0312-22 | 136813 | | SPRING, SWIVEL COIL TENSION (WITH OD) NOTE 13 | H | 1 |
| 0312-22 | 531100 | | SPRING, SWIVEL COIL TENSION (WITH OD) NOTE 14 | H, 3H. | 1 |
| 0312-22 | 527111 | | SPRING, SWIVEL COIL TENSION (WITH AD) | H, 3H. | 1 |
| | 531100 | | SPRING, SWIVEL COIL TENSION (WITH OD) W-F-Y-D-N - RHC | 4H. | 1 |
| | ---- | | WASHER, PLAIN 1/4" | H, 3H, 4H | 1 |
| | ---- | | COTTER 3/32"x1/2" | 4H. | 1 |
| 0312-24 | 529313 | | SLEEVE, TUBULAR (WITH AD) | H, 3H. | 1 |
| | ---- | | WASHER, PLAIN 1/4" | H, 3H. | 1 |
| | ---- | | COTTER 3/32"x1/2" | H, 3H. | 1 |
| 0312-25 | 530474 | | SWIVEL, ADJUSTABLE, CROSS SHAFT TO CARB. ROD. | H, 3H. | 1 |
| | 252-04 | | LOCK NUT 1/4"-28 | H, 3H. | 1 |
| 0312-12 | 184526 | | WASHER, SPRING | H | 1 |
| | ---- | | WASHER, PLAIN 1/4" | H, 3H. | 1 |
| | ---- | | COTTER 3/32"x1/2" | H, 3H. | 1 |
| 0312-28 | 520443 | | SPRING, ACCELERATOR PULL BACK (EXCEPT AD) NOTE 13 | H | 1 |
| 0312-28 | 531099 | | SPRING, ACCELERATOR PULL BACK (EXCEPT AD) NOTE 14 | H, 3H. | 1 |
| 0312-28-1 | 529300 | | SPRING, UPPER, ACCELERATOR PULL BACK (WITH AD) LHC. | H, 3H. | 1 |
| 0312-28-2 | 529301 | | SPRING, LOWER, ACCELERATOR PULL BACK (WITH AD) LHC. | H, 3H. | 1 |
| 0312-28-1 | 529301 | | SPRING, THROTTLE PULL BACK (EXCEPT AD) LHC. | 4H. | 1 |
| 0312-28-1 | 533585 | | SPRING, THROTTLE PULL BACK (WITH AD) LHC. | 4H. | 1 |
| 0312-28-1 | 529301 | | SPRING, CROSS SHAFT PULL BACK - LHC | 4H. | 1 |
| | 520443 | | SPRING, CROSS SHAFT PULL BACK - W-F-Y-D-N - RHC | 4H. | 1 |
| 0312-29 | 167320 | | CLIP, TO ROD | H, 3H. | * |
| 0312-29 | 533640 | | CLIP, TO VALVE ROCKER ARM COVER - LHC. | 4H. | 1 |
| 0312-29 | 631469 | | CLIP, TO FUEL PUMP SUPPORT - LHC | 4H. | 1 |
| | 533794 | | CLIP, TO DASH - W-F-Y-D-N - RHC. | 4H. | 1 |
| 0312-40 | 530436 | | ROD, ACCELERATOR BELL CRANK TO TRANSMISSION (WITH AD) LHC - NOTE 13. | H | 1 |
| 0312-40 | 531058 | | ROD, ACCELERATOR BELL CRANK TO TRANSMISSION (WITH AD) LHC - NOTE 14. | H, 3H. | 1 |
| 0312-40 | 533659 | | ROD, CROSS SHAFT TO TRANSMISSION (WITH AD) EXCEPT C-K - LHC | 4H. | 1 |
| 0312-40 | 533635 | | ROD, CROSS SHAFT TO TRANSMISSION (WITH AD) C-K - LHC. | 4H. | 1 |
| 0312-12 | 184526 | | WASHER, SPRING | H | 1 |
| | ---- | | WASHER, PLAIN 1/4" | H, 3H, 4H | 1 |
| | ---- | | COTTER 1/16"x3/4" | H, 3H, 4H | 1 |
| 0312-41 | 527990 | | BALL JOINT, BELL CRANK TO TRANSMISSION ROD (WITH AD) LHC. | H, 3H. | 1 |
| 0312-41 | 527990 | | BALL JOINT, CROSS SHAFT TO TRANSMISSION ROD (WITH AD) LHC | 4H. | 1 |
| | 252-04 | | LOCK NUT 1/4"-28 | H, 3H, 4H | 1 |
| | 280-#10 | | NUT, TO LEVER NO. 10-32 | H, 3H, 4H | 1 |
| | ---- | | WASHER, LOCK NO. 10. | H, 3H, 4H | 1 |

NOTES { * - USE AS REQUIRED.
 13 - USED ON MODEL H WITH BEFORE CAR SERIALS U. S. A. ST 8,137,462 | OD 8,126,640 | AD 8,133,626
 CANADA 8,952,576 | 8,952,576 | 8,952,576
 14 - USED ON AND AFTER CAR SERIALS IN NOTE 13.