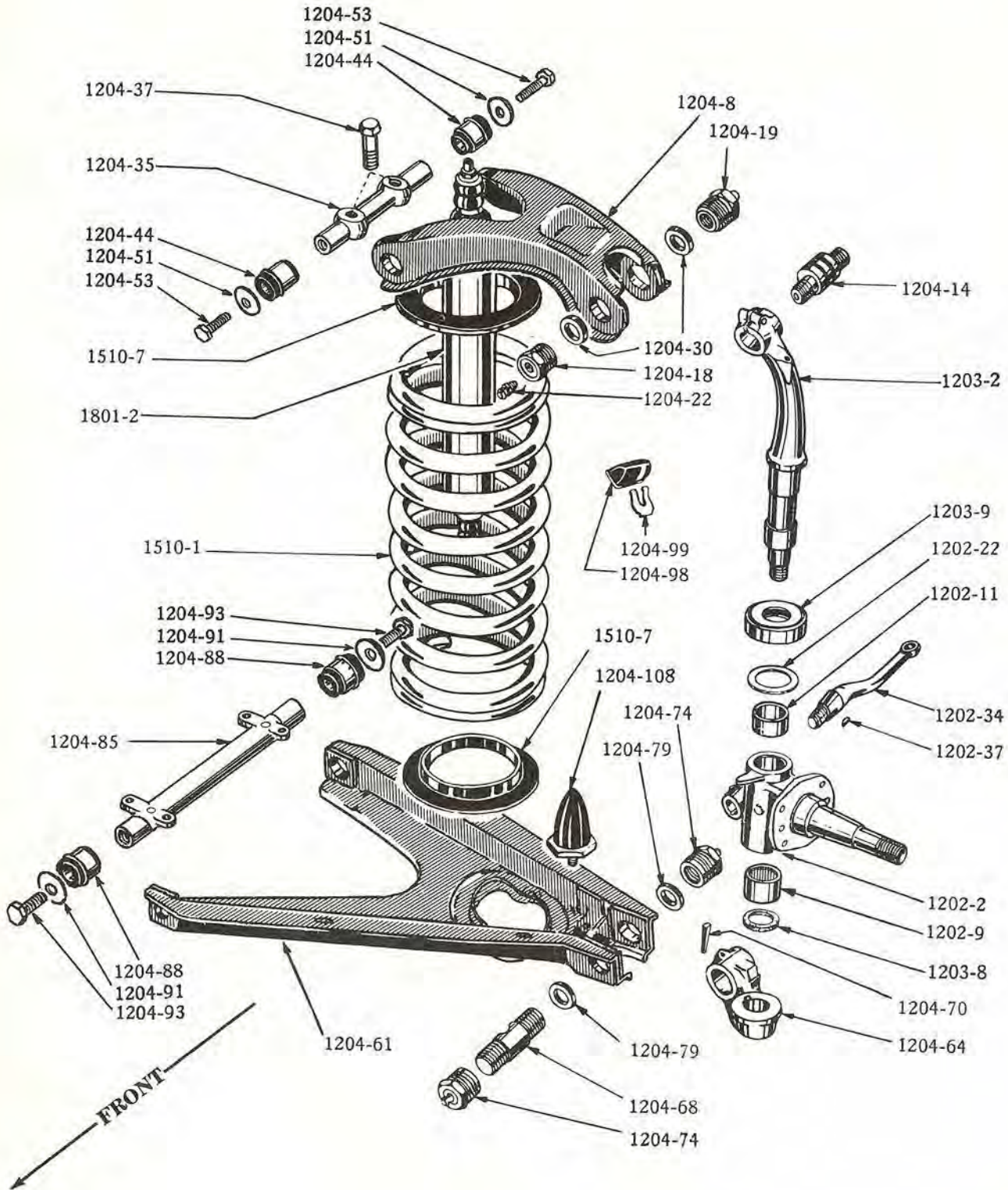

Plate 12-2

FRONT AXLE



**STEERING KNUCKLE, CONTROL ARMS and KING PINS -
Models 14G, 4H**

FRONT AXLE

Plate 12-3

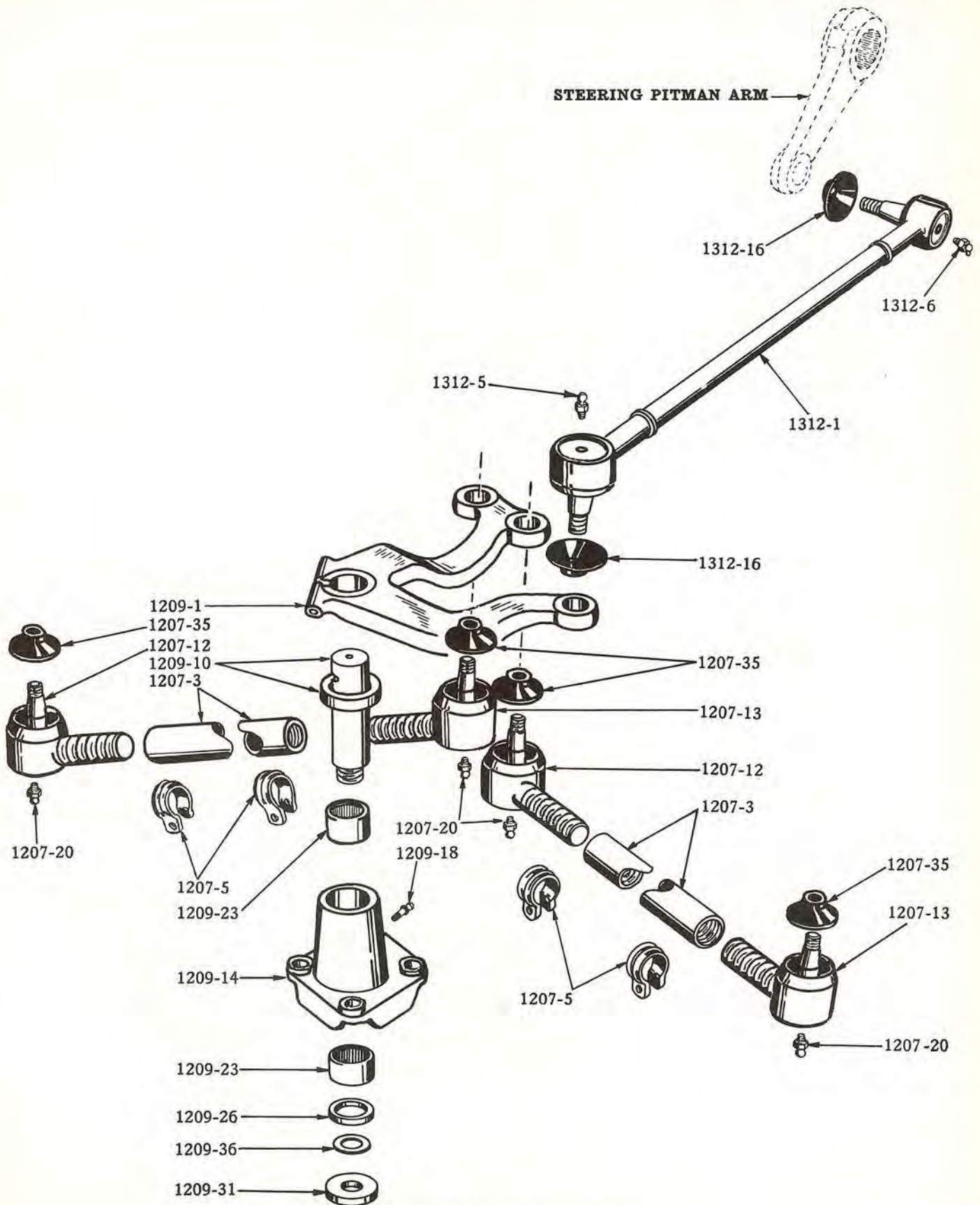

STEERING LINKAGE

FRONT AXLE

1202

ILLUST. NUMBER	PART NUMBER	CHANGE	DESCRIPTION	MODELS	PER CAR
1202- STEERING KNUCKLE AND ARM (Plate 12-2)					
1202-2	527988		KNUCKLE, RIGHT, STEERING (INCL. BEARING AND UPPER BUSHING)	10G, 12G, 14G, H, 3H, 4H	1
	527989		KNUCKLE, LEFT, STEERING (INCL. BEARING AND UPPER BUSHING)	10G, 12G, 14G, H, 3H, 4H	1
	531980		KNUCKLE, RIGHT, STEERING (INCL. BEARING AND UPPER BUSHING)	4H	1
1202-2	531981		KNUCKLE, LEFT, STEERING (INCL. BEARING AND UPPER BUSHING)	4H	1
	181314		GREASE FITTING, ALEMITE STRAIGHT	10G, 12G, 14G, H, 3H, 4H	2
1202-9	196859		BEARING, LOWER, STEERING KNUCKLE (INCL. IN 529057 KIT)	10G, 12G, 14G, H, 3H, 4H	2
1202-11	527981		BUSHING, UPPER, STEERING KNUCKLE (INCL. IN 529057 KIT) THICKNESS	10G, 12G, 14G, H, 3H, 4H	2
1202-22	193684		SHIM, STEERING KNUCKLE (INCL. IN 529057 KIT)	10G, 12G, 14G, H, 3H, 4H	*
1202-22	193685		SHIM, STEERING KNUCKLE	10G, 12G, 14G, H, 3H, 4H	*
1202-22	193686		SHIM, STEERING KNUCKLE	10G, 12G, 14G, H, 3H, 4H	*
1202-22	193687		SHIM, STEERING KNUCKLE	10G, 12G, 14G, H, 3H, 4H	*
1202-22	193688		SHIM, STEERING KNUCKLE	10G, 12G, 14G, H, 3H, 4H	*
1202-34	529050		ARM, STEERING KNUCKLE	10G, 12G, 14G, H, 3H, 4H	2
1202-37	461-606		KEY, WOODRUFF, TO KNUCKLE 3/16"X3/4"	10G, 12G, 14G, H, 3H, 4H	2
	262-10		NUT, TO KNUCKLE 5/8"-18	10G, 12G, 14G, H, 3H, 4H	2
	****		COTTER 1/8"X1 1/4"	10G, 12G, 14G, H, 3H, 4H	2

1203- STEERING KNUCKLE KING PIN AND BEARINGS (Plate 12-2)

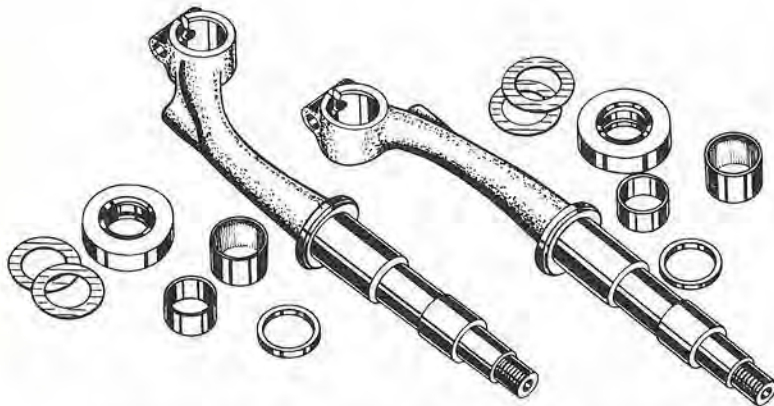

529057	KING PIN KIT - NOTE 1 - CONSISTS OF:			10G, 12G, 14G, H, 3H, 4H	1
	1-527978	KING PIN, RIGHT	2-196859 BEARING, LOWER		
	1-527979	KING PIN, LEFT	2-194257 BEARING, THRUST		
	2-527981	BUSHING, UPPER	4-193684 SHIM, KNUCKLE		
			2-519483 GASKET, KING PIN		
533888	KING PIN KIT - NOTE 2 - CONSISTS OF:			14G, 4H	1
	1-533762	KING PIN, RIGHT	2-196859 BEARING, LOWER		
	1-533763	KING PIN, LEFT	2-194257 BEARING, THRUST		
	2-527981	BUSHING, UPPER	4-193684 SHIM, KNUCKLE		
			2-519483 GASKET, KING PIN		

- NOTES**
- * - USE AS REQUIRED.
 - 1 - KING PIN HAS FORGING NO. 527978 AND 527979
USED ON MODELS
BEFORE CAR SERIALS

	14G	4H
So. BEND	G-1,210,056	8,298,538
CANADA	G-746,837	8,955,673

 - 2 - KING PIN HAS FORGING NO. 533762 AND 533763 USED ON AND AFTER CAR SERIALS IN NOTE 1.

FRONT AXLE

1203

ILLUST. NUMBER	PART NUMBER	CHANGE	DESCRIPTION	MODELS	PER CAR
1203- STEERING KNUCKLE KING PIN AND BEARINGS-Cont'd. (Plate 12-2)					
					
1203-2	527978		PIN, RIGHT, KING - NOTE 1	10G, 12G, 14G, H, 3H, 4H	1
	527979		PIN, LEFT, KING - NOTE 1	10G, 12G, 14G, H, 3H, 4H	1
	533762		PIN, RIGHT, KING - NOTE 2	14G, 4H	1
1203-2	533763		PIN, LEFT, KING - NOTE 2	14G, 4H	1
	260-12		NUT, TO SUPPORT 3/4"-16	10G, 12G, 14G, H, 3H, 4H	2
	----		WASHER, PLAIN 3/4"	10G, 12G, 14G, H, 3H, 4H	2
	----		COTTER 1/8"X1 1/2"	10G, 12G, 14G, H, 3H, 4H	2
1203-8	519483		GASKET, KING PIN (INCL. IN 529057 KIT)	10G, 12G, 14G, H, 3H, 4H	2
1203-9	194257		BEARING, KNUCKLE THRUST (INCL. IN 529057 KIT)	10G, 12G, 14G, H, 3H, 4H	2

NOTES {

- 1 - KING PIN HAS FORGING No. 527978 AND 527979
 USED ON MODELS 14G 4H
 BEFORE CAR SERIALS So. BEND G-1,210,056 | 8,298,538
 CANADA G-746,837 | 8,955,673
- 2 - KING PIN HAS FORGING No. 533762 AND 533763 USED ON AND AFTER CAR SERIALS IN NOTE 1.

1204

FRONT AXLE

ILLUST. NUMBER	PART NUMBER	CHANGE	DESCRIPTION	MODELS	PER CAR	
<p>1204- STEERING KNUCKLE CONTROL ARM (Plate 12-2) UPPER CONTROL ARM, PIN, SHAFT, ETC.</p>						
K3	531190		PIN AND BUSHING KIT, UPPER ARM OUTER, CONSISTS OF: 1- 529282 BUSHING 2- 525035 SEAL 1- 529281 BUSHING 1- 716-02 FITTING 1- 524227 PIN	10G, 12G, 14G, H, 3H, 4H	2	
K6	531191		SHAFT AND BUSHING KIT, UPPER ARM INNER, CONSISTS OF: 1- 524859 SHAFT 2- 525034 SEAL 2- 529268 BUSHING 2- 730-02 FITTING	10G, 12G, H, 3H.	2	
1204-8	527921		ARM, UPPER, KNUCKLE CONTROL.	10G, 12G, H, 3H.	2	
1204-8	532181		ARM, UPPER, KNUCKLE CONTROL.	14G, 4H.	2	
1204-14	524227		PIN, UPPER CONTROL ARM PIVOT (INCL. IN 531190 KIT)	10G, 12G, 14G, H, 3H, 4H	2	
12-0632			BOLT, CLAMPING, THRU KING PIN 3/8"×24×1 7/8".	10G, 12G, 14G, H, 3H, 4H	2	
252-06			NUT, CLAMP BOLT, HEX. 3/8"×24.	10G, 12G, 14G, H, 3H, 4H	2	
380-06			WASHER, LOCK 3/8".	10G, 12G, 14G, H, 3H, 4H	2	
1204-18	529282		BUSHING AND GREASE FITTING, OUTER FRONT, } UPPER CONTROL ARM	INCL. IN 531190 KIT	10G, 12G, 14G, H, 3H, 4H	2
1204-19	529281	BUSHING LESS GREASE FITTING, OUTER REAR, } UPPER CONTROL ARM	10G, 12G, 14G, H, 3H, 4H		2	
1204-22	181314	GREASE FITTING, OUTER REAR.	10G, 12G, 14G, H, 3H, 4H		2	
1204-30	525035		SEAL, CONTROL ARM OUTER BUSHING GREASE (INCL. IN 531191 KIT).	10G, 12G, 14G, H, 3H, 4H	4	

FRONT AXLE

1204

ILLUST. NUMBER	PART NUMBER	CHANGE	DESCRIPTION	MODELS	PER CAR
1204- STEERING KNUCKLE CONTROL ARM-Cont'd. (Plate 12-2)					
LOWER CONTROL ARM, PIN, SHAFT, ETC.-Cont'd.					
1204-35	524859		SHAFT, UPPER CONTROL ARM PIVOT (INCL. IN 531191 KIT)	10G, 12G, H, 3H.	2
1204-35	532184		SHAFT, UPPER CONTROL ARM PIVOT.	14G, 4H.	2
1204-37	526765		BOLT, TO FRAME 1/2"-20X1 5/8".	10G, 12G, 14G, H, 3H, 4H	4
	252-08		NUT, HEX. 1/2"-20	10G, 12G, 14G, H, 3H, 4H	4
	----		WASHER, LOCK 1/2"	10G, 12G, 14G, H, 3H, 4H	4
1204-44	529268		BUSHING, INNER, UPPER CONTROL ARM (INCL. IN 531191 KIT)	10G, 12G, H, 3H.	4
1204-44	533163		BUSHING, LOWER CONTROL ARM INNER SHAFT.	14G, 4H.	4
1204-48	730-02		GREASE FITTING (INCL. IN 531192 KIT)	10G, 12G, H, 3H.	4
1204-50	525034		SEAL, UPPER CONTROL ARM INNER BUSHING GREASE (INCL. IN 531191 KIT).	10G, 12G, H, 3H.	4
1204-51	532187		RETAINER, UPPER CONTROL ARM INNER BUSHING	14G, 4H.	4
1204-53	2-0616		SCREW, TO SHAFT 3/8"-24X1"	14G, 4H.	4
	380-06		WASHER, LOCK 3/8"	14G, 4H.	4

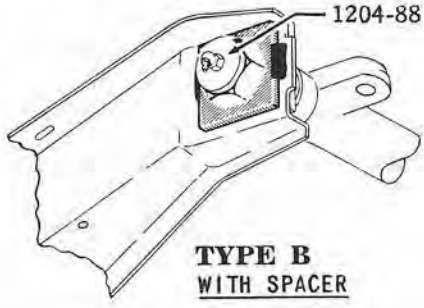
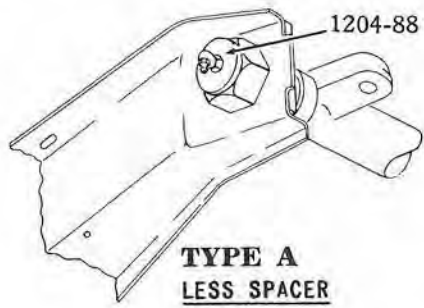

K9	531192		PIN AND BUSHING KIT, LOWER ARM OUTER PIVOT, CONSISTS OF:	10G, 12G, 14G, H, 3H, 4H	2
			1-518431 PIN 2-199385 SEAL		
			2-529280 BUSHING 1-510141 KEY		
K12	531193		SHAFT AND BUSHING KIT, LOWER ARM INNER - NOTE 3 - CONSISTS OF:	10G, 12G, H, 3H.	2
			1-527975 SHAFT 2-517126 SEAL		
			2-529263 BUSHING 2-730-02 FITTING		
1204-61	527916		ARM, LOWER RIGHT, KNUCKLE CONTROL } NOTE 4	10G, 12G, H, 3H.	1
	527917		ARM, LOWER LEFT, KNUCKLE CONTROL }	10G, 12G, H, 3H.	1
	532182		ARM, LOWER RIGHT, KNUCKLE CONTROL	14G, 4H.	1
1204-61	532183		ARM, LOWER LEFT, KNUCKLE CONTROL.	14G, 4H.	1
1204-64	527972		SUPPORT, RIGHT, LOWER CONTROL ARM TO KING PIN } NOTE 6	10G, 12G, 14G, H, 3H, 4H	1
	527973		SUPPORT, LEFT, LOWER CONTROL ARM TO KING PIN }	10G, 12G, 14G, H, 3H, 4H	1
	533764		SUPPORT, RIGHT, LOWER CONTROL ARM TO KING PIN } NOTE 7	14G, 4H.	1
1204-64	533765		SUPPORT, LEFT, LOWER CONTROL ARM TO KING PIN }	14G, 4H.	1
	----		KEY, WOODRUFF, TO KING PIN 1/4"X7/8"	10G, 12G, 14G, H, 3H, 4H	2
1204-68	518431		PIN, LOWER CONTROL ARM PIVOT } INCL. IN 531192 KIT	10G, 12G, 14G, H, 3H, 4H	2
1204-70	510141		KEY, TAPER, TO KING PIN }	10G, 12G, 14G, H, 3H, 4H	2
1204-74	529280		BUSHING AND GREASE FITTING, OUTER, LOWER CONTROL ARM (INCL. IN 531192 KIT)	10G, 12G, 14G, H, 3H, 4H	4

- NOTES**
- 3 - USED WITH TYPE A ARMS (SEE CUT) ON ALL CARS EXCEPT THOSE REFERRED TO IN NOTE 4.
 - 4 - WHEN REPLACING TYPE B ARM (SEE CUT) BETWEEN CAR SERIALS G-1,090,825 THRU G-1,092,305 AND 8,192,843 THRU 8,194,338 ALSO ORDER 529263 BUSHINGS.
 - 6 - USED WITH KING PINS HAVING FORGING NO. 527978 OR 527979 ON MODELS 14G 4H
 SO. BEND G-1,210,056 | 8,298,538
 CANADA G-746,837 | 8,955,673
 - 7 - USED WITH KING PINS HAVING FORGING NO. 533762 OR 533763 ON AND AFTER CAR SERIALS IN NOTE 6.

FRONT AXLE

1204

ILLUST. NUMBER	PART NUMBER	CHANGE	DESCRIPTION	MODELS	PRI CAR
1204- STEERING KNUCKLE CONTROL ARM-Cont'd. (Plate 12-2)					
LOWER CONTROL ARM, SUPPORT, PIN, SHAFT, ETC.-Cont'd.					
1204-79	199385		SEAL, LOWER CONTROL ARM OUTER BUSHING (INCL. IN 531192 KIT)	10G, 12G, 14G, H, 3H, 4H	4
1204-85	527975		SHAFT, LOWER CONTROL ARM PIVOT (INCL. IN 531193 KIT)	10G, 12G, H, 3H.	2
1204-85	532188		SHAFT, LOWER CONTROL ARM PIVOT.	14G, 4H.	2
	2-0724		BOLT, TO CROSSMEMBER 7/16"-20X1 1/2"	10G, 12G, 14G, H, 3H, 4H	8
	911882X8		NUT, HEX. 7/16"-20.	10G, 12G, 14G, H, 3H, 4H	8
1204-88	529263		BUSHING LESS GREASE FITTING, LOWER CONTROL ARM INNER SHAFT - NOTE 3 (INCL. IN 531193 KIT)	10G, 12G, H, 3H.	4
1204-88	526468		BUSHING LESS GREASE FITTING, LOWER CONTROL ARM INNER SHAFT - NOTE 5	10G, H	4
1204-88	533164		BUSHING, LOWER CONTROL ARM INNER SHAFT.	14G, 4H.	4
1204-89	730-02		GREASE FITTING (INCL. IN 531193 KIT)	10G, 12G, H, 3H.	4
1204-90	517126		SEAL, LOWER CONTROL ARM INNER SHAFT BUSHING GREASE (INCL. IN 531193 KIT)	10G, 12G, H, 3H.	4
1204-91	532190		RETAINER, LOWER CONTROL ARM INNER SHAFT BUSHING	14G, 4H.	4
1204-93	2-0820		SCREW, TO SHAFT 1/2"-20X1 1/4"	14G, 4H.	4
	----		WASHER, LOCK 1/2"	14G, 4H.	4
1204-98	526337		BUMPER, UPPER CONTROL ARM REBOUND - STEEL AND RUBBER.	10G, 12G, 14G, H, 3H, 4H	2
1204-99	185981		PLATE, LOCK, TO FRAME.	10G, 12G, 14G, H, 3H, 4H	2
	----		BRACKET, LOWER CONTROL ARM JOUNCE BUMPER - SEE GROUP 1507	10G, 12G, 14G, H, 3H, 4H	2
1204-108	524230		BUMPER, LOWER CONTROL ARM JOUNCE - STEEL AND RUBBER	10G, 12G, 14G, H, 3H, 4H	2
	264-06		NUT, HEX. 3/8"-24.	10G, 12G, 14G, H, 3H, 4H	2

1205- STEERING KNUCKLE CONTROL ARM STABILIZER

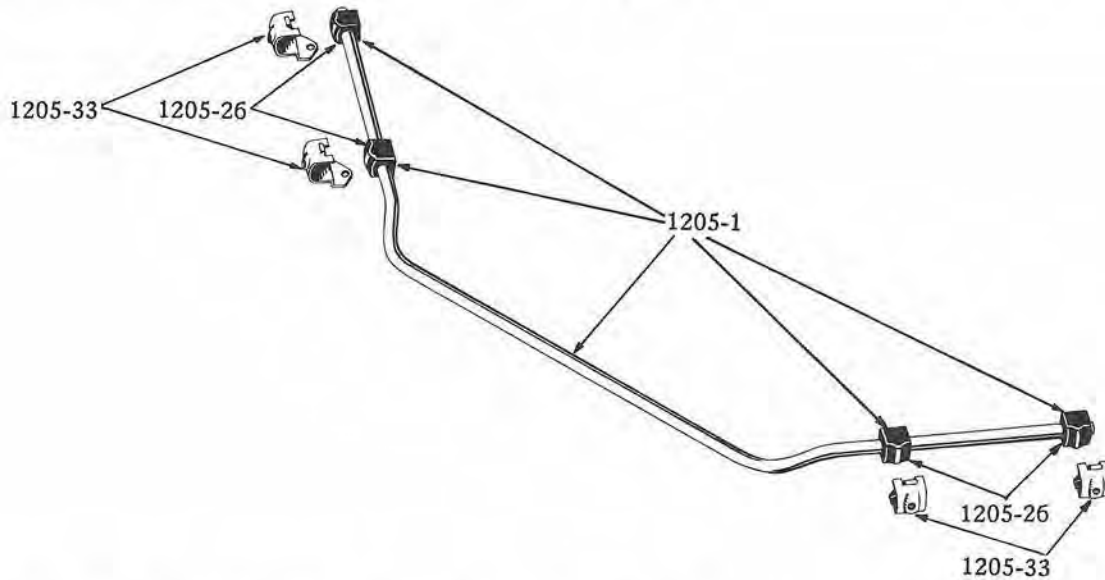

1205-1	530354		SHAFT W/BUSHINGS, STEERING KNUCKLE CONTROL ARM STABILIZER	10G, 12G, H, 3H.	1
1205-1	532191		SHAFT W/BUSHINGS, STEERING KNUCKLE CONTROL ARM STABILIZER	14G, 4H.	1
1205-26	529392		BUSHING, STABILIZER SHAFT - RUBBER.	10G, 12G, 14G, H, 3H, 4H	4

NOTES { 3 - USED WITH TYPE A ARMS (SEE CUT) ON ALL CARS EXCEPT THOSE REFERRED TO IN NOTE 2.
5 - USED ONLY WITH TYPE B ARMS - SEE CAR SERIALS IN NOTE 4.

FRONT AXLE

1209

ILLUST. NUMBER	PART NUMBER	CHANGE	DESCRIPTION	MODELS	PRI CAR
1205- STEERING KNUCKLE CONTROL ARM STABILIZER-Cont'd.					
1205-33	529391		RETAINER, STABILIZER SHAFT BUSHING.	10G, 12G, 14G, H, 3H, 4H	4
	2-0516		BOLT, TO ARM 5/16"-24X1"	10G, 12G, 14G, H, 3H, 4H	4
	252-05		NUT, HEX. 5/16"-24.	10G, 12G, 14G, H, 3H, 4H	4
	380-05		WASHER, LOCK 5/16".	10G, 12G, 14G, H, 3H, 4H	4
1207- STEERING KNUCKLE TIE ROD AND ENDS (Plate 12-3)					
	529248		ROD W/ENDS, KNUCKLE TIE - U.S.A.	10G, 12G, 14G, H, 3H, 4H	2
	531206		ROD W/ENDS, KNUCKLE TIE - CANADA.	10G, 12G, 14G, H, 3H, 4H	2
	260-08		NUT, BALL STUD 1/2"-20	10G, 12G, 14G, H, 3H, 4H	4
	----		COTTER 3/32"X1"	10G, 12G, 14G, H, 3H, 4H	4
1207-3	527977		ROD ONLY, KNUCKLE TIE	10G, 12G, 14G, H, 3H, 4H	2
1207-5	510487		CLAMP, KNUCKLE TIE ROD.	10G, 12G, 14G, H, 3H, 4H	4
	2-0524		BOLT, CLAMPING 5/16"-24X1 1/2"	10G, 12G, 14G, H, 3H, 4H	4
	252-05		NUT, HEX. 5/16"-24.	10G, 12G, 14G, H, 3H, 4H	4
	380-05		WASHER, LOCK 5/16".	10G, 12G, 14G, H, 3H, 4H	4
1207-12	530203		END, OUTER RIGHT, INNER LEFT (HAS RH THD.) - U.S.A. } INCL.	10G, 12G, 14G, H, 3H, 4H	2
1207-13	530204		END, INNER RIGHT, OUTER LEFT (HAS LH THD.) - U.S.A. } NUT	10G, 12G, 14G, H, 3H, 4H	2
	531210		END, OUTER RIGHT, INNER LEFT (HAS RH THD.) - CANADA } AND	10G, 12G, 14G, H, 3H, 4H	2
	531211		END, INNER RIGHT, OUTER LEFT (HAS LH THD.) - CANADA } SEAL	10G, 12G, 14G, H, 3H, 4H	2
	718-04		GREASE FITTING	10G, 12G, 14G, H, 3H, 4H	4
1207-35	530202		SEAL, TIE ROD END BALL STUD	10G, 12G, 14G, H, 3H, 4H	4
1209- STEERING BELL CRANK AND LEVER (Plate 12-3)					
1209-1	527980		BELL CRANK, STEERING - LHC.	10G, 12G, 14G, H, 3H, 4H	1
	530426		BELL CRANK, STEERING - RHC.	10G, 12G, 14G, H, 3H, 4H	1
	4-0644		BOLT, CLAMPING 3/8"-24X1 3/4".	10G, 12G, 14G, H, 3H, 4H	1
	197402		NUT, HEX. 3/8"-24	10G, 12G, 14G, H, 3H, 4H	1
	380-06		WASHER, LOCK 3/8".	10G, 12G, 14G, H, 3H, 4H	1
1209-10	529239		SHAFT AND WASHER, BELL CRANK.	10G, 12G, 14G, H, 3H, 4H	1
	639040		NUT, HEX. 5/8"-18.	10G, 12G, 14G, H, 3H, 4H	1
	----		COTTER 1/8"X1 1/8".	10G, 12G, 14G, H, 3H, 4H	1
1209-14	529237		BRACKET W/BEARINGS, BELL CRANK.	10G, 12G, 14G, H, 3H, 4H	1
1209-18	526473		GREASE FITTING, BELL CRANK	10G, 12G, 14G, H, 3H, 4H	1
	2-0662		BOLT, LONG, TO CROSS MEMBER 3/8"-24X3 7/8".	10G, 12G, 14G, H, 3H, 4H	2
	2-0624		BOLT, SHORT, TO CROSS MEMBER 3/8"-24X1 1/2".	10G, 12G, 14G, H, 3H, 4H	2
	252-06		NUT, HEX. 3/8"-24	10G, 12G, 14G, H, 3H, 4H	4
	----		WASHER, PLAIN 3/8".	10G, 12G, 14G, H, 3H, 4H	2
	380-06		WASHER, LOCK 3/8".	10G, 12G, 14G, H, 3H, 4H	4
1209-23	525013		BEARING, BELL CRANK BRACKET	10G, 12G, 14G, H, 3H, 4H	2
1209-26	525007		SEAL, BELL CRANK BRACKET.	10G, 12G, 14G, H, 3H, 4H	1
1209-31	525001		THRUST WASHER, LOWER, BELL CRANK.	10G, 12G, 14G, H, 3H, 4H	1
			THICKNESS		
1209-36	525002		SHIM, BELL CRANK ADJUSTING.	10G, 12G, 14G, H, 3H, 4H	*
1209-36	525003		SHIM, BELL CRANK ADJUSTING.	10G, 12G, 14G, H, 3H, 4H	*
1209-36	525004		SHIM, BELL CRANK ADJUSTING.	10G, 12G, 14G, H, 3H, 4H	*
1209-36	525005		SHIM, BELL CRANK ADJUSTING.	10G, 12G, 14G, H, 3H, 4H	*
1209-36	525006		SHIM, BELL CRANK ADJUSTING.	10G, 12G, 14G, H, 3H, 4H	*

NOTE { * - USE AS REQUIRED.