

# PROPELLER SHAFT

# Plate 09-1

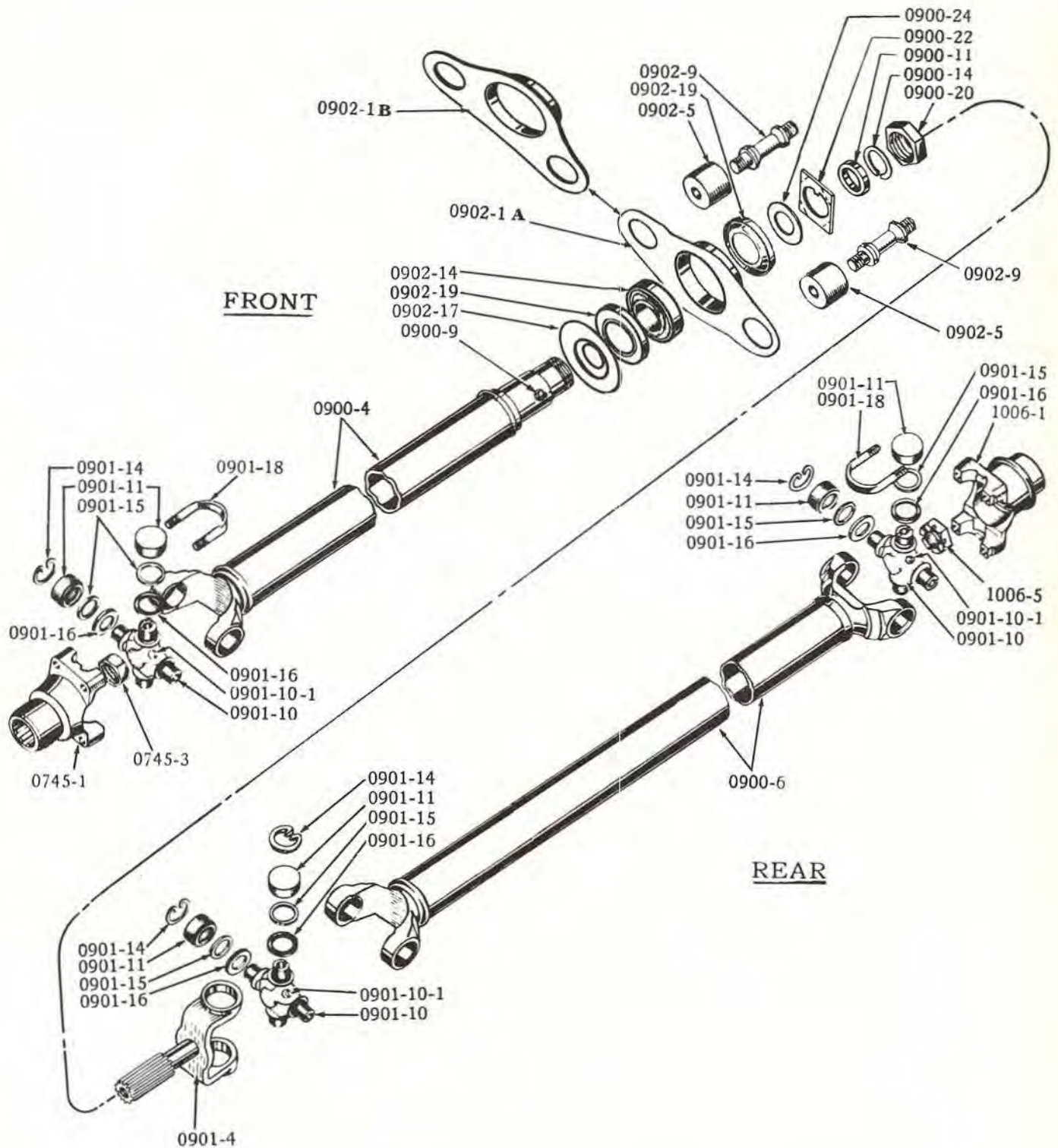

## PROPELLER SHAFTS, UNIVERSAL JOINTS and SUPPORT

0900

# PROPELLER SHAFT

ILLUST. NUMBER	PART NUMBER	CHANGE	DESCRIPTION	MODELS	PER CAR
----------------	-------------	--------	-------------	--------	---------

## 0900- PROPELLER SHAFT (Plate 09-1)

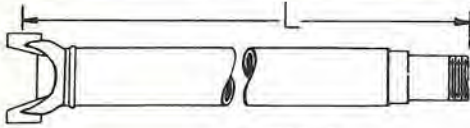

**TYPE A**

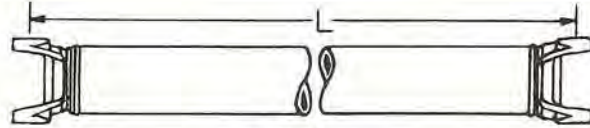

**TYPE B**

LENGTH SHOWN IS FOR THE SHAFT ONLY - AS ILLUSTRATED ABOVE.

				TYPE LENGTH		
0900-4	529002	SHAFT AND YOKE, FRONT - WITH ST.	. . . . .	A. 37 3/32"	10G, 12G	1
0900-4	529003	SHAFT AND YOKE, FRONT - WITH OD.	. . . . .	A. 28 25/32"	10G, 12G	1
0900-4	530244	SHAFT AND YOKE, FRONT - WITH AD.	. . . . .	A. 30 21/32"	10G, 12G	1
0900-4	532213	SHAFT AND YOKE, FRONT - WITH ST. - EXCEPT C-K	. . . . .	A. 31 7/16"	14G	1
0900-4	532211	SHAFT AND YOKE, FRONT - WITH ST. - C-K.	. . . . .	A. 25 21/32"	14G	1
0900-4	532208	SHAFT AND YOKE, FRONT - WITH OD. - EXCEPT C-K	. . . . .	A. 23 3/32"	14G	1
0900-4	532205	SHAFT AND YOKE, FRONT - WITH OD. - C-K.	. . . . .	A. 17 9/32"	14G	1
0900-4	532210	SHAFT AND YOKE, FRONT - WITH AD. - EXCEPT C-K	. . . . .	A. 25"	14G	1
0900-4	532206	SHAFT AND YOKE, FRONT - WITH AD. - C-K.	. . . . .	A. 19 3/16"	14G	1
0900-4	529008	SHAFT AND YOKE, FRONT - WITH ST.	. . . . .	A. 35 15/32"	H, 3H	1
0900-4	529009	SHAFT AND YOKE, FRONT - WITH OD.	. . . . .	A. 27 13/32"	H, 3H	1
0900-4	530244	SHAFT AND YOKE, FRONT - WITH AD.	. . . . .	A. 30 21/32"	H, 3H	1
0900-4	532212	SHAFT AND YOKE, FRONT - WITH ST. - EXCEPT C-K	. . . . .	A. 29 25/32"	4H	1
0900-4	532209	SHAFT AND YOKE, FRONT - WITH ST. - C-K.	. . . . .	A. 24"	4H	1
0900-4	532207	SHAFT AND YOKE, FRONT - WITH OD. - EXCEPT C-K	. . . . .	A. 21 3/4"	4H	1
0900-4	532204	SHAFT AND YOKE, FRONT - WITH OD. - C-K.	. . . . .	A. 15 15/16"	4H	1
0900-4	532210	SHAFT AND YOKE, FRONT - WITH AD. - EXCEPT C-K	. . . . .	A. 25"	4H	1
0900-4	532206	SHAFT AND YOKE, FRONT - WITH AD. - C-K.	. . . . .	A. 19 3/16"	4H	1
0900-6	529005	SHAFT AND YOKES, REAR	. . . . .	B. 32 23/32"	10G, 12G	1
0900-6	532235	SHAFT AND YOKES, REAR - W-F	. . . . .	B. 39 23/32"	14G	1
0900-6	532237	SHAFT AND YOKES, REAR - C-K	. . . . .	B. 43 21/32"	14G	1
0900-6	529011	SHAFT AND YOKES, REAR - EXCEPT Y.	. . . . .	B. 32 1/32"	H, 3H	1
0900-6	529013	SHAFT AND YOKES, REAR - Y	. . . . .	B. 36 11/32"	H, 3H	1
0900-6	532234	SHAFT AND YOKES, REAR - EXCEPT Y-C-K.	. . . . .	B. 39"	4H	1
0900-6	532236	SHAFT AND YOKES, REAR - Y-C-K	. . . . .	B. 42 15/16"	4H	1
0900-9	718-04	GREASE FITTING, SHAFT SLEEVE	. . . . .		10G, 12G, 14G, H, 3H, 4H	1
0900-11	522053	WASHER, SHAFT SLEEVE GREASE	. . . . .		10G, 12G, 14G, H, 3H, 4H	1
0900-14	522054	RETAINER, SHAFT GREASE WASHER	. . . . .		10G, 12G, 14G, H, 3H, 4H	1
0900-20	522051	NUT, SHAFT SLEEVE GREASE WASHER/OR CAP.	. . . . .		10G, 12G, 14G, H, 3H, 4H	1
0900-22	522052	LOCK PLATE, NUT.	. . . . .		10G, 12G, 14G, H, 3H, 4H	1
0900-24	527024	SPACER, LOCK PLATE.	. . . . .		10G, 12G, 14G, H, 3H, 4H	1

## 0901- UNIVERSAL JOINT (Plate 09-1)

0901-4	526944	YOKE, UNIVERSAL JOINT SLIP.	. . . . .		10G, 12G, 14G, H, 3H, 4H	1
--------	--------	-----------------------------	-----------	--	--------------------------	---

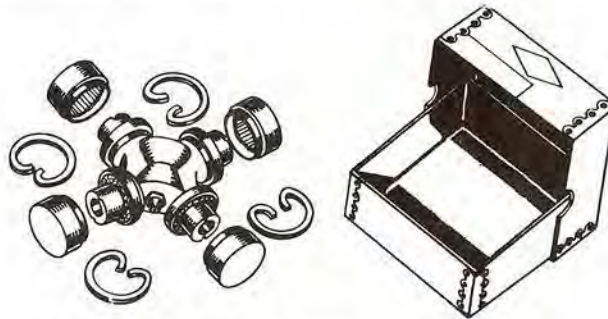

**CROSS AND BEARING UNIT**

516059	CROSS AND BEARINGS UNIT, UNIVERSAL JOINT - CONSISTS OF:					
	1-CROSS, 4-BEARINGS AND 4-SNAP RINGS	. . . . .			10G, 12G, 14G, H, 3H, 4H	2

## PROPELLER SHAFT

0902

ILLUST. NUMBER	PART NUMBER	CHANGE ✓	DESCRIPTION	MODELS	PER CAR
<b>0901- UNIVERSAL JOINT-Cont'd. (Plate 09-1)</b>					
0901-10	----		CROSS, UNIVERSAL JOINT (FURNISHED ONLY IN 516059 CROSS AND BEARINGS UNIT) . . . . .	10G, 12G, 14G, H, 3H, 4H	3
0901-10-1	718-04		GREASE FITTING, CROSS. . . . .	10G, 12G, 14G, H, 3H, 4H	3
0901-11	----		BEARING, UNIVERSAL JOINT CROSS (FURNISHED ONLY IN 516059 CROSS AND BEARINGS UNIT) . . . . .	10G, 12G, 14G, H, 3H, 4H	3
0901-14	182540		SNAP RING, UNIVERSAL JOINT CROSS BEARING. . . . .	10G, 12G, 14G, H, 3H, 4H	8
0901-15	182539		WASHER, UNIVERSAL JOINT CROSS BEARING . . . . .	10G, 12G, 14G, H, 3H, 4H	12
0901-16	182538		RETAINER, UNIVERSAL JOINT CROSS BEARING . . . . .	10G, 12G, 14G, H, 3H, 4H	12
0901-18	187425		CLIP, UNIVERSAL JOINT CROSS BEARING . . . . .	10G, 12G, 14G, H, 3H, 4H	4
	252-05		NUT, TO FLANGE 5/16"-24. . . . .	10G, 12G, 14G, H, 3H, 4H	8
	380-05		WASHER, LOCK 5/16". . . . .	10G, 12G, 14G, H, 3H, 4H	8
	----		FLANGE, TRANSMISSION UNIVERSAL JOINT - SEE GROUP 0745 . . . . .	10G, 12G, 14G, H, 3H, 4H	1
	----		FLANGE, REAR AXLE UNIVERSAL JOINT - SEE GROUP 1006. . . . .	10G, 12G, 14G, H, 3H, 4H	1
<b>0902- PROPELLER SHAFT SUPPORT (Plate 09-1)</b>					
0902-1A	526842		SUPPORT, SHAFT. . . . .	10G, H . . . . .	1
0902-1A	531746		SUPPORT, SHAFT. . . . .	12G, 3H. . . . .	1
0902-1B	532009		SUPPORT, SHAFT. . . . .	14G, 4H. . . . .	1
0902-5	519175		CUSHION, SHAFT SUPPORT . . . . .	10G, 12G, 14G, H, 3H, 4H	2
0902-9	524184		STUD, TO FRAME 3/8"-24-24X2 3/16". . . . .	10G, 12G, 14G, H, 3H, 4H	2
	252-06		NUT, HEX. 3/8"-24 . . . . .	10G, 12G, 14G, H, 3H, 4H	4
	----		WASHER, PLAIN 3/8". . . . .	10G, 12G, 14G, H, 3H, 4H	2
	380-06		WASHER, LOCK 3/8". . . . .	10G, 12G, 14G, H, 3H, 4H	4
0902-14	664443		BEARING, SHAFT SUPPORT. . . . .	10G, 12G, 14G, H, 3H, 4H	1
0902-17	530421		DUST SHIELD, OUTER, SUPPORT BEARING . . . . .	10G, 12G, 14G, H, 3H, 4H	1
0902-19	531016		DUST SHIELD, INNER, SUPPORT BEARING . . . . .	10G, 12G, 14G, H, 3H, 4H	2