

**RADIATOR, FAN and WATER PUMP - Model 4H**

# Plate 05-8

# COOLING

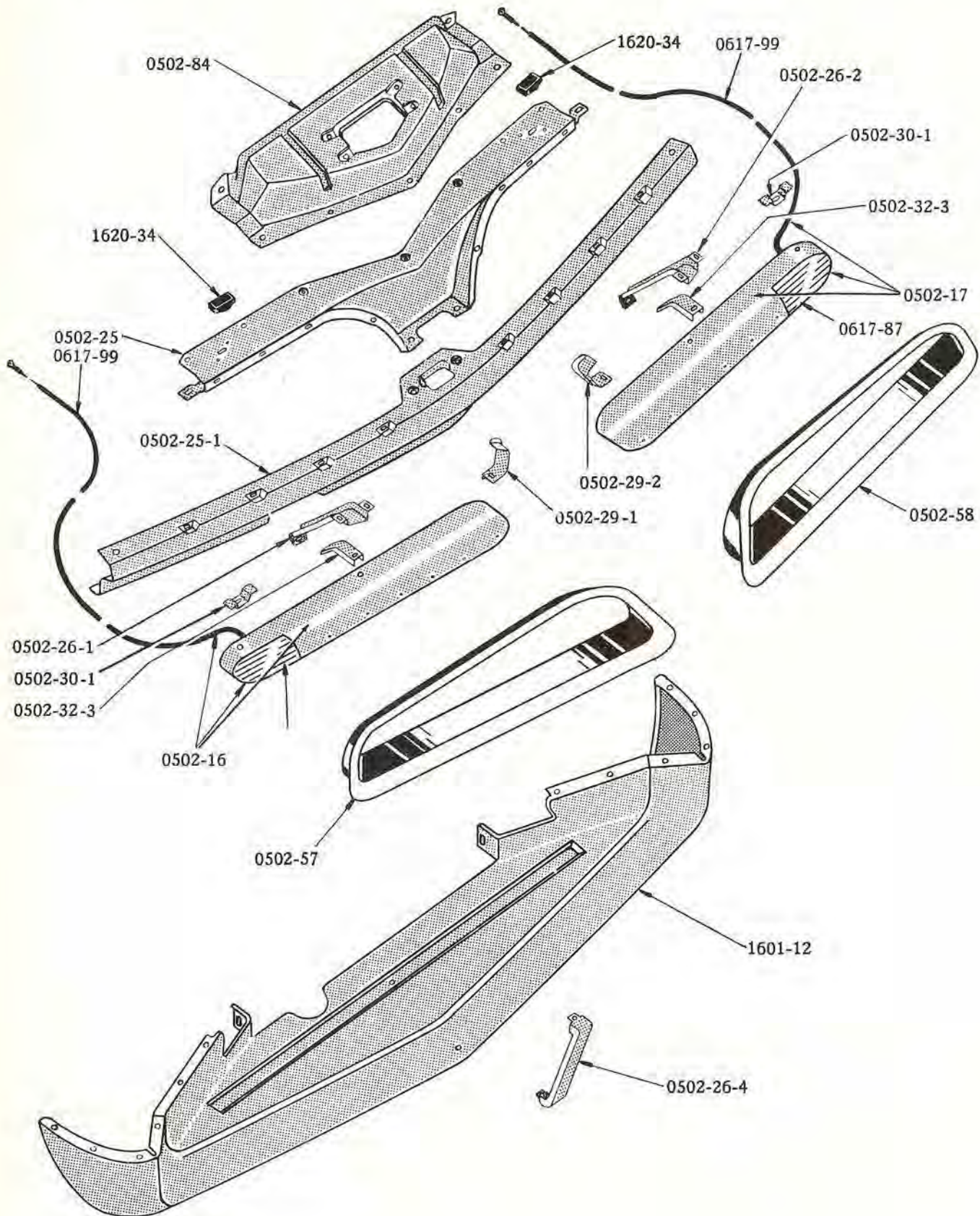

## RADIATOR GRILLE - MODELS 14G, 4H (C-K)

# COOLING

0502

ILLUST. NUMBER	PART NUMBER	CHANGE	DESCRIPTION	MODELS	PER CAR
<b>0501- RADIATOR CORE AND FILLER CAP</b> (Plates 05-1,2,3,4)					
	AC-2182		CLEANER KIT, RADIATOR AND WATER (CONSISTS OF CLEANER, BRACKET, CONNECTING AND FASTENING PARTS. . . . .	10G, 12G, 14G, H, 3H, 4H	1
	AC-2183		CARTRIDGE KIT, RADIATOR AND WATER CLEANER (CONSISTS OF CARTRIDGE AND GASKET). . . . .	10G, 12G, 14G, H, 3H, 4H	1
0501-1	530221		CORE, RADIATOR. . . . .	10G . . . . .	1
0501-1	531816		CORE, RADIATOR. . . . .	12G . . . . .	1
0501-1	532299		CORE, RADIATOR. . . . .	14G . . . . .	1
0501-1	530216		CORE, RADIATOR - LHC. . . . .	H . . . . .	1
	530416		CORE, RADIATOR - RHC. . . . .	H . . . . .	1
0501-1	531822		CORE, RADIATOR - LHC. . . . .	3H. . . . .	1
	531823		CORE, RADIATOR - RHC. . . . .	3H. . . . .	1
0501-1	532041		CORE, RADIATOR - LHC. . . . .	4H. . . . .	1
	533091		CORE, RADIATOR - RHC. . . . .	4H. . . . .	1
0501-4	199952		CAP, RADIATOR FILLER. . . . .	10G, H . . . . .	1
0501-4	516009		CAP, RADIATOR FILLER (PRESSURE TYPE). . . . .	10G, H . . . . .	1
0501-4	531826		CAP, RADIATOR FILLER (PRESSURE TYPE). . . . .	12G, 14G, 3H, 4H . . . . .	1
0501-9	680171		COCK, RADIATOR DRAIN. . . . .	10G, 12G, H, 3H. . . . .	1
0501-9	587-04		COCK, RADIATOR DRAIN. . . . .	14G, 4H. . . . .	1
<b>0502- RADIATOR GRILLE</b> (Plates 05-5,6,7,8)					
	296220		GRILLE, RADIATOR - LESS EXTENSIONS (CONSISTS OF: GRILLE BARS, FINS, BRACES AND LOWER AIR DEFLECTOR) . . . . .	12G, 3H. . . . .	1
0501-14	293232WP		GRILLE, RIGHT, RADIATOR. . . . .	10G, H . . . . .	1
0502-15	293233WP		GRILLE, LEFT, RADIATOR. . . . .	10G, H . . . . .	1
	632-#8-14W		BOLT, TO PANEL NO. 8X7/8" . . . . .	10G, H . . . . .	12
	1622X1		SPEED NUT FOR #8 BOLT . . . . .	10G, H . . . . .	12
0502-16	298212	●	BAR ASSEMBLY, RIGHT, RADIATOR GRILLE. . . . .	14G, 4H. . . . .	1
0502-17	298213	●	BAR ASSEMBLY, LEFT, RADIATOR GRILLE . . . . .	14G, 4H. . . . .	1
	1960X2		BOLT, TO INNER BRACKET 1/4"-20X5/8" . . . . .	14G, 4H. . . . .	2
	189-0410		BOLT, TO CENTER BRACKET 1/4"-20X5/8" . . . . .	14G, 4H. . . . .	2
	189-0410		BOLT, TO OUTER BRACKET 1/4"-20X5/8" - EXCEPT C-K . . . . .	14G, 4H. . . . .	2
	1960X2		BOLT, TO OUTER BRACKET 1/4"-20X5/8" - C-K. . . . .	14G, 4H. . . . .	2
	1578X10		NUT 1/4"-20 . . . . .	14G, 4H. . . . .	6
● INCLUDES PARKING AND DIRECTIONAL SIGNAL W/CABLE. SEE GROUPS 0617 AND 0621 FOR LAMP DETAILS.					
0502-18	296221W		BAR, UPPER, RADIATOR GRILLE . . . . .	12G, 3H. . . . .	1
0502-19-1	296986		BAR, CENTER RIGHT, RADIATOR GRILLE. . . . .	12G, 3H. . . . .	1
0502-19-2	296987		BAR, CENTER LEFT, RADIATOR GRILLE . . . . .	12G, 3H. . . . .	1
0502-20	296196W		BAR, LOWER, RADIATOR GRILLE . . . . .	12G, 3H. . . . .	1
	653-0510		SCREW, UPPER BAR TO FENDER 5/16"-18X5/8" . . . . .	12G, 3H. . . . .	2
	367-05		WASHER, PLAIN 5/16" . . . . .	12G, 3H. . . . .	2
	653-0418		SCREW, CENTER BAR TO INNER FINS 1/4"-20X1 1/8" . . . . .	12G, 3H. . . . .	2
	----		SCREW, CENTER BAR TO OUTER FINS 1/4"-20X1/2" . . . . .	12G, 3H. . . . .	4
	653-0510		SCREW, LOWER TO UPPER BAR 5/16"-18X5/8" . . . . .	12G, 3H. . . . .	2
	1905X14		BOLT, UPPER BAR TO FENDER 5/16"-18X5/8" . . . . .	12G, 3H. . . . .	4
	1578X23		SPEED NUT 5/16" . . . . .	12G, 3H. . . . .	4
0502-20-1	296194W		EXTENSION, RIGHT, RADIATOR GRILLE BAR . . . . .	12G, 3H. . . . .	1
0502-20-2	296195W		EXTENSION, LEFT, RADIATOR GRILLE BAR. . . . .	12G, 3H. . . . .	1
	653-0510		SCREW, FENDER TO EXTENSION 5/16"-18X5/8" . . . . .	12G, 3H. . . . .	8
	367-05		WASHER, PLAIN 5/16" . . . . .	12G, 3H. . . . .	8
	1-0518		BOLT, EXTENSION TO LOWER BAR 5/16"-18X1 1/8" . . . . .	12G, 3H. . . . .	6
	251-05		NUT, HEX. 5/16"-18. . . . .	12G, 3H. . . . .	6
	367-05		WASHER, PLAIN 5/16" . . . . .	12G, 3H. . . . .	*
	380-05		WASHER, LOCK 5/16" . . . . .	12G, 3H. . . . .	6

NOTE { \* - USE AS REQUIRED.

0502

## COOLING

ILLUST. NUMBER	PART NUMBER	CHANGE	DESCRIPTION	MODELS	PER CAR
<b>0502- RADIATOR GRILLE-Cont'd. (Plates 05-5,6,7,8)</b>					
0502-22-1	296230W		FIN, RIGHT, RADIATOR GRILLE LOWER BAR . . . . .	12G. 3H. . . . .	3
0502-22-2	296231W		FIN, LEFT, RADIATOR GRILLE LOWER BAR . . . . .	12G. 3H. . . . .	3
	653-0510		SCREW, LOWER BAR TO FIN 5/16"-18X5/8". . . . .	12G. 3H. . . . .	12
0502-26-1	296488P		BRACE, RIGHT, LOWER TO UPPER GRILLE BAR . . . . .	12G. 3H. . . . .	1
0502-26-2	296489P		BRACE, LEFT, LOWER TO UPPER GRILLE BAR. . . . .	12G. 3H. . . . .	1
	163-0412		BOLT, TO UPPER BAR 1/4"-20X3/4". . . . .	12G. 3H. . . . .	4
	1904X12		BOLT, TO LOWER BAR 1/4"-20X7/8". . . . .	12G. 3H. . . . .	2
	1578X10		SPEED NUT 1/4". . . . .	12G. 3H. . . . .	6
0502-29-1	297778		BRACKET, RIGHT, INNER, RADIATOR GRILLE BAR } EXCEPT	14G. 4H. . . . .	1
0502-29-2	297779		BRACKET, LEFT, INNER, RADIATOR GRILLE BAR } C-K	14G. 4H. . . . .	1
0502-29-1	303612		BRACKET, RIGHT, INNER, RADIATOR GRILLE BAR } C-K	14G. 4H. . . . .	1
0502-29-2	303613		BRACKET, LEFT, INNER, RADIATOR GRILLE BAR } C-K	14G. 4H. . . . .	1
0502-30-1	303611		BRACKET, OUTER, RADIATOR GRILLE BAR - C-K . . . . .	14G. 4H. . . . .	2
0502-31-1	298644		BRACKET, RIGHT, OUTER, RADIATOR GRILLE BAR } EXCEPT	14G. 4H. . . . .	1
0502-31-2	298645		BRACKET, LEFT, OUTER, RADIATOR GRILLE BAR } C-K	14G. 4H. . . . .	1
	1960X1		BOLT, TO APRON 5/16"-18X5/8". . . . .	14G. 4H. . . . .	1
	1578X23		SPEED NUT 5/16"-18. . . . .	14G. 4H. . . . .	1
0502-32-1	298352		BRACKET, RIGHT, GRILLE BAR TO GRILLE PANEL BRACE } EXCEPT	14G. 4H. . . . .	1
0502-32-2	298533		BRACKET, LEFT, GRILLE BAR TO GRILLE PANEL BRACE } C-K	14G. 4H. . . . .	1
0502-32-3	303794		BRACKET, GRILLE BAR TO GRILLE PANEL BRACE - C-K . . . . .	14G. 4H. . . . .	1
	1960X2		BOLT 1/4"-20X5/8". . . . .	14G. 4H. . . . .	2
	1578X10		SPEED NUT 1/4"-20 . . . . .	14G. 4H. . . . .	2
0502-23	293230		PANEL, RADIATOR GRILLE - PRIME. . . . .	10G.H . . . . .	1
	1905X14		SCREW, TO FENDER 5/16"-18X3/4". . . . .	10G.H . . . . .	2
	1905X16		SCREW, FENDER TO PANEL 5/16"-18X3/4". . . . .	10G.H . . . . .	6
0502-23	297820P		PANEL, RADIATOR GRILLE - EXCEPT C-K . . . . .	14G. 4H. . . . .	1
0502-25	303082		PANEL, UPPER, RADIATOR GRILLE C-K . . . . .	14G. 4H. . . . .	1
0502-25-1	303084		PANEL, LOWER, RADIATOR GRILLE C-K . . . . .	14G. 4H. . . . .	1
	1905X14		SCREW, TO FENDER 5/16"-18X3/4". . . . .	14G. 4H. . . . .	4
0502-26-1	298448P		BRACE, RIGHT, GRILLE PANEL TO APRON } EXCEPT	14G. 4H. . . . .	1
0502-26-2	298449P		BRACE, LEFT, GRILLE PANEL TO APRON } C-K	14G. 4H. . . . .	1
0502-26-1	303796P		BRACE, RIGHT, GRILLE PANEL TO APRON } C-K	14G. 4H. . . . .	1
0502-26-2	303797P		BRACE, LEFT, GRILLE PANEL TO APRON } C-K	14G. 4H. . . . .	1
	189-0410		BOLT 1/4"-20X5/8". . . . .	14G. 4H. . . . .	4
	1578X10		SPEED NUT 1/4"-20. . . . .	14G. 4H. . . . .	4
0502-26-3	298379		BRACE, GRILLE PANEL TO AIR INTAKE - EXCEPT C-K. . . . .	14G. 4H. . . . .	1
0502-26-4	303103		BRACE, GRILLE PANEL TO AIR INTAKE - C-K . . . . .	14G. 4H. . . . .	1
	1960X1		BOLT 5/16"-18X5/8". . . . .	14G. 4H. . . . .	2
	1578X23		SPEED NUT 5/16"-18. . . . .	14G. 4H. . . . .	2
0502-57	297444WP		MOULDING, RIGHT, RADIATOR GRILLE PANEL. . . . .	14G. 4H. . . . .	1
0502-58	297445WP		MOULDING, LEFT, RADIATOR GRILLE PANEL . . . . .	14G. 4H. . . . .	1
0502-57	303098WP		MOULDING, RIGHT, RADIATOR GRILLE PANEL. . . . .	14G. 4H. . . . .	1
0502-58	303099WP		MOULDING, LEFT, RADIATOR GRILLE PANEL . . . . .	14G. 4H. . . . .	1
	299956		SCREW, TO FENDER AND PANEL No.10-24X3/8". . . . .	14G. 4H. . . . .	22
	163-0516		SCREW, TO FENDER 5/16"-18X1". . . . .	14G. 4H. . . . .	2
	1578X23		NUT 5/16"-18. . . . .	14G. 4H. . . . .	2
	304724		WASHER, SPECIAL - EXCEPT C-K. . . . .	14G. 4H. . . . .	6
0502-71	297800WP		NAME PLATE, RADIATOR GRILLE BAR "STUDEBAKER". . . . .	14G. 4H. . . . .	1
0502-72	297801WP		NAME PLATE, RADIATOR GRILLE BAR "CHAMPION". . . . .	14G . . . . .	1
0502-73	297802WP		NAME PLATE, RADIATOR GRILLE BAR "COMMANDER". . . . .	4H. . . . .	1
0502-73-1	298012WP		NAME PLATE, RADIATOR GRILLE BAR "LAND CRUISER". . . . .	4H. . . . .	1
	1883X12		SPEED NUT - FOR 3/32" STUD . . . . .	14G. 4H. . . . .	6
0502-79	293262W		RING, RADIATOR GRILLE PANEL ORNAMENT. . . . .	10G.H . . . . .	1
	599-049		SCREW, TO RIM 1/4"-20X9/16". . . . .	10G.H . . . . .	3

# COOLING

0504

ILLUST. NUMBER	PART NUMBER	CHANGE	DESCRIPTION	MODELS	PER CAR
<b>0502- RADIATOR GRILLE-Cont'd. (Plates 05-5,6,7,8)</b>					
0502-81	293263W		RIM, RADIATOR GRILLE PANEL ORNAMENT . . . . .	10G,H . . . . .	1
	251-04		NUT, TO GRILLE PANEL 1/4". . . . .	10G,H . . . . .	4
	369-04		WASHER, PLAIN 1/4". . . . .	10G,H . . . . .	4
	384-04		WASHER, LOCK 1/4". . . . .	10G,H . . . . .	4
0502-82	293310		RING, RADIATOR GRILLE PANEL ORNAMENT RIM - PRIME. . . . .	10G,H . . . . .	1
	145-#10-10		BOLT, CLAMPING NO.10-24X5/8" . . . . .	10G,H . . . . .	1
	1578X7		SPEED NUT . . . . .	10G,H . . . . .	1
0502-84	293694		AIR DEFLECTOR, UPPER, RADIATOR. . . . .	10G,H . . . . .	1
0502-84	296206		AIR DEFLECTOR, UPPER, RADIATOR. . . . .	12G,3H. . . . .	1
0502-84	297776		AIR DEFLECTOR, UPPER, RADIATOR - EXCEPT C-K . . . . .	14G,4H. . . . .	1
0502-84	303080		AIR DEFLECTOR, UPPER, RADIATOR - C-K. . . . .	14G,4H. . . . .	1
	----		SCREW, TO RADIATOR CORE SUPPORT 5/16"X1" . . . . .	10G,12G,14G,H,3H,4H	2
	1905X14		SCREW, TO FENDER 5/16"-18X3/4" . . . . .	12G,3H. . . . .	8
	653-0513		SCREW, TO GRILLE UPPER BAR 5/16"-18X13/16" . . . . .	12G,3H. . . . .	4
	367-05		WASHER, PLAIN 5/16" . . . . .	12G,3H. . . . .	4
	1960X20		SCREW, CENTER, TO GRILLE PANEL 5/16"X1/2". . . . .	10G,H . . . . .	2
	1905X14		SCREW, SIDE, TO GRILLE PANEL 5/16"-18X3/4" . . . . .	10G,H . . . . .	6
	1905X14		SCREW, TO GRILLE PANEL 5/16"-18X3/4" - EXCEPT C-K. . . . .	14G,4H. . . . .	6
	1905X14		SCREW, TO GRILLE PANEL 5/16"-18X3/4" - C-K . . . . .	14G,4H. . . . .	3
	1905X14		SCREW, TO FENDER APRON 5/16"-18X3/4" - EXCEPT C-K. . . . .	14G,4H. . . . .	4
	1905X14		SCREW, TO FENDER APRON 5/16"-18X3/4" - C-K . . . . .	14G,4H. . . . .	2
0502-89	296218P		DEFLECTOR, RADIATOR LOWER BAR . . . . .	12G,3H. . . . .	1
	1904X10		BOLT, TO GRILLE LOWER BAR 1/4"-20X5/8" . . . . .	12G,3H. . . . .	6
	1905X14		BOLT, TO FENDER 5/16"-18X3/4". . . . .	12G,3H. . . . .	10
	1578X23		SPEED NUT 5/16" . . . . .	12G,3H. . . . .	10
<b>0503- RADIATOR MOUNTINGS (Plates 05-1,2,3,4)</b>					
0503-8	650-058		SCREW, CORE TO SUPPORT 5/16"X1/2" . . . . .	10G,12G,H,3H. . . . .	6
	----		SCREW, CORE TO SUPPORT 5/16"-18X3/4". . . . .	14G,4H. . . . .	6
0503-10	293343	▲	SUPPORT, RADIATOR CORE - USE 296263 . . . . .	10G,H . . . . .	1
0503-10	296263		SUPPORT, RADIATOR CORE. . . . .	12G,3H. . . . .	1
0503-10	298385		SUPPORT, RADIATOR CORE - EXCEPT C-K . . . . .	14G,4H. . . . .	1
0503-10	303446		SUPPORT, RADIATOR CORE - C-K. . . . .	14G,4H. . . . .	1
	304703		SPACER, RADIATOR CORE SUPPORT - C-K . . . . .	14G,4H. . . . .	1
	293686		BOLT, TO FRAME 3/8"-24X4 3/4". . . . .	10G,12G,14G,H,3H,4H	2
	252-06		NUT, HEX. 3/8"-24 . . . . .	10G,12G,14G,H,3H,4H	2
	----		WASHER, PLAIN 7/16" . . . . .	10G,12G,14G,H,3H,4H	*
	380-06		WASHER, LOCK 3/8" . . . . .	10G,12G,14G,H,3H,4H	2
<b>0504- THERMOSTAT (Plates 05-1,2,3,4)</b>					
0504-1	531470		THERMOSTAT, ENGINE - STD. (OPENS AT 155° F.). . . . .	10G,12G,14G . . . . .	1
0504-1	532017		THERMOSTAT, ENGINE - HIGH (OPENS AT 177° F.). . . . .	10G,12G,14G . . . . .	1
0504-1	530490		THERMOSTAT, ENGINE - STD. (OPENS AT 155° F.). . . . .	H,3H. . . . .	1
0504-1	533247		THERMOSTAT, ENGINE - STD. (OPENS AT 155° F.). . . . .	4H. . . . .	1
0504-1	▲ 531071		THERMOSTAT, ENGINE - HIGH (OPENS AT 177° F.) USE 533257 . . . . .	H,3H. . . . .	1
0504-1	533257		THERMOSTAT, ENGINE - HIGH (OPENS AT 177° F.). . . . .	4H. . . . .	1
0504-4	196709		SPACER, THERMOSTAT . . . . .	10G,12G,14G . . . . .	1
0504-5	194658		GASKET, GARLOCK. . . . .	10G,12G,14G . . . . .	1

NOTES { ▲ - NOT AVAILABLE.  
\* - USE AS REQUIRED.

0505

# COOLING

ILLUST. NUMBER	PART NUMBER	CHANGE	DESCRIPTION	MODELS	PER CAR
<b>0505- WATER PUMP (plates 05-1, 2, 3, 4)</b>					
0505-1	515196		PUMP AND FAN HUB (ILLUST. PLATE 01-3)	10G, 12G, 14G	1
0505-4	195674		STUD, FOR PUMP AND GENERATOR ADJUSTING ARM 5/16"-18-24X1 21/32"	10G, 12G, 14G	1
	1-0526		SCREW, TO CYLINDER BLOCK 5/16"-18X1 5/8"	10G, 12G, 14G	1
	1-0516		SCREW, TO CYLINDER BLOCK 5/16"-18X1"	10G, 12G, 14G	1
	361-05		WASHER, PLAIN 5/16"	10G, 12G, 14G	1
	384-05		WASHER, LOCK 5/16"	10G, 12G, 14G	3
0505-1	527242		PUMP AND FAN HUB - BEFORE ENGINE No. } U.S.A. V-30,007 (ILLUST. H . . . . . 1		
0505-1	531169		PUMP AND FAN HUB - AFTER ENGINE No. } CANADA VC-678 PLATE 01-5) H, 3H, 4H . . . . . 1		
	1-0512		SCREW, TO WATER PUMP MANIFOLD 5/16"-18X3/4"	H, 3H, 4H	4
	495-05		GASKET, ANNULAR 5/16"	H, 3H, 4H	4
	S-574		WATER PUMP REPAIR KIT - CONSISTS OF: . . . . . 10G, 12G, 14G . . . . . 1		
			1-199953 SHAFT AND BEARING   1-194202 LOCK RING		
			1-199655 IMPELLER ASSY.   1-194412 BODY GASKET		
			1-515112 FAN HUB		
	530834		WATER PUMP REPAIR KIT - BEFORE ENGINE No. U.S.A. V-30,007: CANADA VC-678 - CONSISTS OF: . . . . . H . . . . . 1		
			1-527244 SHAFT AND BEARING   1-527246 COVER GASKET		
			1-530261 IMPELLER ASSY.   1-199945 FAN HUB		
			1-194202 LOCK RING		
	531171		WATER PUMP REPAIR KIT - AFTER ENGINE No. U.S.A. V-30,007: CANADA VC-678 - CONSISTS OF: . . . . . H, 3H, 4H . . . . . 1		
			1-527244 SHAFT AND BEARING   1-527246 COVER GASKET		
			1-530261 IMPELLER ASSY.   1-515112 FAN HUB		
			1-194202 LOCK RING		
0505-6	----		BODY, WATER PUMP (USE PUMP AND FAN HUB) . . . . . 10G, 12G, 14G . . . . . 1		
	547-06		PLUG, PIPE 3/8" . . . . . 10G, 12G, 14G . . . . . 1		
0505-6	----		COVER, WATER PUMP (USE PUMP AND FAN HUB) . . . . . H, 3H, 4H . . . . . 1		
0505-7	194412		GASKET, PUMP BODY - VELLUMOID (INCL. IN S-574 KIT) . . . . . 10G, 12G, 14G . . . . . 1		
0505-7	527246		GASKET, PUMP COVER - VELLUMOID (INCL. IN 530834 AND 531171 KITS) . . . . . H, 3H, 4H . . . . . 1		
0505-18	199953		SHAFT AND BEARING, WATER PUMP (INCL. IN S-574 KIT) . . . . . 10G, 12G, 14G . . . . . 1		
0505-18	527244		SHAFT AND BEARING, WATER PUMP (INCL. IN 530834 AND 531171 KITS) . . . . . H, 3H, 4H . . . . . 1		
0505-19	194202		LOCK RING, SHAFT (INCL. IN S-574, 530834 AND 531171 KITS) . . . . . 10G, 12G, 14G, H, 3H, 4H . . . . . 1		
0505-20	196327		SLINGER, SHAFT. . . . . 10G, 12G, 14G . . . . . 1		
0505-20	530280		SLINGER, SHAFT. . . . . H, 3H, 4H . . . . . 1		
0505-24	199655		IMPELLER, WATER PUMP (INCLUDES SEAL) (INCL. IN S-574 KIT) . . . . . 10G, 12G, 14G . . . . . 1		
0505-24	530261		IMPELLER, WATER PUMP (INCLUDES SEAL) (INCL. IN 530834 AND 531171 KITS) . . . . . H, 3H, 4H . . . . . 1		
0505-26	199512		WASHER, WATER PUMP IMPELLER SEAL - CARBON . . . . . 10G, 12G, 14G . . . . . 1		
0505-34	531380		MANIFOLD w/PLUGS, WATER PUMP. . . . . H, 3H, 4H . . . . . 1		
	547-06		PLUG, PIPE 3/8" . . . . . H, 3H, 4H . . . . . 2		
0505-37	527255		STUD, MANIFOLD AND GENERATOR ADJUSTING ARM . . . . . H, 3H, 4H . . . . . 1		
	1-0532		SCREW, TO CYLINDER BLOCK (THRU BATTERY GROUND STRAP) 5/16"-18X2" . . . . . H, 3H, 4H . . . . . 1		
	1-0528		SCREW, TO CYLINDER BLOCK 5/16"-18X1 3/4" . . . . . H, 3H, 4H . . . . . 3		
	1-0516		SCREW, TO CYLINDER BLOCK 5/16"-18X3/4" . . . . . H, 3H, 4H . . . . . 3		
	361-05		WASHER, PLAIN 5/16" . . . . . H, 3H, 4H . . . . . 5		
	380-05		WASHER, LOCK 5/16" . . . . . H, 3H, 4H . . . . . 8		
0505-40	527240		GASKET, UPPER, MANIFOLD - VELLUMOID . . . . . H, 3H, 4H . . . . . 2		
0505-42	527856		GASKET, LOWER, MANIFOLD - VELLUMOID . . . . . H, 3H, 4H . . . . . 2		

# COOLING

0506

ILLUST. NUMBER	PART NUMBER	CHANGE	DESCRIPTION	MODELS	PER CAR
----------------	-------------	--------	-------------	--------	---------

## 0506- FAN AND BELT (Plates 05-1, 2, 3, 4)

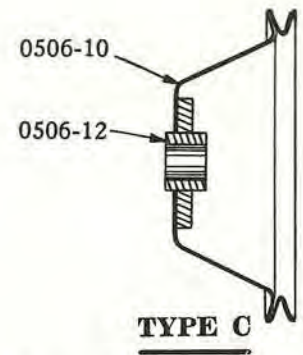
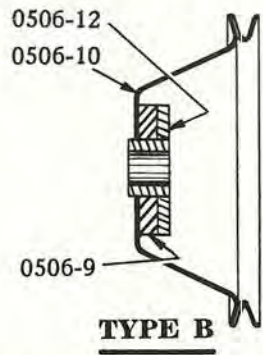
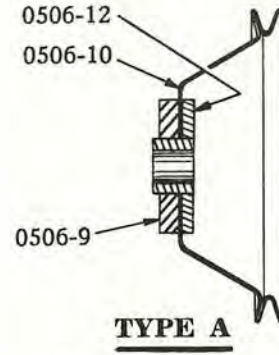

- A - LOCATION OF HUB AND SPACER WHEN USING PULLEY NO. 527256 BEFORE ENGINE NO. U.S.A. V-30,007: CANADA VC-678.
- B - LOCATION OF HUB AND SPACER WHEN USING PULLEY NO. 531162 BEFORE ENGINE NO. U.S.A. V-30,007: CANADA VC-678.
- C - LOCATION OF HUB (SPACER IS ELIMINATED) WHEN USING PULLEY NO. 531162 AFTER ENGINE NO. U.S.A. V-30,007: CANADA VC-678.

0506-6	530430P	BLADES, FAN - 4 BLADES. . . . .	10G, 12G, 14G . . . . .	1
	679622P	BLADES, FAN - 6 BLADES (FOR EXTRA COOLING). . . . .	10G, 12G, 14G . . . . .	1
0506-6	530192P	BLADES, FAN - 4 BLADES. . . . .	H, 3H, 4H . . . . .	1
	680827P	BLADES, FAN - 5 BLADES (FOR EXTRA COOLING). . . . .	H, 3H, 4H . . . . .	1
	1-0510	SCREW, TO HUB 5/16"-18X5/8" (LESS SPACER). . . . .	10G, 12G, 14G, H, 3H, 4H	4
	1-0516	SCREW, TO HUB 5/16"-18X1" (WITH SPACER). . . . .	H . . . . .	1
	380-05	WASHER, LOCK 5/16". . . . .	10G, 12G, 14G, H, 3H, 4H	4
	534341	SPACER, FAN BLADE - FOR POWER STEERING. . . . . TYPE	14G . . . . .	1
0506-9	530840	SPACER, PULLEY - BEFORE ENGINE NO. U.S.A. V-30,007: CANADA VC-678. . . . . A & B	H . . . . .	1
	1-0518	SCREW, TO HUB 5/16"-18X1 1/8" - FOR 534341 . . . . .	14G . . . . .	1
0506-10	524850	PULLEY, FAN . . . . .	10G, 12G, 14G . . . . .	1
0506-10	527256	▲ PULLEY, FAN (USE 531162 BEFORE) } ENGINE No. . . . . A	H . . . . .	1
0506-10	531162	PULLEY, FAN - BEFORE. . . . . } U.S.A. V-30,007 . . . . . B	H . . . . .	1
0506-10	531162	PULLEY, FAN - AFTER . . . . . } CANADA VC-678 . . . . . C	H, 3H, 4H . . . . .	1
0506-12	515112	HUB, FAN - AFTER. . . . . C	10G, 12G, 14G, H, 3H, 4H	1
0506-12	199945	HUB, FAN - BEFORE . . . . . A & B	H . . . . .	1
0506-20	518461	BELT, FAN . . . . .	10G, 12G, 14G . . . . .	1
0506-20	529374	BELT, FAN . . . . .	H, 3H, 4H . . . . .	1
0506-25	532372P	SHROUD, FAN - EXCEPT C-K. . . . .	14G . . . . .	1
0506-25	533186P	SHROUD, FAN - C-K . . . . .	14G . . . . .	1
0506-25	532371P	SHROUD, FAN - EXCEPT C-K. . . . .	4H . . . . .	1
0506-25	533187P	SHROUD, FAN - C-K . . . . .	4H . . . . .	1
0506-27	534336P	EXTENSION, FAN SHROUD . . . . .	14G, 4H . . . . .	1
	638-#6-6	SCREW, TO FAN SHROUD No. 6X3/8" . . . . .	14G, 4H . . . . .	5

NOTES { ▲ - NOT AVAILABLE.  
\* - USE AS REQUIRED.

0507

## COOLING

ILLUST. NUMBER	PART NUMBER	CHANGE	DESCRIPTION	MODELS	PER CAR
<b>0507- RADIATOR AND WATER PUMP HOSE AND CONNECTIONS</b>					
( Plates 05-1, 2, 3, 4 )					
0507-1	530601		HOSE, RADIATOR INLET 1 1/4" I.D. - FORMED . . . . .	10G, 12G . . . . .	1
0507-1	532430		HOSE, RADIATOR INLET 1 1/4" I.D. - FORMED - EXCEPT C-K . . . . .	14G . . . . .	1
0507-1	532431		HOSE, RADIATOR INLET 1 1/4" I.D. - FORMED - C-K . . . . .	14G . . . . .	1
0507-1	530560		HOSE, RADIATOR INLET 1 1/4" I.D. - FORMED . . . . .	H, 3H . . . . .	1
0507-1	532174		HOSE, RADIATOR INLET 1 1/4" I.D. - FORMED - EXCEPT C-K . . . . .	4H . . . . .	1
0507-1	532454		HOSE, RADIATOR INLET 1 1/4" I.D. - FORMED - C-K . . . . .	4H . . . . .	1
	472-06		CLAMP, HOSE 1 5/8" . . . . .	10G, 12G, 14G, H, 3H, 4H . . . . .	1
0507-4	530881		HOSE w/SPRING, WATER PUMP INLET 1 1/2" I.D. - FORMED . . . . .	10G, 12G . . . . .	1
0507-4	533092		HOSE w/SPRING, WATER PUMP INLET 1 1/2" I.D. - FORMED - EXCEPT C-K . . . . .	14G . . . . .	1
0507-4	533087		HOSE w/SPRING, WATER PUMP INLET 1 1/4" I.D. - FORMED - C-K . . . . .	14G . . . . .	1
0507-4	530131		HOSE w/SPRING, WATER PUMP INLET 1 1/2" I.D. - FORMED - LHC . . . . .	H, 3H . . . . .	1
0507-4	530870		HOSE w/SPRING, WATER PUMP INLET 1 1/2" I.D. - FORMED - RHC . . . . .	H, 3H . . . . .	1
0507-4	532385		HOSE w/SPRING, WATER PUMP INLET 1 1/2" I.D. - FORMED - EXCEPT C-K - LHC . . . . .	4H . . . . .	1
0507-4	532412		HOSE w/SPRING, WATER PUMP INLET 1 1/2" I.D. - FORMED - C-K - LHC . . . . .	4H . . . . .	1
0507-4	533340		HOSE w/SPRING, WATER PUMP INLET 1 1/2" I.D. - FORMED - W-F-Y-D-N - RHC . . . . .	4H . . . . .	1
	472-29		CLAMP, HOSE 1 13/16" . . . . .	10G, 12G, 14G . . . . .	2
	472-29		CLAMP, HOSE 1 13/16" . . . . .	H, 3H, 4H . . . . .	1
	472-34		CLAMP, HOSE 2 1/8" . . . . .	H, 3H, 4H . . . . .	1