

CORRECTIONS TO
CHAMPION SIX AND COMMANDER EIGHT
CHASSIS PARTS CATALOG

1951 - 1952 - 1953 SERIES

Dated July 1, 1953

Make The Following Changes

Page 69 0312-28-1 529301 SPRING, cross shaft pull back-LHC 4H 1
(change illust. number from 0312-28-1 to 0312-28-2)

Page 247 Plate 15-1
Add Models 10G,12G-H,3H

Page 248 Plate 15-2
Add Models 14G-4H

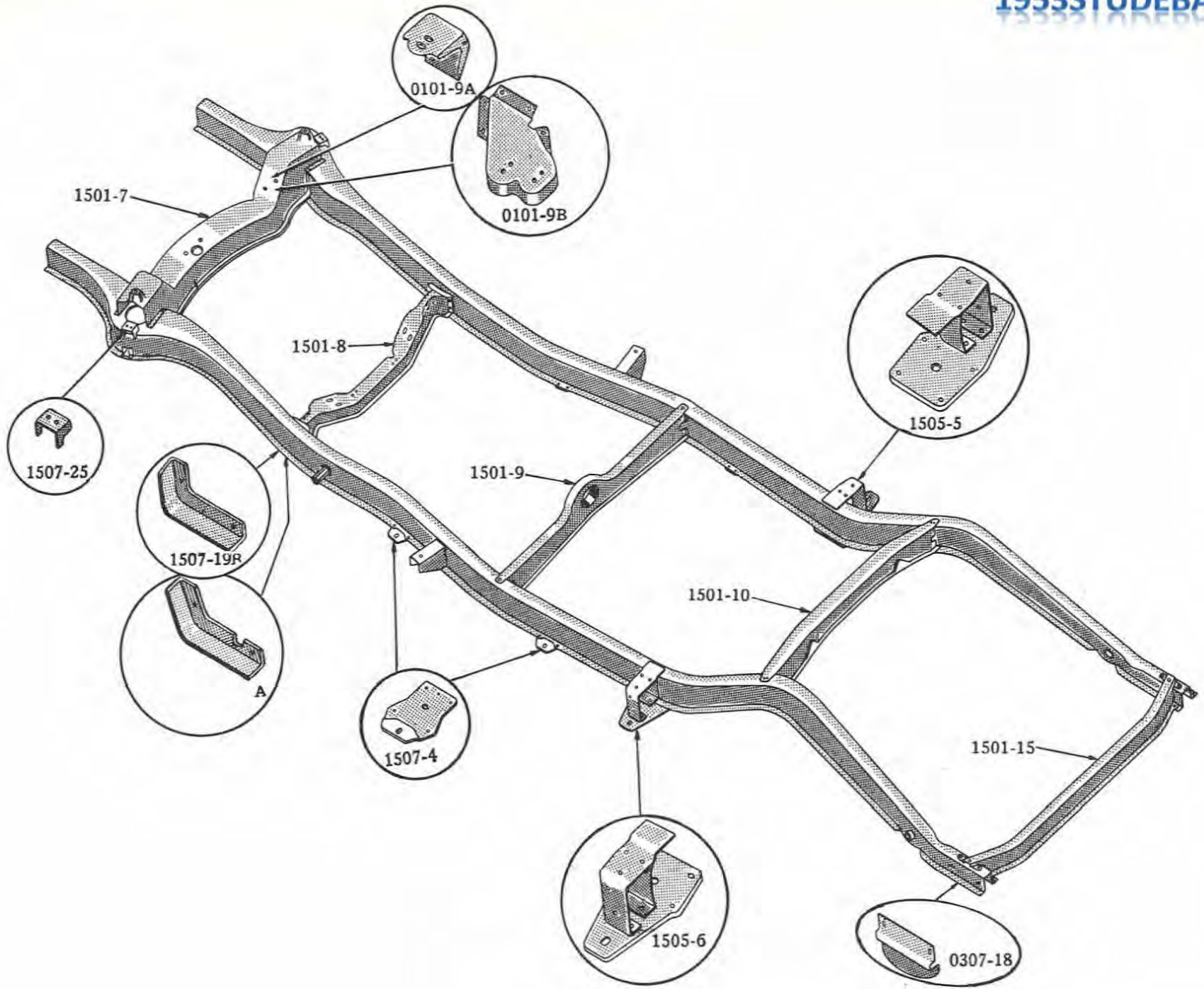

FRAME

FRAME AND SPRINGS

Plate 15-3

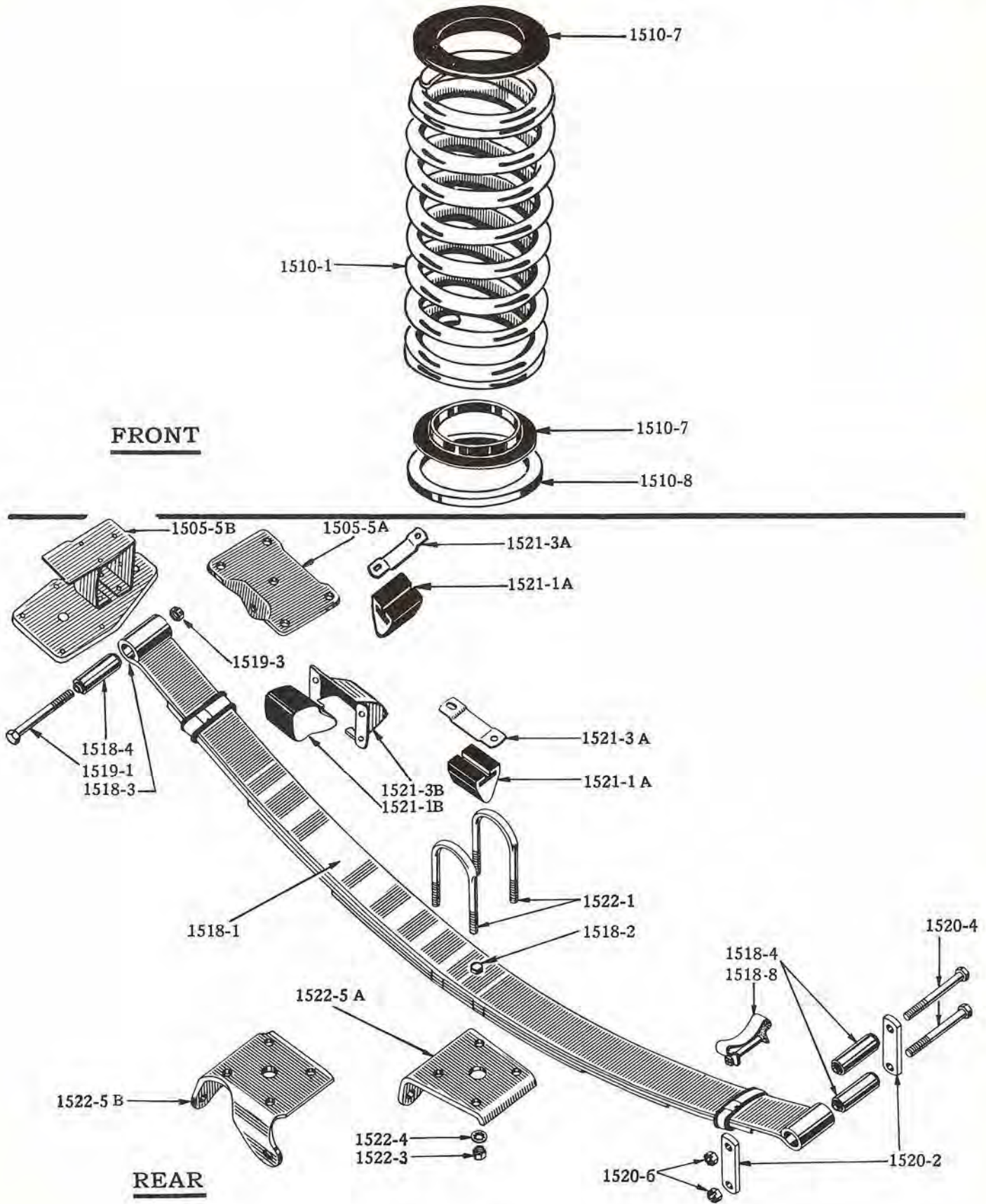

FRONT

REAR

FRONT and REAR SPRINGS

FRAME AND SPRINGS

1500

ILLUST. NUMBER	PART NUMBER	CHANGE	DESCRIPTION	MODELS	PER CAR
1500- FRAME ASSEMBLY (Plates 15-1, 2)					
FRAMES ARE FURNISHED COMPLETE WITH BODY MOUNTING BRACKETS, BUT LESS THE ENGINE PANS. THE ENGINE CROSS MEMBERS ARE INCLUDED WITH THE 14G AND 4H ONLY.					
1500-1	529160		FRAME - W-F-C-Q - LHC	10G, 12G, H, 3H.	1
	529161		FRAME - W-F-C-Q - RHC	10G, 12G, H, 3H.	1
1500-1	529162		FRAME - Y - LHC	H, 3H.	1
	529163		FRAME - Y - RHC	H, 3H.	1
1500-1	529164		FRAME - S-K - LHC	10G, 12G, H, 3H.	1
	529165		FRAME - S-K - RHC	10G, 12G, H, 3H.	1
1500-1	531908		FRAME - W-F - LHC	14G, 4H.	1
	531909		FRAME - W-F - RHC	14G, 4H.	1
1500-1	532560		FRAME - Y - LHC	4H.	1
	531911		FRAME - Y - RHC	4H.	1
1500-1	532573		FRAME - C - LHC (INCLUDES FRONT ENGINE MOUNTINGS)	14G, 4H.	1
	533112		FRAME - K - LHC	14G, 4H.	1
1501- FRAME CROSS MEMBERS (Plates 15-1, 2)					
1501-7	531152		MEMBER, FRONT CROSS	10G, 12G, H, 3H.	1
1501-7	532729		MEMBER, FRONT CROSS	14G, 4H.	1
	----		RIVET, TO FRAME 3/8"X7/8".	10G, 12G, 14G, H, 3H, 4H	4
1501-8A	529069		MEMBER, ENGINE REAR SUPPORT CROSS - EXCEPT AD	10G, 12G, H, 3H.	1
1501-8B	530136		MEMBER, ENGINE REAR SUPPORT CROSS - WITH AD	10G, 12G, H, 3H.	1
1501-8	532925		MEMBER, ENGINE REAR SUPPORT CROSS - LHC	14G, 4H.	1
1501-8	533153		MEMBER, ENGINE REAR SUPPORT CROSS - RHC	14G, 4H.	1
	2-0614		BOLT, TO FRAME 3/8"-24X7/8" } FOR 529069.	10G, 12G, H, 3H.	8
	264-06		NUT, HEX. 3/8"-24 } AND 530136.	10G, 12G, H, 3H.	8
	2-0648		BOLT, TO FRAME 3/8"-24X2 3/4"	14G, 4H.	6
	252-06		NUT, HEX. 3/8"-24 } FOR 532925.	14G, 4H.	6
	----		WASHER, PLAIN 3/8". } AND 533153.	14G, 4H.	6
	380-06		WASHER, LOCK 3/8"	14G, 4H.	6
1501-9	527806		MEMBER, PROPELLER SHAFT SUPPORT CROSS	10G, 12G, H, 3H.	1
1501-9	531916		MEMBER, PROPELLER SHAFT SUPPORT CROSS	14G, 4H.	1
	----		RIVET, TO FRAME 5/16"X3/4"	10G, 12G, 14G, H, 3H, 4H	4
1501-10	529124		MEMBER, REAR SHOCK ABSORBER CROSS	10G, 12G, H, 3H.	1
1501-10	531949		MEMBER, REAR SHOCK ABSORBER CROSS	14G, 4H.	1
	----		RIVET, TO FRAME 5/16"X3/4"	10G, 12G, 14G, H, 3H, 4H	4
1501-15	529125		MEMBER, GAS TANK CROSS.	10G, 12G, H, 3H.	1
1501-15	531951		MEMBER, GAS TANK CROSS.	14G, 4H.	1
	----		RIVET, TO FRAME 5/16"X7/8"	10G, 12G, 14G, H, 3H, 4H	8
1505- REAR SPRING HANGERS (Plates 15-1, 2, 3)					
1505-5	529167		HANGER, FRONT RIGHT, REAR SPRING - LHC.	10G, 12G, H, 3H.	1
1505-6	529166		HANGER, FRONT LEFT, REAR SPRING - LHC	10G, 12G, H, 3H.	1
	529166		HANGER, FRONT RIGHT, REAR SPRING - RHC.	10G, 12G, H, 3H.	1
	529167		HANGER, FRONT LEFT, REAR SPRING - RHC	10G, 12G, H, 3H.	1
1505-5	532108		HANGER, w/BODY BRACKET, FRONT RIGHT REAR SPRING	14G, 4H.	1
1505-6	532109		HANGER, w/BODY BRACKET, FRONT LEFT REAR SPRING.	14G, 4H.	1
	----		RIVET, TO FRAME 3/8"X1 1/8".	10G, 12G, H, 3H.	8
	----		RIVET, TO FRAME 3/8"X1".	14G, 4H.	8

FRAME AND SPRINGS

1510

ILLUST. NUMBER	PART NUMBER	CHANGE	DESCRIPTION	MODELS	PER CAR
1507- FRAME MISCELLANEOUS ATTACHMENTS (Plates 15-1, 2)					
1507-4	531215		BRACKET, FRAME BODY MOUNTING - W-Y-F-C-Q	10G, 12G, H, 3H.	3
1507-4	531215		BRACKET, FRAME BODY MOUNTING - S-K	10G, 12G, H, 3H.	7
1507-6	524767		BRACKET, FRAME BODY MOUNTING REAR - WELDED	10G, 12G, H, 3H.	2
1507-4	531215		BRACKET, FRAME BODY MOUNTING - EXCEPT K.	14G, 4H.	4
1507-4	531215		BRACKET, FRAME BODY MOUNTING - K.	14G, 4H.	6
	----		RIVET, TO FRAME 5/16"X13/16" - W-Y-F-C-Q.	10G, 12G, H, 3H.	9
	----		RIVET, TO FRAME 5/16"X13/16" - S-K.	10G, 12G, H, 3H.	21
	----		RIVET, TO FRAME 5/16"X13/16" - EXCEPT K.	14G, 4H.	16
	----		RIVET, TO FRAME 5/16"X13/16" - K.	14G, 4H.	24
1507-19	▲ 530974		SHIELD, FRAME BRAKE PEDAL SPLASH - LHC - NOTE 1 - USE 531167	10G, H.	1
1507-19	531167		SHIELD, FRAME BRAKE PEDAL SPLASH - LHC - NOTE 2.	10G, 12G, 3H.	1
1507-19A	533196		SHIELD, INNER, FRAME BRAKE PEDAL SPLASH - EXCEPT C-K - LHC	14G, 4H.	1
1507-19B	533195		SHIELD, INNER, FRAME BRAKE PEDAL SPLASH - C-K - LHC.	14G, 4H.	1
	530291		SHIELD, FRAME BRAKE PEDAL SPLASH - RHC	10G, 12G, H, 3H.	1
	533542		SHIELD, INNER, FRAME BRAKE PEDAL SPLASH - EXCEPT C-K - RHC	14G, 4H.	1
	651-#14-8		SCREW, FASTENING No. 14X1/2" - LHC.	10G, 12G, H, 3H.	3
	644-058		SCREW, TO FRAME 5/16"X1/2" - RHC.	10G, 12G, H, 3H.	1
	615-#14-8		SCREW, FASTENING No. 14X1/2".	14G, 4H.	2
	367-05		WASHER, PLAIN 5/16"	10G, 12G, H, 3H.	1
▲ - NOT AVAILABLE					
	----		SHIELD, FRAME CLUTCH PEDAL - SEE BODY PARTS CATALOG GROUP 2138.	10G, 12G, 14G, H, 3H, 4H	*
1507-25	529332		BRACKET, SUSPENSION UPPER ARM BUMPER - WELDED.	10G, 12G, 14G, H, 3H, 4H	2
1110-25	----		GUIDE, HANDBRAKE REAR CABLE - SEE GROUP 1110	10G, 12G, H, 3H.	2
1510- FRONT SPRINGS (Plate 15-2)					
THE PART NO. OF COIL SPRINGS IS STAMPED ON THE END COIL.					
1510-1	526120		SPRING, FRONT - STANDARD	10G, 12G	2
1510-1	526122		SPRING, FRONT - HEAVY DUTY	10G, 12G	2
1510-1	526120		SPRING, FRONT - STANDARD - W-F	14G	2
1510-1	526128		SPRING, FRONT - STANDARD - C-K	14G	2
1510-1	526122		SPRING, FRONT - HEAVY DUTY - W-F	14G	2
1510-1	526129		SPRING, FRONT - HEAVY DUTY - C-K	14G	2
1510-1	526124		SPRING, FRONT - STANDARD	H, 3H.	2
1510-1	526125		SPRING, FRONT - HEAVY DUTY	H, 3H.	2
1510-1	526126		SPRING, FRONT - STANDARD - W-F-Y	4H.	2
1510-1	526127		SPRING, FRONT - STANDARD - C-K	4H.	2
1510-1	526125		SPRING, FRONT - HEAVY DUTY - W-F-Y	4H.	2
1510-1	526130		SPRING, FRONT - HEAVY DUTY - C-K	4H.	2
1510-7	526249		INSULATOR, FRONT SPRING - RUBBER	10G, 12G, 14G, H, 3H, 4H	4
1510-8	526830		SPACER, FRONT SPRING - STEEL - SERVICE ONLY.	H, 3H.	*

NOTES { * - USE AS REQUIRED.
 1 - USED ON MODEL 10G BEFORE CAR SERIAL 1,059,233
 2 - USED ON AND AFTER CAR SERIAL IN NOTE 1.

1518

FRAME AND SPRINGS

ILLUST. NUMBER	PART NUMBER	CHANGE	DESCRIPTION	MODELS	PER CAR
1518- REAR SPRINGS (Plate 15-2)					
					LEAVES
1518-1	530754		SPRING LESS BUSHING, REAR - STANDARD - W-Y-F-C-S-K.	10G, 12G, H, 3H.	2
1518-1	530753		SPRING LESS BUSHING, REAR - HEAVY DUTY.	10G, 12G, H, 3H.	2
1518-1	530752		SPRING LESS BUSHING, REAR - STANDARD Q.	10G	2
1518-1	530269		SPRING w/BUSHING, REAR - STANDARD - W-F	14G	2
1518-1	531073		SPRING w/BUSHING, REAR - STANDARD - C-K	14G	2
1518-1	533285		SPRING w/BUSHING, REAR - STANDARD - W-F-Y	4H.	2
1518-1	532116		SPRING w/BUSHING, REAR - STANDARD - C-K	4H.	2
1518-1	530268		SPRING w/BUSHING, REAR - HEAVY DUTY - W-F	14G	2
1518-1	533525		SPRING w/BUSHING, REAR - HEAVY DUTY - C-K	14G	2
1518-1	533525		SPRING w/BUSHING, REAR - HEAVY DUTY - W-F-Y	4H.	2
1518-1	533524		SPRING w/BUSHING, REAR - HEAVY DUTY - C-K	4H.	2
1518-2	202-0628		BOLT, CENTER 3/8"-24X1 3/4" (FOR 530754, 531073, 530269, 533285, 532116).	10G, 12G, 14G, H, 3H, 4H	2
1518-2	202-0624		BOLT, CENTER 3/8"-24X1 1/2" (FOR 530752)	10G	2
1518-2	202-0630		BOLT, CENTER 3/8"-24X1 7/8" (FOR 530758, 530268, 533525, 533524).	10G, 12G, 14G, H, 3H, 4H	2
	252-06		NUT, HEX. 3/8"-24	10G, 12G, 14G, H, 3H, 4H	2
1518-3	530992		LEAF, REAR SPRING MAIN (NO. 1) (EXCEPT 530752).	10G, 12G, 14G, H, 3H, 4H	2
1518-3	530991		LEAF, REAR SPRING MAIN (NO. 1) (FOR 530752)	10G	2
1518-4	527987		BUSHING, REAR SPRING.	10G, 12G, 14G, H, 3H, 4H	6
					LENGTH
	530431X3		INSERT, MAIN AND SECOND LEAF LINER OR	46 1/2"	1
	530431X4		INSERT, SECOND AND THIRD LEAF LINER OR (EXCEPT 530752)	35"	1
	530431X5		INSERT, SECOND AND THIRD LEAF LINER OR (FOR 530752)	25"	1
	530431X5		INSERT, THIRD AND FOURTH LEAF LINER OR.	25"	1
	530431X5		INSERT, FOURTH AND FIFTH LEAF LINER OR.	25"	1
1518-8	531001		CLIP, REAR SPRING REBOUND (FOR STANDARD SPRING)	10G, 12G, 14G, H, 3H, 4H	4
1518-8	531002		CLIP, REAR SPRING REBOUND (FOR HEAVY DUTY SPRING)	10G, 12G, 14G, H, 3H, 4H	4
	55-0436		BOLT, FASTENING 1/4"-20X2 1/4"	10G, 12G, 14G, H, 3H, 4H	4
	251-04		NUT, HEX. 1/4"-20	10G, 12G, 14G, H, 3H, 4H	4
1519- REAR SPRING BOLT (Plate 15-2)					
1519-1	2-0764		BOLT, FRONT, REAR SPRING 7/16"-20X4".	10G, 12G, 14G, H, 3H, 4H	6
1519-3	264-07		NUT, LOCK 7/16"-20	10G, 12G, 14G, H, 3H, 4H	6
	----		BUSHING, REAR SPRING BOLT - SEE SPRING BUSHING - GROUP 1518	10G, 12G, 14G, H, 3H, 4H	6
1520- REAR SPRING SHACKLE (Plate 15-2)					
	529169		SHACKLE, RIGHT, REAR SPRING - LHC	10G, 12G, 14G	2
1520-2	529168		SHACKLE, LEFT, REAR SPRING - LHC.	10G, 12G, 14G	2
	529168		SHACKLE, RIGHT, REAR SPRING - RHC	10G, 12G, 14G	2
	529169		SHACKLE, LEFT, REAR SPRING - RHC.	10G, 12G, 14G	2
1520-2	529168		SHACKLE, REAR SPRING - W-Y-F-C.	H	4
1520-2	529169		SHACKLE, REAR SPRING - W-Y-F-C-K.	3H, 4H	4
	529169		SHACKLE, RIGHT, REAR SPRING - S	H, 3H.	2
1520-2	529168		SHACKLE, LEFT, REAR SPRING - S.	H, 3H.	2
1520-4	2-0764		BOLT, SHACKLE 7/16"-20X4".	10G, 12G, 14G, H, 3H, 4H	4
1520-6	264-07		NUT, HEX. 7/16"-20.	10G, 12G, 14G, H, 3H, 4H	4
	----		BUSHING, REAR SPRING SHACKLE - SEE SPRING BUSHING - GROUP 1518.	10G, 12G, 14G, H, 3H, 4H	4
1521- REAR SPRING BUMPER (Plate 15-2)					
1521-1A	530333		BUMPER, REAR AXLE - RUBBER.	10G, 12G, 14G, 4H.	2
1521-1A	530333		BUMPER, REAR SPRING AND AXLE - RUBBER	H, 3H.	4
1521-1B	532406		BUMPER, REAR SPRING	4H.	2

FRAME AND SPRINGS

1525

ILLUST. NUMBER	PART NUMBER	CHANGE	DESCRIPTION	MODELS	PER CAR
1521- REAR SPRING BUMPER-Cont'd. (Plate 15-2)					
1521-3	530332		RETAINER, REAR AXLE BUMPER.	10G, 12G	2
1521-3	530332		RETAINER, REAR SPRING BUMPER.	H, 3H.	4
1521-3B	532118		RETAINER, REAR AXLE BUMPER.	14G, 4H.	2
1521-3B	532407		RETAINER, REAR SPRING BUMPER.	4H.	2
	650-058		SCREW, TO FRAME 5/16"X1/2"	10G, 12G, 14G, 4H.	4
	650-058		SCREW, TO FRAME 5/16"X1/2"	H, 3H.	8
	----		SCREW, TO FRAME 1/4"X20X3/8"	4H.	8
1522- REAR SPRING CLIP, PLATE AND SEAT (Plate 15-2)					
1522-1	527985		CLIP OR U BOLT, REAR SPRING	10G, 12G, 14G	4
1522-1	527986		CLIP OR U BOLT, REAR SPRING	H, 3H, 4H	4
1522-3	197402		NUT, HEX. 3/8"-24.	10G, 12G, 14G	8
1522-3	674899		NUT, HEX. 7/16"-20	H, 3H, 4H	8
1522-4	384-06		WASHER, LOCK 3/8"	10G, 12G, 14G	8
1522-4	384-07		WASHER, LOCK 7/16"	H, 3H, 4H	8
1522-5A	527848		PLATE, RIGHT, REAR SPRING CLIP.	10G, 12G	1
	527849		PLATE, LEFT, REAR SPRING CLIP	10G, 12G	1
1522-5A	531914		PLATE, RIGHT, REAR SPRING CLIP.	14G	1
	531915		PLATE, LEFT, REAR SPRING CLIP	14G	1
1522-5B	527982		PLATE, RIGHT, REAR SPRING CLIP.	H, 3H.	1
1522-6	527983		PLATE, LEFT, REAR SPRING CLIP (ILLUST. IN GROUP 1525)	H, 3H.	1
1522-5B	532076		PLATE, RIGHT, REAR SPRING CLIP.	4H.	1
1522-6	532077		PLATE, LEFT, REAR SPRING CLIP	4H.	1

1525- REAR STABILIZER

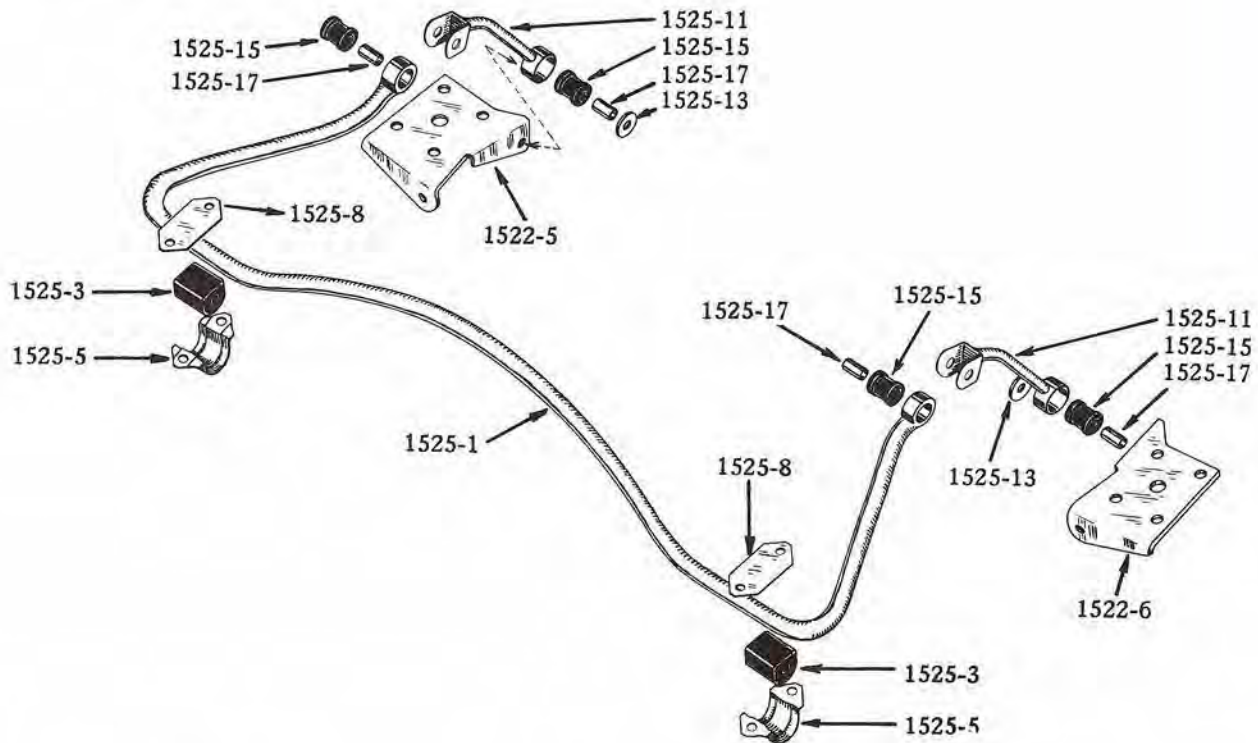

1525-1	525103		SHAFT, STABILIZER - Y.	H, 3H.	1
1525-1	532152		SHAFT, STABILIZER - Y.	4H.	1
1525-3	522518		BUSHING, STABILIZER SHAFT - Y.	H, 3H.	2

Standard parts are illustrated in back of book

PRINTED IN U.S.A.

1525

FRAME AND SPRINGS

ILLUST. NUMBER	PART NUMBER	CHANGE	DESCRIPTION	MODELS	PER CAR
1525- REAR STABILIZER-Cont'd.					
1525-5	525026		BRACKET, STABILIZER SHAFT BUSHING - Y	H, 3H	2
1525-8	525025		PLATE, BRACKET	H, 3H	2
	2-0624		BOLT, TO FRAME 3/8"-24X1 1/2"	H, 3H, 4H	4
	252-06		NUT, HEX. 3/8"-24	H, 3H	4
	380-06		WASHER, LOCK 3/8"	H, 3H	4
	****		WASHER, PLAIN 3/8"	H, 3H, 4H	4
1525-11	527984		LINK, STABILIZER SHAFT - Y	H, 3H	2
1525-11-1	532066		LINK, RIGHT, STABILIZER SHAFT - Y	4H	1
1525-11-2	532067		LINK, LEFT, STABILIZER SHAFT - Y	4H	1
	2-0730		BOLT, UPPER 7/16"-20X1 7/8"	H, 3H, 4H	2
	2-0734		BOLT, LOWER 7/16"-20X2 1/8"	H, 3H, 4H	2
	252-07		NUT, HEX. 7/16"-20	H, 3H, 4H	4
	380-07		WASHER, LOCK 7/16"	H, 3H, 4H	4
1525-13	199675		WASHER, LOWER BOLT 15/32"	H, 3H, 4H	2
1525-15	198685		BUSHING, STABILIZER SHAFT LINK - RUBBER - Y	H, 3H, 4H	4
1525-17	523301		SPACER, STABILIZER SHAFT BOLT - Y	H, 3H, 4H	4